

2000 KLR650 PARTS DIAGRAM

Balancer

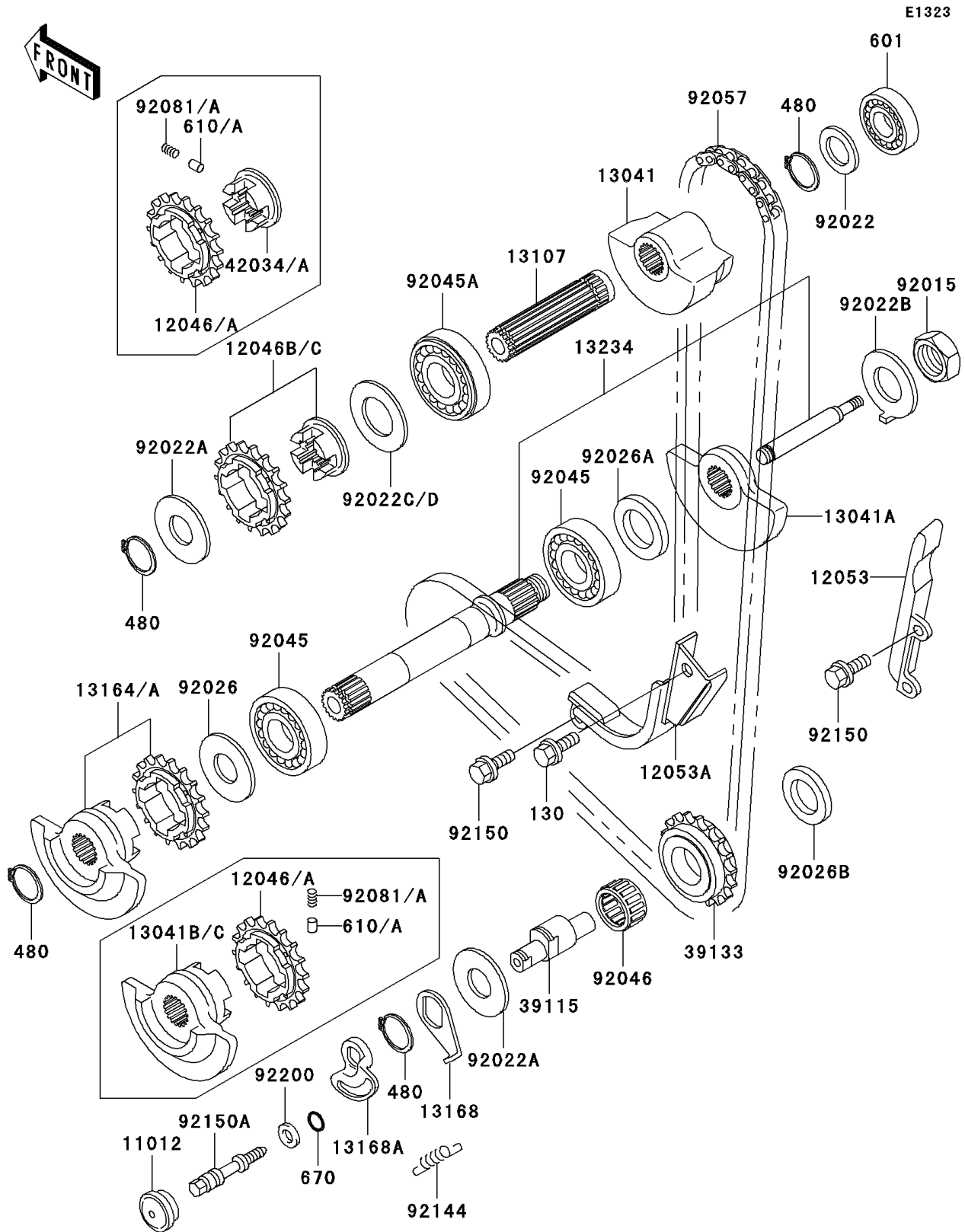

2000 KLR650 PARTS LIST

Balancer

ITEM NAME	PART NUMBER	QUANTITY
CAP (Ref # 11012)	11012-1369	1
SPROCKET,BALANCER,18T (Ref # 12046B)	12046-1165	1
GUIDE-CHAIN,RR (Ref # 12053)	12053-1111	1
GUIDE-CHAIN,FR (Ref # 12053A)	12053-1175	1
BALANCER,RR (Ref # 13041)	13041-1053	1
BALANCER,FR,RH (Ref # 13041A)	13041-1060	1
SHAFT,BALANCER,RR (Ref # 13107)	13107-1104	1
BALANCER-COMP,FR,LH (Ref # 13164)	13164-1007	1
LEVER (Ref # 13168)	13168-1238	1
LEVER,IDLER SHAFT (Ref # 13168A)	13168-1436	1
SHAFT-COMP,BALANCER,FR (Ref # 13234)	13234-1058	1
SHAFT-IDLER (Ref # 39115)	39115-1077	1
SPROCKET-IDLER,IDLER (Ref # 39133)	39133-1060	1
NUT,16MM (Ref # 92015)	92015-1477	1
WASHER,20.5X30X1,STEEL (Ref # 92022)	92022-112	1
WASHER,20.3X36X1.5 (Ref # 92022A)	92022-1489	2
WASHER (Ref # 92022B)	92022-1651	1
WASHER,20.2X36X2 (Ref # 92022C)	92022-1880	1
SPACER,20.2X36X3 (Ref # 92026)	92026-1208	1
SPACER,20.2X30X5 (Ref # 92026A)	92026-1245	1
SPACER (Ref # 92026B)	92026-1462	1
BEARING-BALL,#6204 (Ref # 92045)	92045-1032	2
BEARING-BALL,SX0415 (Ref # 92045A)	92045-1188	1
BEARING-NEEDLE (Ref # 92046)	92046-1234	1
CHAIN,BALANCER,BF06HX70L (Ref # 92057)	92057-1158	1
BOLT-FLANGED,8X20 (Ref # 130)	130G0820	1
CIRCLIP-TYPE-C,20MM (Ref # 480)	480J2000	4
BEARING-BALL,#6004 (Ref # 601)	601A6004	1
O RING,7MM (Ref # 670)	670B1507	1

2000 KLR650 PARTS LIST

Balancer

ITEM NAME	PART NUMBER	QUANTITY
SPRING,IDLER SHAFT (Ref # 92144)	92144-1860	1
BOLT,6X16 (Ref # 92150)	92150-1394	3
BOLT,IDLER LEVER (Ref # 92150A)	92150-1923	1
WASHER,6.5X12X2.0 (Ref # 92200)	92200-1263	1