

2000 KLR650 PARTS DIAGRAM

Transmission(KL650AE032210-)

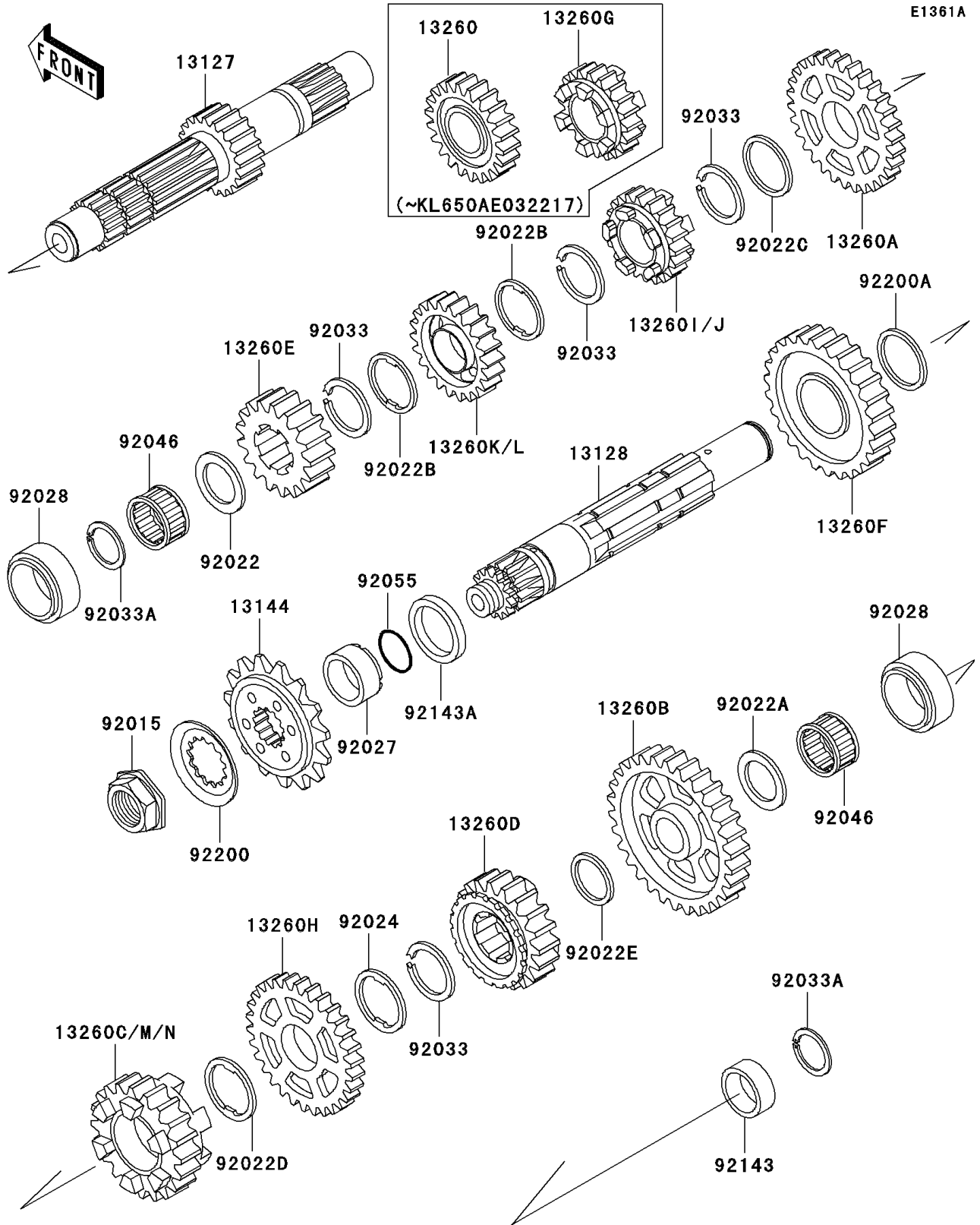

2000 KLR650 PARTS LIST

Transmission(KL650AE032210-)

ITEM NAME	PART NUMBER	QUANTITY
SHAFT-TRANSMISSION INPUT,15T (Ref # 13127)	13127-1147	1
SHAFT-TRANSMISSION OUTPUT (Ref # 13128)	13128-1203	1
SPROCKET-OUTPUT (Ref # 13144)	13144-1253	1
GEAR,INPUT TOP,24T (Ref # 13260A)	13260-1326	1
GEAR,OUTPUT LOW,34T (Ref # 13260B)	13260-1327	1
GEAR,OUTPUT TOP,19T (Ref # 13260D)	13260-1331	1
GEAR,INPUT 2ND,18T (Ref # 13260E)	13260-1464	1
GEAR,OUTPUT 2ND,26T (Ref # 13260F)	13260-1465	1
GEAR,OUTPUT 3RD,25T (Ref # 13260H)	13260-1467	1
GEAR,INPUT 3RD,22T (Ref # 13260I)	13260-1518	1
GEAR,INPUT 4TH,22T (Ref # 13260K)	13260-1519	1
GEAR,OUTPUT 4TH,21T (Ref # 13260M)	13260-1520	1
NUT,20MM (Ref # 92015)	92015-1963	1
WASHER,20.5X30X1,STEEL (Ref # 92022)	92022-112	1
WASHER,20.3X29X0.5 (Ref # 92022A)	92022-1479	1
WASHER,TOOTHED,25.3X29.5X0.5 (Ref # 92022B)	92022-1482	2
WASHER,25.3X30X0.5 (Ref # 92022C)	92022-159	1
WASHER,25.3X32X0.5 (Ref # 92022D)	92022-225	1
WASHER,20.5X25.5X0.5 (Ref # 92022E)	92022-252	1
WASHER,TOOTHED,22.5X31X0.5 (Ref # 92024)	92024-038	1
COLLAR,25X32X15.3 (Ref # 92027)	92027-1800	1
BUSHING,26X35X14 (Ref # 92028)	92028-131	2
RING-SNAP,24MM (Ref # 92033)	92033-026	4
RING-SNAP,18MM (Ref # 92033A)	92033-029	2
BEARING-NEEDLE,KT202614 (Ref # 92046)	92046-1170	2
RING-O,21.5MM (Ref # 92055)	92055-1293	1
COLLAR,20X25X9.5 (Ref # 92143)	92143-1624	1
COLLAR,25X32X3.0 (Ref # 92143A)	92143-1721	1
WASHER (Ref # 92200)	92200-1065	1

2000 KLR650 PARTS LIST

Transmission(KL650AE032210-)

ITEM NAME	PART NUMBER	QUANTITY
WASHER,2ND GEAR (Ref # 92200A)	92200-1170	1