

# 2009 Concours™ 14 PARTS DIAGRAM

Engine Cover(s)

E1431

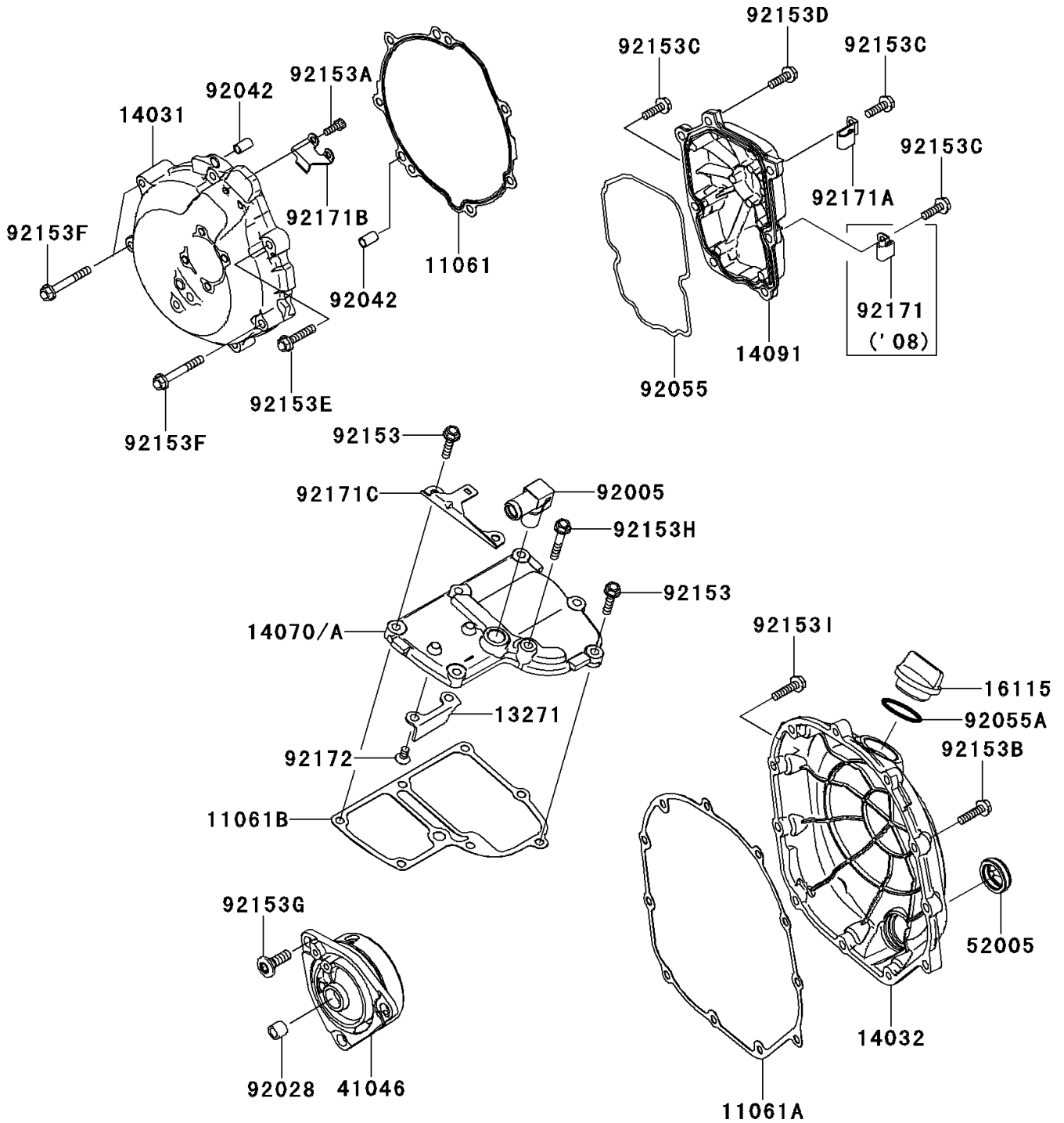

## 2009 Concours™ 14 PARTS LIST

### Engine Cover(s)

ITEM NAME	PART NUMBER	QUANTITY
GASKET,GENERATOR COVER (Ref # 11061)	11061-0197	1
GASKET,CLUTCH COVER (Ref # 11061A)	11061-0198	1
GASKET,BREATHER BODY (Ref # 11061B)	11061-0200	1
PLATE (Ref # 13271)	13271-0768	1
COVER-GENERATOR (Ref # 14031)	14031-0083	1
COVER-CLUTCH (Ref # 14032)	14032-0110	1
BODY-BREATHER (Ref # 14070A)	14070-0004	1
COVER,PULSER (Ref # 14091)	14091-0896	1
CAP-OIL FILLER (Ref # 16115)	16115-1009	1
HOUSING-BEARING (Ref # 41046)	41046-0020	1
GAUGE (Ref # 52005)	52005-0024	1
FITTING (Ref # 92005)	92005-0044	1
BUSHING,8X12X10 (Ref # 92028)	92028-1750	1
PIN,DOWEL,6.3X8X14 (Ref # 92042)	92042-007	2
RING-O,PULSER COVER (Ref # 92055)	92055-0086	1
RING-O,31.7X2.4 (Ref # 92055A)	92055-049	1
BOLT,6X25 (Ref # 92153)	92153-1071	6
BOLT,SOCKET,5X14 (Ref # 92153A)	92153-1286	2
BOLT-FLANGED,6X25 (Ref # 92153B)	92153-1569	10
BOLT-FLANGED,6X20 (Ref # 92153C)	92153-1572	6
BOLT-FLANGED,6X20 (Ref # 92153D)	92153-1573	1
BOLT-FLANGED,6X30 (Ref # 92153E)	92153-1574	4
BOLT-FLANGED,6X45 (Ref # 92153F)	92153-1575	3
BOLT,SOCKET,8X25 (Ref # 92153G)	92153-1578	3
BOLT-FLANGED,6X35 (Ref # 92153H)	92153-1579	1
BOLT,FLANGED,6X25 (Ref # 92153I)	92153-1719	1
CLAMP (Ref # 92171A)	92171-0761	1
CLAMP (Ref # 92171B)	92171-0768	1
CLAMP (Ref # 92171C)	92171-0769	1

## 2009 Concours™ 14 PARTS LIST

Engine Cover(s)

ITEM NAME	PART NUMBER	QUANTITY
SCREW-CSK-CROS,6X12 (Ref # 92172)	92172-0263	2