

1989 KD80 PARTS DIAGRAM

Carburetor

E1611-0251

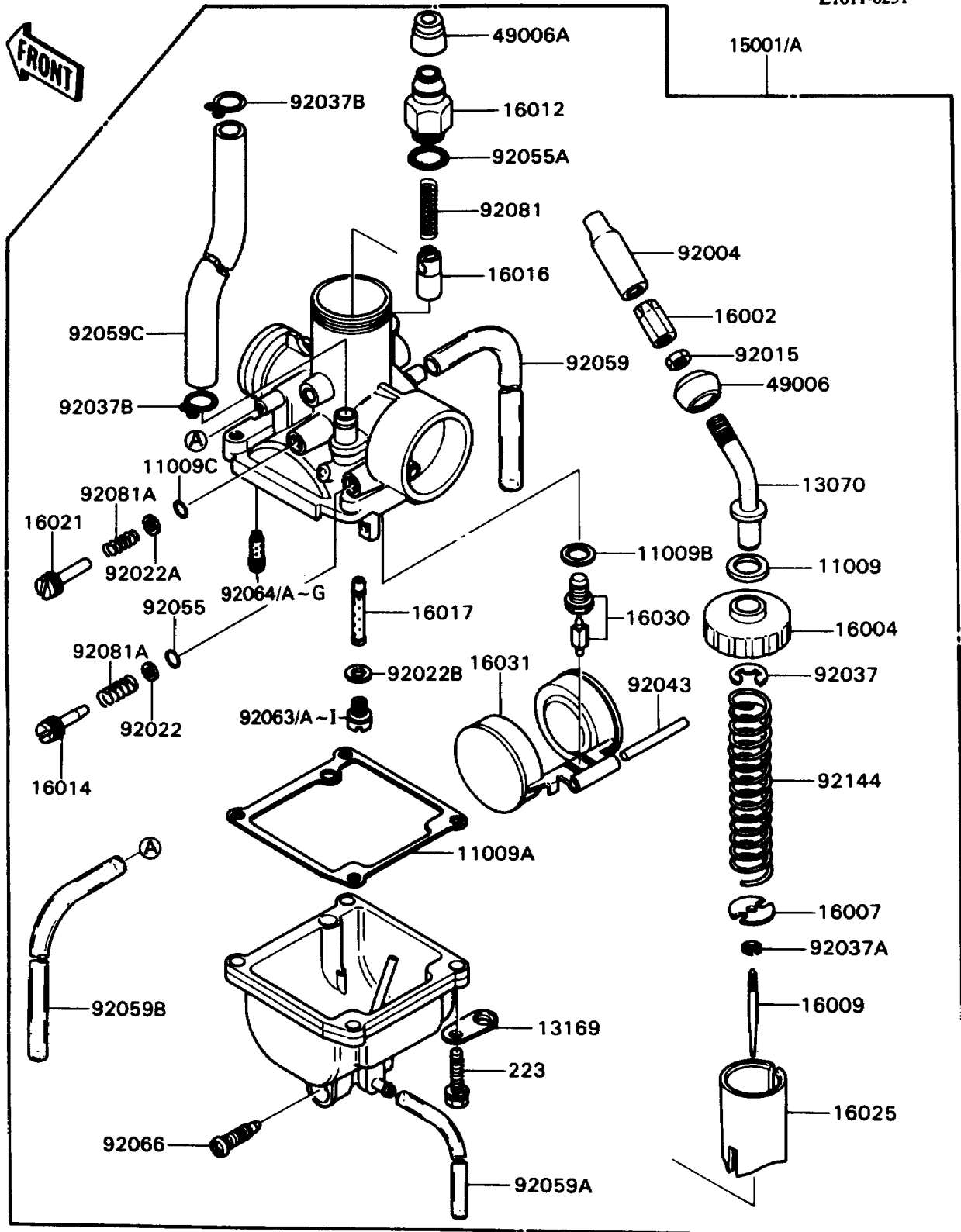

1989 KD80 PARTS LIST

Carburetor

| ITEM NAME | PART NUMBER | QUANTITY |
|---|-------------|----------|
| GASKET,CABLE GUIDE (Ref # 11009) | 11009-1074 | 1 |
| GASKET,FLOAT CHAMBER (Ref # 11009A) | 11009-1250 | 1 |
| GASKET,FLOAT VALVE SEAT (Ref # 11009B) | 16029-002 | 1 |
| GASKET,"O"RING (Ref # 11009C) | 16038-022 | 1 |
| GUIDE,THROTTLE CABLE (Ref # 13070) | 13070-1068 | 1 |
| PLATE,TUBE CLAMP (Ref # 13169) | 13169-1226 | 2 |
| CARBURETOR-ASSY (Ref # 15001) | 15001-1411 | 1 |
| CARBURETOR-ASSY (Ref # 15001A) | 15001-1456 | 1 |
| ADJUSTER-CABLE (Ref # 16002) | 16002-1011 | 1 |
| CAP-CHAMBER,MIXING (Ref # 16004) | 16004-1062 | 1 |
| SEAT-SPRING (Ref # 16007) | 16007-1044 | 1 |
| NEEDLE-JET,3G23-4 (Ref # 16009) | 16009-1466 | 1 |
| CAP-STARTER PLUNGER (Ref # 16012) | 16012-1058 | 1 |
| SCREW-PILOT AIR (Ref # 16014) | 16014-1060 | 1 |
| PLUNGER,STARTER (Ref # 16016) | 16016-002 | 1 |
| JET-NEEDLE,D-8 (Ref # 16017) | 16017-1347 | 1 |
| SCREW-THROTTLE STOP (Ref # 16021) | 16021-1113 | 1 |
| VALVE-THROTTLE,CA3.0 (Ref # 16025) | 16025-1152 | 1 |
| VALVE-FLOAT,#1.5 (Ref # 16030) | 16030-1065 | 1 |
| FLOAT (Ref # 16031) | 16031-1068 | 1 |
| BOOT,MIXING CHAMBER CAP (Ref # 49006) | 49006-1083 | 1 |
| BOOT,STARTER PLUNGER (Ref # 49006A) | 49006-1203 | 1 |
| STUD,CABLE ADJUSTER (Ref # 92004) | 92006-1084 | 1 |
| NUT,CABLE ADJUST LOCK (Ref # 92015) | 16003-004 | 1 |
| WASHER,ADJUST SCREW (Ref # 92022) | 92022-1187 | 1 |
| WASHER,THROTTLE STOP SCREW (Ref # 92022A) | 92022-1698 | 1 |
| WASHER (Ref # 92022B) | 92022-1938 | 1 |
| CLAMP,CABLE GUIDE (Ref # 92037) | 16008-011 | 1 |
| CLAMP (Ref # 92037A) | 92037-1272 | 1 |

1989 KD80 PARTS LIST

Carburetor

| ITEM NAME | PART NUMBER | QUANTITY |
|--------------------------------------|-------------|----------|
| CLAMP,TUBE (Ref # 92037B) | 92037-1573 | 2 |
| PIN,FLOAT (Ref # 92043) | 16032-003 | 1 |
| RING-O,ADJUST SCREW (Ref # 92055) | 92055-1078 | 1 |
| RING-O,PLUNGER (Ref # 92055A) | 92055-1417 | 1 |
| TUBE,3X5X320 (Ref # 92059) | 92059-1430 | 1 |
| TUBE,3X5X250 (Ref # 92059A) | 92059-1432 | 1 |
| TUBE,3X5X350 (Ref # 92059B) | 92059-1933 | 1 |
| TUBE,5.3X10.5X95 (Ref # 92059C) | 92059-1943 | 1 |
| JET-MAIN,#85R (Ref # 92063) | 92063-093 | 1 |
| JET-MAIN,#87.5R (Ref # 92063A) | 92063-094 | 1 |
| JET-MAIN,#A90R (Ref # 92063B) | 92063-1029 | 1 |
| JET-MAIN,#A95R (Ref # 92063C) | 92063-1031 | 1 |
| JET-MAIN,#A92.5R (Ref # 92063D) | 92063-1085 | 1 |
| JET-MAIN,#75R (Ref # 92063E) | 92063-109 | 1 |
| JET-MAIN,#77.5R (Ref # 92063F) | 92063-122 | 1 |
| JET-MAIN,#80R (Ref # 92063G) | 92063-123 | 1 |
| JET-MAIN,#82.5R (Ref # 92063H) | 92063-124 | 1 |
| JET-MAIN,#A85R (Ref # 92063I) | 92063-1323 | 1 |
| JET-PILOT,#17.5 (Ref # 92064) | 92064-020 | 1 |
| JET-PILOT,#20 (Ref # 92064A) | 92064-021 | 1 |
| JET-PILOT,#20 (Ref # 92064B) | 92064-021 | 1 |
| JET-PILOT,#25 (Ref # 92064C) | 92064-032 | 1 |
| JET-PILOT,#22.5 (Ref # 92064D) | 92064-040 | 1 |
| JET-PILOT,#22.5 (Ref # 92064E) | 92064-040 | 1 |
| JET-PILOT,#15 (Ref # 92064F) | 92064-047 | 1 |
| PLUG,DRAIN (Ref # 92066) | 92066-1187 | 1 |
| SPRING,STARTER PLUNGER (Ref # 92081) | 16013-005 | 1 |
| SPRING,STOP SCREW (Ref # 92081A) | 92081-1153 | 2 |
| SPRING,THROTTLE VALVE (Ref # 92144) | 92144-1271 | 1 |