

# 1988 KDX200 PARTS DIAGRAM

Headlight(s)

F2710-0168

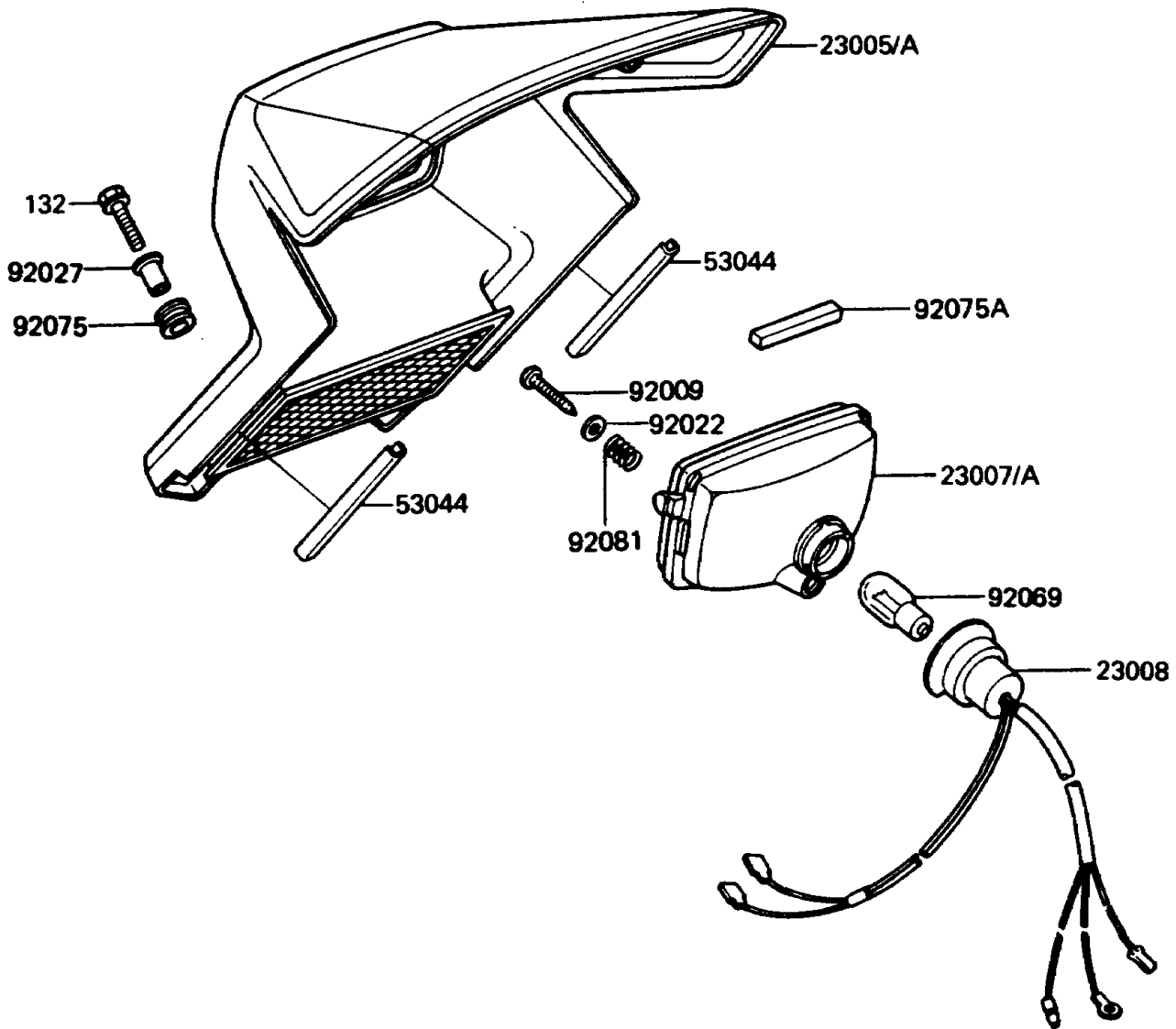

# 1988 KDX200 PARTS LIST

## Headlight(s)

| ITEM NAME                                     | PART NUMBER   | QUANTITY |
|---|---------------|----------|
| BODY-COMP-HEAD LAMP,L.GREEN (Ref # 23005)     | 23005-1057-AC | 1        |
| BODY-COMP-HEAD LAMP,WHITE/BLUE (Ref # 23005A) | 23005-1057-AJ | 1        |
| LENS-COMP,HEAD LAMP (Ref # 23007A)            | 23007-1180    | 1        |
| SOCKET-ASSY,HEAD LAMP (Ref # 23008)           | 23008-1249    | 1        |
| TRIM (Ref # 53044)                            | 53044-1137    | 2        |
| SCREW,TAPPING,4X30 (Ref # 92009)              | 92009-1139    | 1        |
| WASHER,FOCUS ADJUSTING (Ref # 92022)          | 23021-008     | 1        |
| COLLAR,L=9.6 (Ref # 92027)                    | 92027-1045    | 2        |
| BULB,6V 25/25W (Ref # 92069)                  | 92069-031     | 1        |
| DAMPER (Ref # 92075)                          | 92075-1028    | 2        |
| SPRING,FOUCUS ADJUSTING (Ref # 92081)         | 92081-1519    | 1        |
| BOLT-FLANGED-SMALL (Ref # 132)                | 132G0620      | 2        |