

# 1990 KDX200 PARTS DIAGRAM

Clutch

E1350

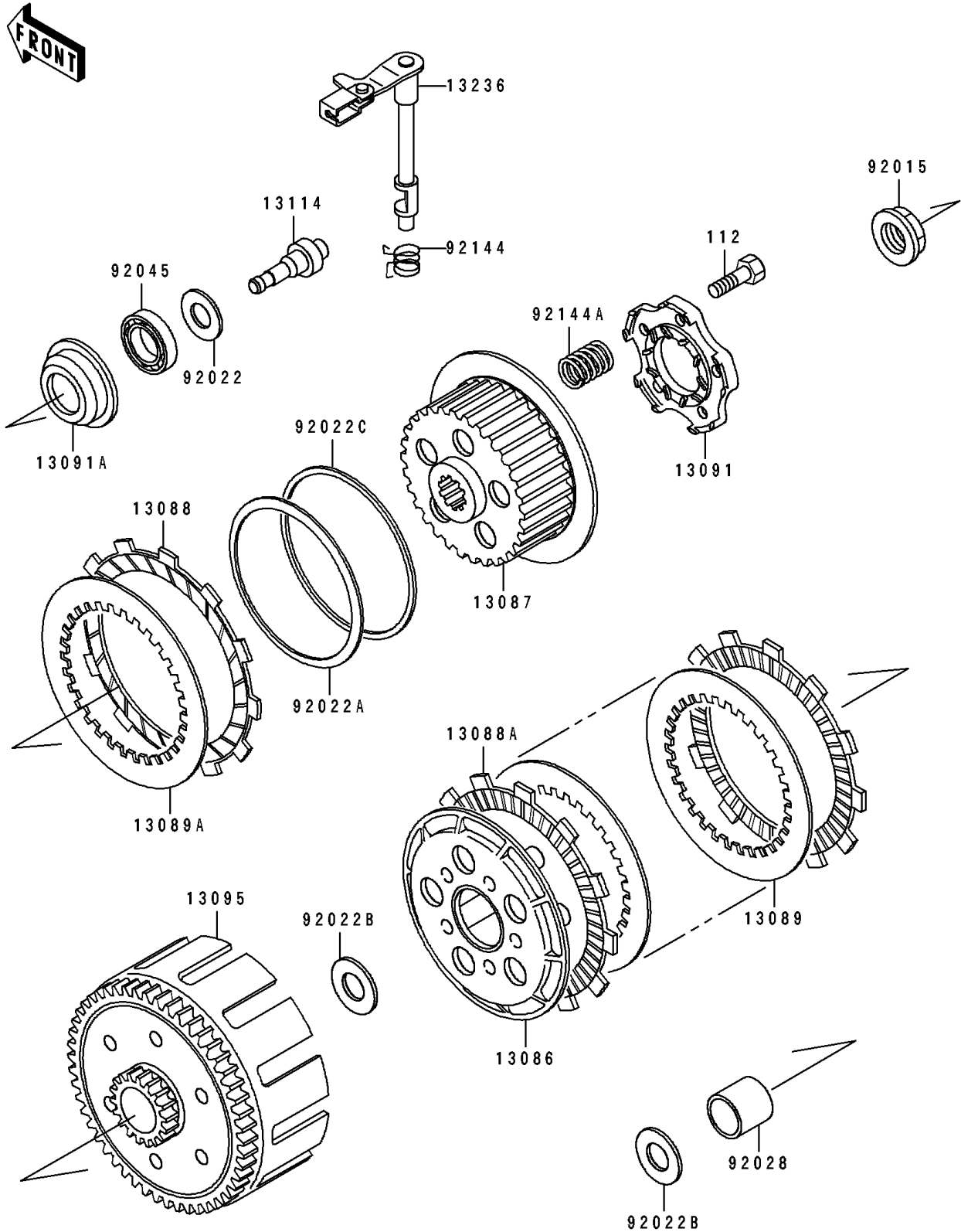

# 1990 KDX200 PARTS LIST

## Clutch

| ITEM NAME                                | PART NUMBER | QUANTITY |
|--|-------------|----------|
| WHEEL-CLUTCH (Ref # 13086)               | 13086-1060  | 1        |
| HUB-CLUTCH (Ref # 13087)                 | 13087-1111  | 1        |
| PLATE-FRICTION (Ref # 13088)             | 13088-1058  | 1        |
| PLATE-FRICTION,ID=95 (Ref # 13088A)      | 13088-1081  | 7        |
| PLATE-CLUTCH (Ref # 13089)               | 13089-1070  | 6        |
| PLATE-CLUTCH (Ref # 13089A)              | 13089-1085  | 1        |
| HOLDER,CLUTCH SPRING (Ref # 13091)       | 13091-1502  | 1        |
| HOLDER,CLUTCH PUSHER (Ref # 13091A)      | 13091-1712  | 1        |
| HOUSING-COMP-CLUTCH (Ref # 13095)        | 13095-1189  | 1        |
| PUSHER-CLUTCH (Ref # 13114)              | 13114-1063  | 1        |
| LEVER-COMP (Ref # 13236)                 | 13236-1195  | 1        |
| NUT (Ref # 92015)                        | 92015-1581  | 1        |
| WASHER,10.2X14.5X1.0 (Ref # 92022)       | 92022-1181  | 1        |
| WASHER,JUDDER SPRING (Ref # 92022A)      | 92022-1974  | 1        |
| WASHER,20.3X30X2.3 (Ref # 92022B)        | 92022-1979  | 2        |
| WASHER,JUDDER SPRING SEAT (Ref # 92022C) | 92022-1993  | 1        |
| BUSHING,20X25X26.85 (Ref # 92028)        | 92028-1388  | 1        |
| BEARING-BALL,6000M3ML01 (Ref # 92045)    | 92045-1225  | 1        |
| SPRING,CLUTCH RELEASE (Ref # 92144)      | 92144-1287  | 1        |
| SPRING,CLUTCH (Ref # 92144A)             | 92144-1403  | 5        |
| BOLT-UPSET (Ref # 112)                   | 112G0622    | 5        |