

1991 KDX200 PARTS DIAGRAM

Front Fork

F2340

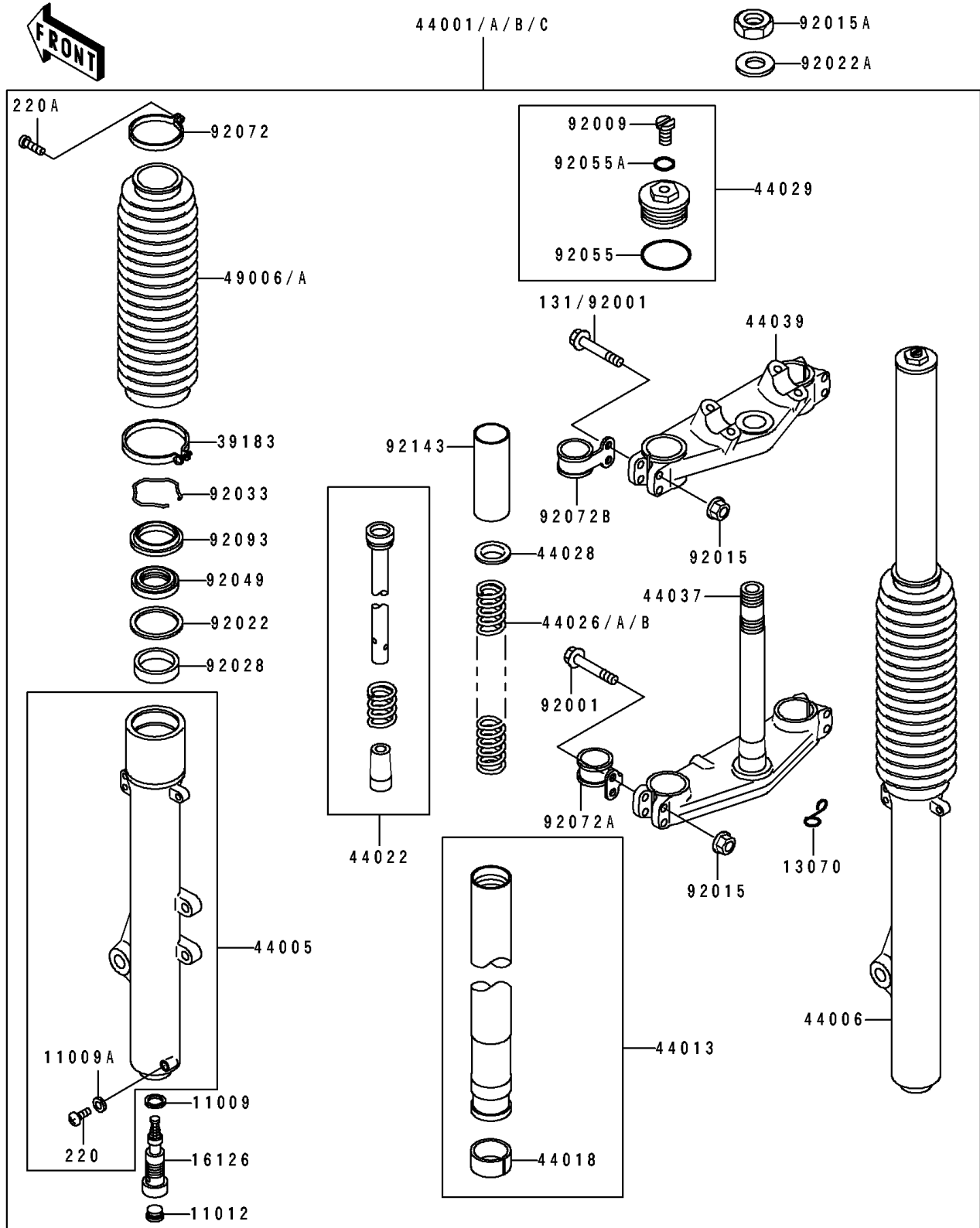

1991 KDX200 PARTS LIST

Front Fork

| ITEM NAME | PART NUMBER | QUANTITY |
|---|---------------|----------|
| GASKET,FORK CYLINDER BOLT (Ref # 11009) | 11009-1324 | 2 |
| GASKET,FORK DRAIN PLUG (Ref # 11009A) | 44045-002 | 2 |
| CAP,FORK CYLINDER (Ref # 11012) | 11012-1381 | 2 |
| GUIDE,CABLE (Ref # 13070) | 13070-1208 | 1 |
| VALVE,FORK CYLINDER (Ref # 16126) | 16126-1134 | 2 |
| BAND-ASSY,BOOT (Ref # 39183) | 39183-1051 | 2 |
| FORK-FRONT,BLUE NO.32 (Ref # 44001A) | 44001-1711-GF | 1 |
| PIPE-LEFT FORK OUTER (Ref # 44005) | 44005-1286 | 1 |
| PIPE-RIGHT FORK OUTER (Ref # 44006) | 44006-1300 | 1 |
| PIPE-FORK INNER (Ref # 44013) | 44013-1300 | 2 |
| PISTON-FORK,INNER PIPE (Ref # 44018) | 44018-1056 | 2 |
| CYLINDER-FORK (Ref # 44022) | 44022-1240 | 2 |
| SPRING-FRONT FORK,K=0.30 (Ref # 44026) | 44026-1401 | 2 |
| SPRING-FRONT FORK,K=0.29 (Ref # 44026A) | 44026-1430 | 2 |
| SPRING-FRONT FORK,K=0.31 (Ref # 44026B) | 44026-1431 | 2 |
| GUIDE-FORK SPRING (Ref # 44028) | 44028-1010 | 2 |
| SEAT-FORK SPRING (Ref # 44029) | 44029-1137 | 2 |
| HOLDER-FORK UNDER (Ref # 44037) | 44037-1248 | 1 |
| HOLDER-FORK UPPER (Ref # 44039) | 44039-1154 | 1 |
| BOOT,FORK,BLUE NO.32 (Ref # 49006A) | 49006-1184-GF | 2 |
| BOLT,FLANGED,8X55 (Ref # 92001) | 92001-1639 | 4 |
| SCREW (Ref # 92009) | 92009-1568 | 2 |
| NUT,FLANGED,8MM (Ref # 92015) | 92015-1485 | 8 |
| NUT,STEERING STEM,22MM (Ref # 92015A) | 92015-1653 | 1 |
| WASHER (Ref # 92022) | 92022-1299 | 2 |
| WASHER,STEERING STEM (Ref # 92022A) | 92022-1873 | 1 |
| BUSHING (Ref # 92028) | 92028-1581 | 2 |
| RING-SNAP (Ref # 92033) | 92033-1077 | 2 |
| SEAL-OIL,FORK OUTER TUBE (Ref # 92049) | 92049-1295 | 2 |

1991 KDX200 PARTS LIST

Front Fork

| ITEM NAME | PART NUMBER | QUANTITY |
|---------------------------------|-------------|----------|
| RING-O (Ref # 92055) | 92055-1123 | 2 |
| RING-O (Ref # 92055A) | 92055-1441 | 2 |
| BAND,BOOT (Ref # 92072) | 92072-1078 | 2 |
| BAND,CABLE (Ref # 92072A) | 92072-1205 | 1 |
| BAND (Ref # 92072B) | 92072-1246 | 1 |
| SEAL,FORK DUST (Ref # 92093) | 92093-1086 | 2 |
| COLLAR,FORK,L=110 (Ref # 92143) | 92143-1328 | 2 |
| BOLT-FLANGED (Ref # 131) | 131G0850 | 4 |
| SCREW-PAN-CROS (Ref # 220) | 220B0408 | 2 |
| SCREW-PAN-CROS (Ref # 220A) | 220B0416 | 2 |