

1996 KDX200 PARTS DIAGRAM

Rear Suspension

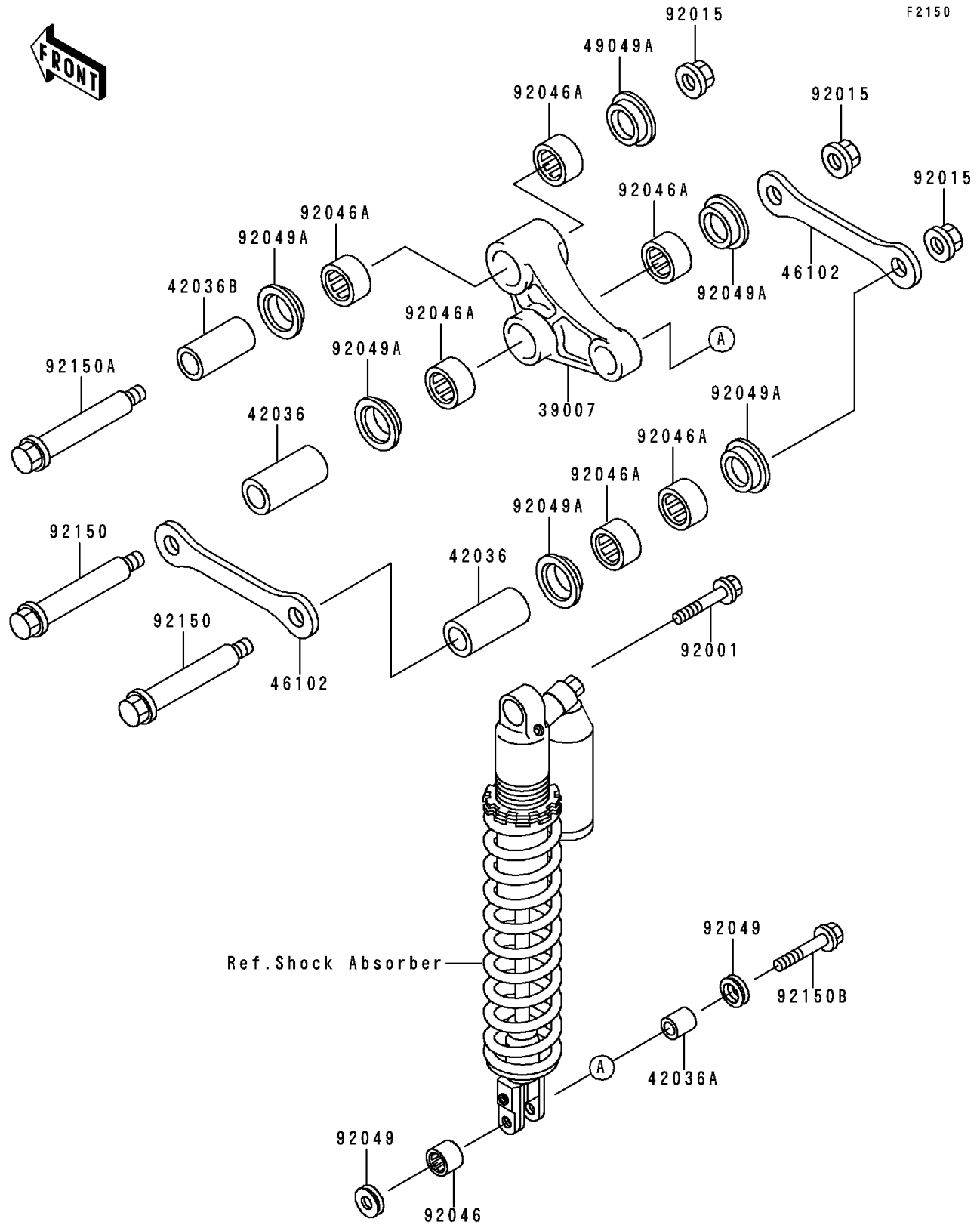

1996 KDX200 PARTS LIST

Rear Suspension

ITEM NAME	PART NUMBER	QUANTITY
ARM-SUSP,UNI TRAK (Ref # 39007)	39007-1229	1
SLEEVE,15X22X57 (Ref # 42036)	42036-1245	2
SLEEVE,10X16X19 (Ref # 42036A)	42036-1248	1
SLEEVE,15X22X45 (Ref # 42036B)	42036-1309	1
ROD,SUSPENSION (Ref # 46102)	46102-1358	2
BOLT,10X44 (Ref # 92001)	92001-1499	1
NUT,FLANGED,12MM (Ref # 92015)	92015-1433	3
BEARING-NEEDLE,16BM2212 (Ref # 92046)	92046-1192	1
BEARING-NEEDLE,22BM2816 (Ref # 92046A)	92046-1216	6
SEAL-OIL (Ref # 92049)	92049-1330	2
SEAL-OIL,MHA22 28 5.7F-1 (Ref # 92049A)	92049-1402	6
BOLT,ROD,12X85 (Ref # 92150)	92150-1213	2
BOLT,FLANGED,12X76 (Ref # 92150A)	92150-1701	1
BOLT,FLANGED,10X40 (Ref # 92150B)	92150-1711	1