

1998 KDX220R PARTS DIAGRAM

Front Fork(KDX220-A5-A8)

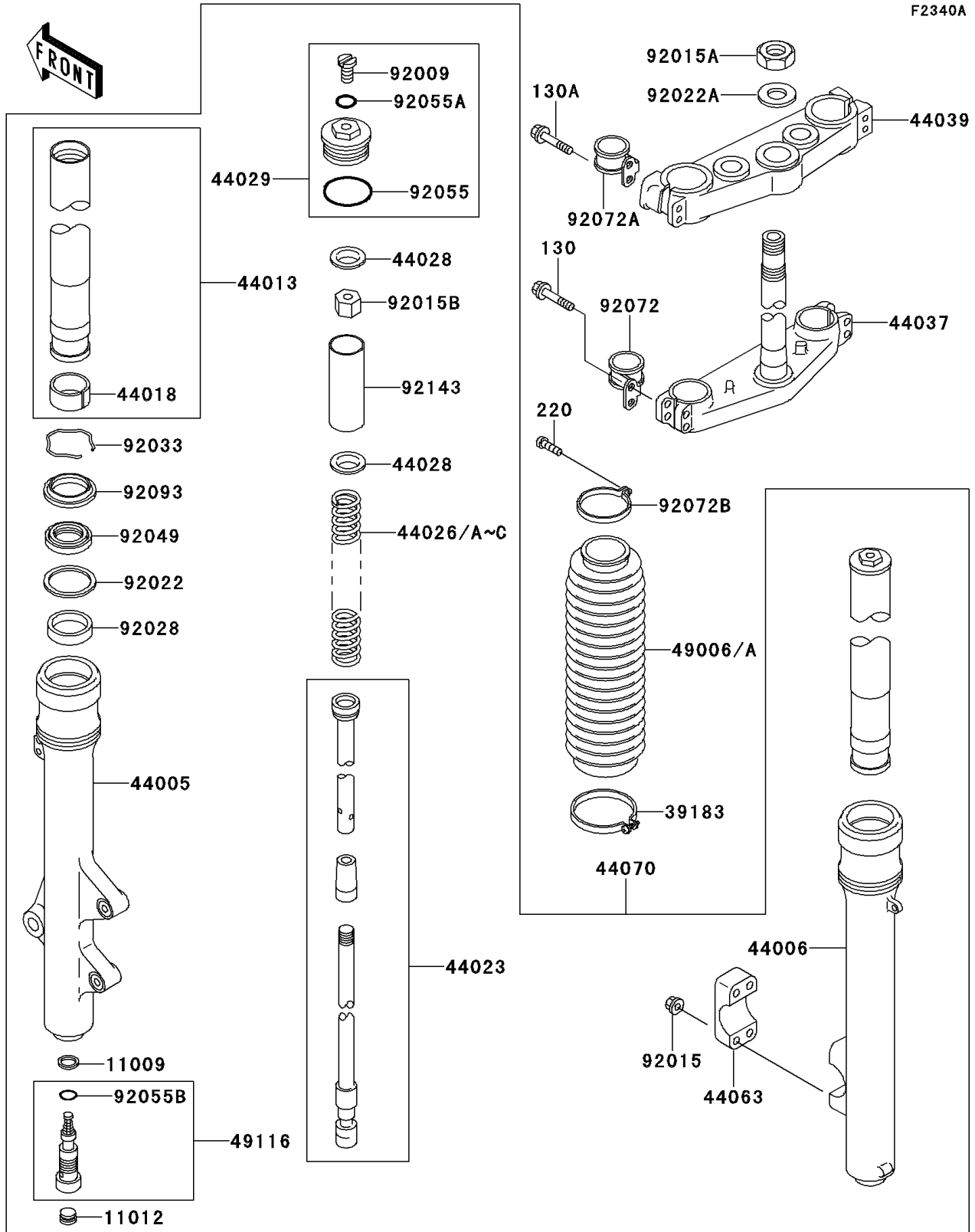

1998 KDX220R PARTS LIST

Front Fork(KDX220-A5-A8)

| ITEM NAME | PART NUMBER | QUANTITY |
|---|---------------|----------|
| GASKET,FORK CYLINDER BOLT (Ref # 11009) | 11009-1592 | 2 |
| CAP,FORK CYLINDER (Ref # 11012) | 11012-1381 | 2 |
| BAND-ASSY,BOOT (Ref # 39183) | 39183-1060 | 2 |
| PIPE-LEFT FORK OUTER (Ref # 44005) | 44005-1345 | 1 |
| PIPE-RIGHT FORK OUTER (Ref # 44006) | 44006-1343 | 1 |
| PIPE-FORK INNER (Ref # 44013) | 44013-1403 | 2 |
| PISTON-FORK,INNER PIPE (Ref # 44018) | 44018-1056 | 2 |
| CYLINDER-COMP-FORK (Ref # 44023) | 44023-1109 | 2 |
| SPRING-FRONT FORK,K=0.34 (Ref # 44026) | 44026-1574 | 2 |
| SPRING-FRONT FORK,K=0.36 (Ref # 44026A) | 44026-1575 | 2 |
| SPRING-FRONT FORK,K=0.37 (Ref # 44026B) | 44026-1576 | 2 |
| SPRING-FRONT FORK,K=0.35 (Ref # 44026C) | 44026-1638 | 2 |
| GUIDE-FORK SPRING (Ref # 44028) | 44028-1010 | 4 |
| SEAT-FORK SPRING (Ref # 44029) | 44029-1152 | 2 |
| HOLDER-FORK UNDER (Ref # 44037) | 44037-1369 | 1 |
| HOLDER-FORK UPPER (Ref # 44039) | 44039-1256 | 1 |
| HOLDER-FRONT AXLE (Ref # 44063) | 44063-1056 | 1 |
| DAMPER-ASSY,FORK SET (Ref # 44070) | 44070-1576 | 1 |
| BOOT,FORK,J.S.VIOLET (Ref # 49006A) | 49006-1296-VW | 2 |
| VALVE-ASSY,FORK (Ref # 49116) | 49116-1132 | 2 |
| SCREW (Ref # 92009) | 92009-1568 | 2 |
| NUT,FLANGED,6MM (Ref # 92015) | 92015-1078 | 4 |
| NUT,STEERING STEM,22MM (Ref # 92015A) | 92015-1653 | 1 |
| NUT (Ref # 92015B) | 92015-1839 | 2 |
| WASHER (Ref # 92022) | 92022-1299 | 2 |
| WASHER,STEERING STEM (Ref # 92022A) | 92022-1873 | 1 |
| BUSHING (Ref # 92028) | 92028-1581 | 2 |
| RING-SNAP (Ref # 92033) | 92033-1077 | 2 |
| SEAL-OIL,FORK OUTER TUBE (Ref # 92049) | 92049-1316 | 2 |

1998 KDX220R PARTS LIST

Front Fork(KDX220-A5-A8)

| ITEM NAME | PART NUMBER | QUANTITY |
|----------------------------------|-------------|----------|
| RING-O (Ref # 92055) | 92055-1123 | 2 |
| RING-O (Ref # 92055A) | 92055-1441 | 2 |
| RING-O,FORK VALVE (Ref # 92055B) | 92055-1502 | 2 |
| BAND,CABLE (Ref # 92072) | 92072-1166 | 1 |
| BAND (Ref # 92072A) | 92072-1268 | 1 |
| BAND,BOOT (Ref # 92072B) | 92072-1316 | 2 |
| SEAL,FORK DUST (Ref # 92093) | 92093-1260 | 2 |
| BOLT-FLANGED,8X45 (Ref # 130) | 130G0845 | 4 |
| BOLT-FLANGED,8X50 (Ref # 130A) | 130G0850 | 4 |
| SCREW-PAN-CROS (Ref # 220) | 220B0416 | 2 |
| COLLAR,FORK,L=90 (Ref # 92143) | 92143-1645 | 2 |