

1991 KDX250 PARTS DIAGRAM

Crankcase

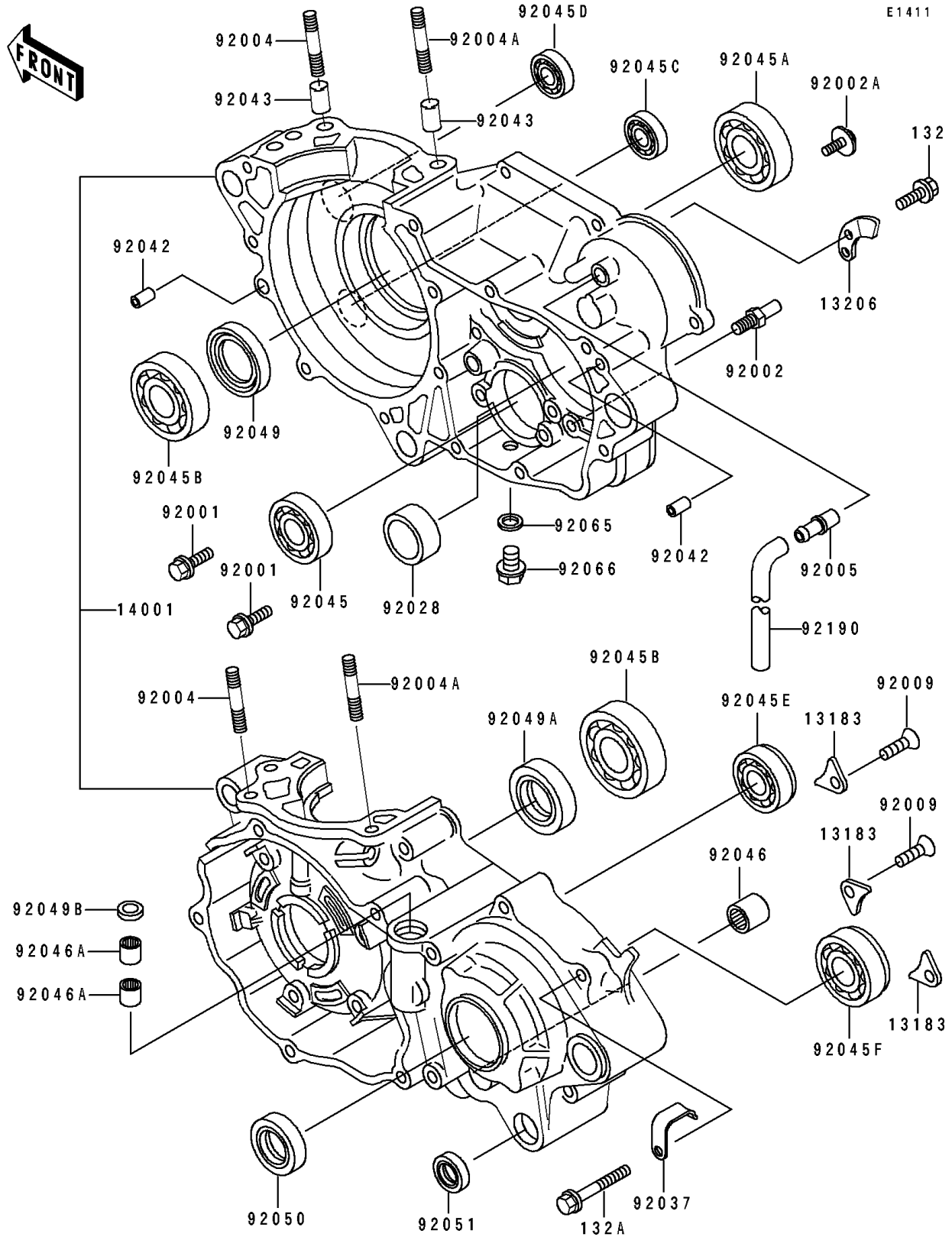

1991 KDX250 PARTS LIST

Crankcase

| ITEM NAME | PART NUMBER | QUANTITY |
|---|-------------|----------|
| PLATE (Ref # 13183) | 13183-1182 | 3 |
| GUIDE-KICK (Ref # 13206) | 13206-1062 | 1 |
| SET-CRANKCASE (Ref # 14001) | 14001-5294 | 1 |
| BOLT,W/WASHER,6X14 (Ref # 92001) | 92001-1829 | 2 |
| BOLT,8X15 (Ref # 92002) | 92002-1601 | 1 |
| BOLT,6X16 (Ref # 92002A) | 92002-1659 | 2 |
| STUD,10X57 (Ref # 92004) | 92004-1202 | 2 |
| STUD,10X66 (Ref # 92004A) | 92004-1203 | 2 |
| FITTING,BREATHER (Ref # 92005) | 92005-1210 | 1 |
| SCREW,6X10 (Ref # 92009) | 92009-1563 | 3 |
| BUSHING,26X35X14 (Ref # 92028) | 92028-131 | 1 |
| CLAMP,HARNESS (Ref # 92037) | 92037-1318 | 1 |
| PIN,DOWEL,6.3X8X14 (Ref # 92042) | 92042-007 | 2 |
| PIN,11X14X12.3 (Ref # 92043) | 92043-1266 | 2 |
| BEARING-BALL,#6905 (Ref # 92045) | 92045-036 | 1 |
| BEARING-BALL,63/22T2C3 (Ref # 92045A) | 92045-1134 | 1 |
| BEARING-BALL,TMB3/28JR2C3 (Ref # 92045B) | 92045-1183 | 2 |
| BEARING-BALL (Ref # 92045C) | 92045-1211 | 1 |
| BEARING-BALL (Ref # 92045D) | 92045-1212 | 1 |
| BEARING-BALL (Ref # 92045E) | 92045-1233 | 1 |
| BEARING-BALL (Ref # 92045F) | 92045-1240 | 1 |
| BEARING-NEEDLE,7E-HK1412 (Ref # 92046) | 92046-037 | 1 |
| BEARING-NEEDLE,HK1210 (Ref # 92046A) | 92046-1010 | 2 |
| SEAL-OIL,TCJ25457 (Ref # 92049) | 92049-1051 | 1 |
| SEAL-OIL,TCJ20407 (Ref # 92049A) | 92049-1052 | 1 |
| SEAL-OIL (Ref # 92049B) | 92049-1262 | 1 |
| SEAL-OIL,TB3040 (Ref # 92050) | 92050-033 | 1 |
| SEAL-OIL,TB13225.5 (Ref # 92051) | 92051-005 | 1 |
| GASKET,10.5X16X1,DRAIN PLUG (Ref # 92065) | 92065-058 | 1 |

1991 KDX250 PARTS LIST

Crankcase

| ITEM NAME | PART NUMBER | QUANTITY |
|---------------------------------|-------------|----------|
| PLUG,DRAIN (Ref # 92066) | 92066-1241 | 1 |
| TUBE,5X9X530 (Ref # 92190) | 92190-1256 | 1 |
| BOLT-FLANGED-SMALL (Ref # 132) | 132G0616 | 1 |
| BOLT-FLANGED-SMALL (Ref # 132A) | 132G0645 | 12 |