

1995 KE100 PARTS DIAGRAM

Crankcase

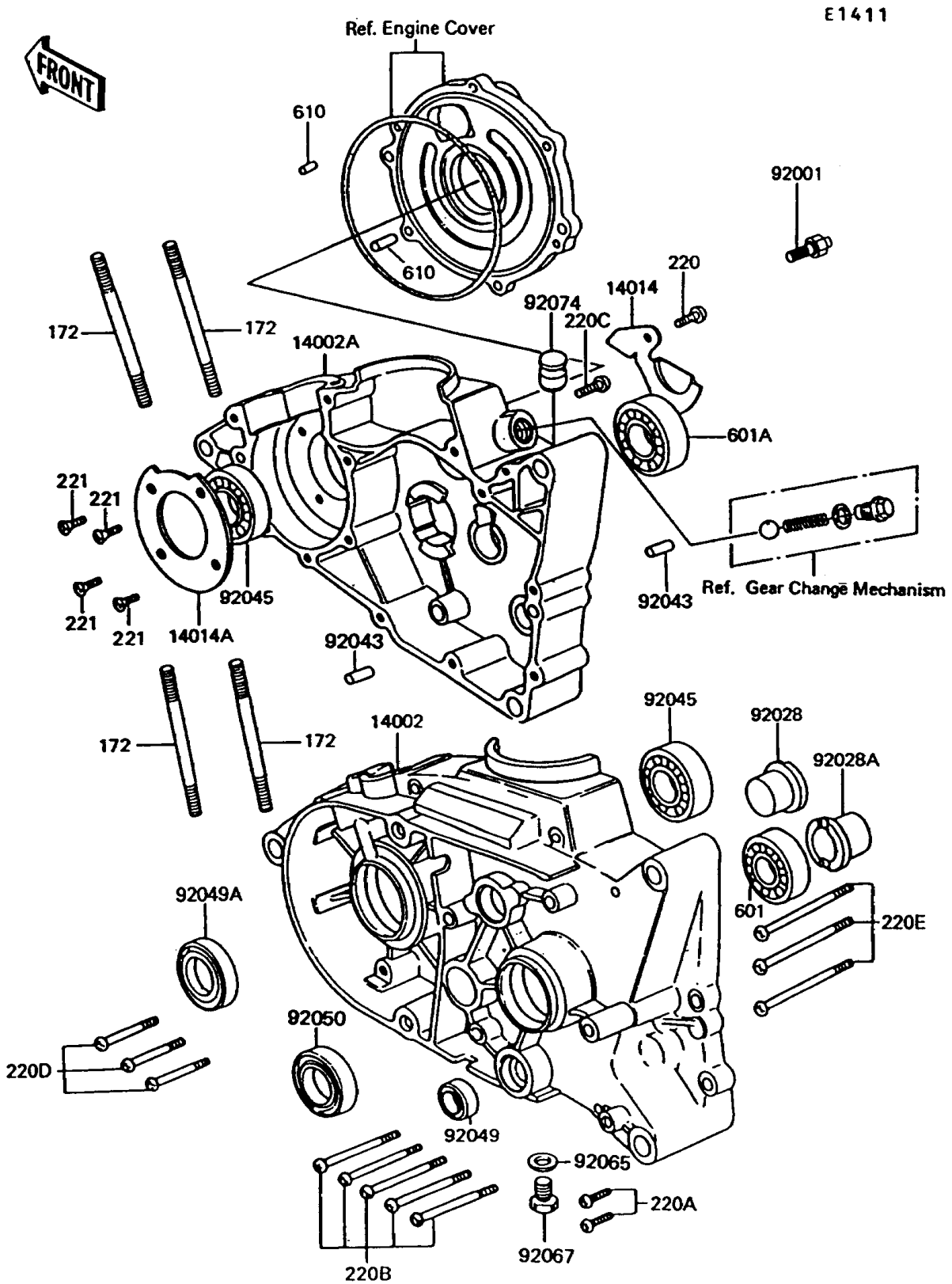

1995 KE100 PARTS LIST

Crankcase

| ITEM NAME | PART NUMBER | QUANTITY |
|---|-------------|----------|
| BOLT-STUD,8X115 (Ref # 172) | 172G08115 | 4 |
| SCREW-PAN-CROS,6X12 (Ref # 220) | 220B0612 | 1 |
| SCREW-PAN-CROS,6X25 (Ref # 220A) | 220B0625 | 2 |
| SCREW-PAN-CROS,6X40 (Ref # 220B) | 220B0640 | 5 |
| SCREW-PAN-CROS (Ref # 220C) | 220X0620 | 1 |
| SCREW-PAN-CROS (Ref # 220D) | 220X0660 | 3 |
| SCREW-PAN-CROS (Ref # 220E) | 220X0665 | 3 |
| SCREW-CSK-CROS,6X16 (Ref # 221) | 221B0616 | 4 |
| BEARING-BALL,#6004C3 (Ref # 601) | 601B6004 | 1 |
| BEARING-BALL,#6005C3 (Ref # 601A) | 601B6005 | 1 |
| ROLLER,5X12 (Ref # 610) | 610A0512 | 2 |
| CRANKCASE,LH (Ref # 14002) | 14002-1074 | 1 |
| CRANKCASE,RH (Ref # 14002A) | 14002-1210 | 1 |
| PLATE-POSITION (Ref # 14014) | 14014-008 | 1 |
| PLATE-POSITION (Ref # 14014A) | 14014-017 | 1 |
| BOLT,CHANGE DRUM STOP (Ref # 92001) | 92001-1426 | 1 |
| BUSHING,L=23.5 (Ref # 92028) | 92028-025 | 1 |
| BUSHING,L=14 (Ref # 92028A) | 92028-069 | 1 |
| PIN,8X16 (Ref # 92043) | 92043-1322 | 3 |
| BEARING-BALL,#6204 (Ref # 92045) | 92045-1032 | 2 |
| SEAL-OIL,SB12205 (Ref # 92049) | 92049-004 | 1 |
| SEAL-OIL (Ref # 92049A) | 92049-1240 | 1 |
| SEAL-OIL,SC25376 (Ref # 92050) | 92050-013 | 1 |
| GASKET,10.5X16X1,DRAIN PLUG (Ref # 92065) | 92065-058 | 1 |
| PLUG,DRAIN,10X12 (Ref # 92067) | 92067-001 | 1 |
| PLUG,15X19 (Ref # 92074) | 92074-035 | 1 |