

1996 KE100 PARTS DIAGRAM

Front Hub

F2230

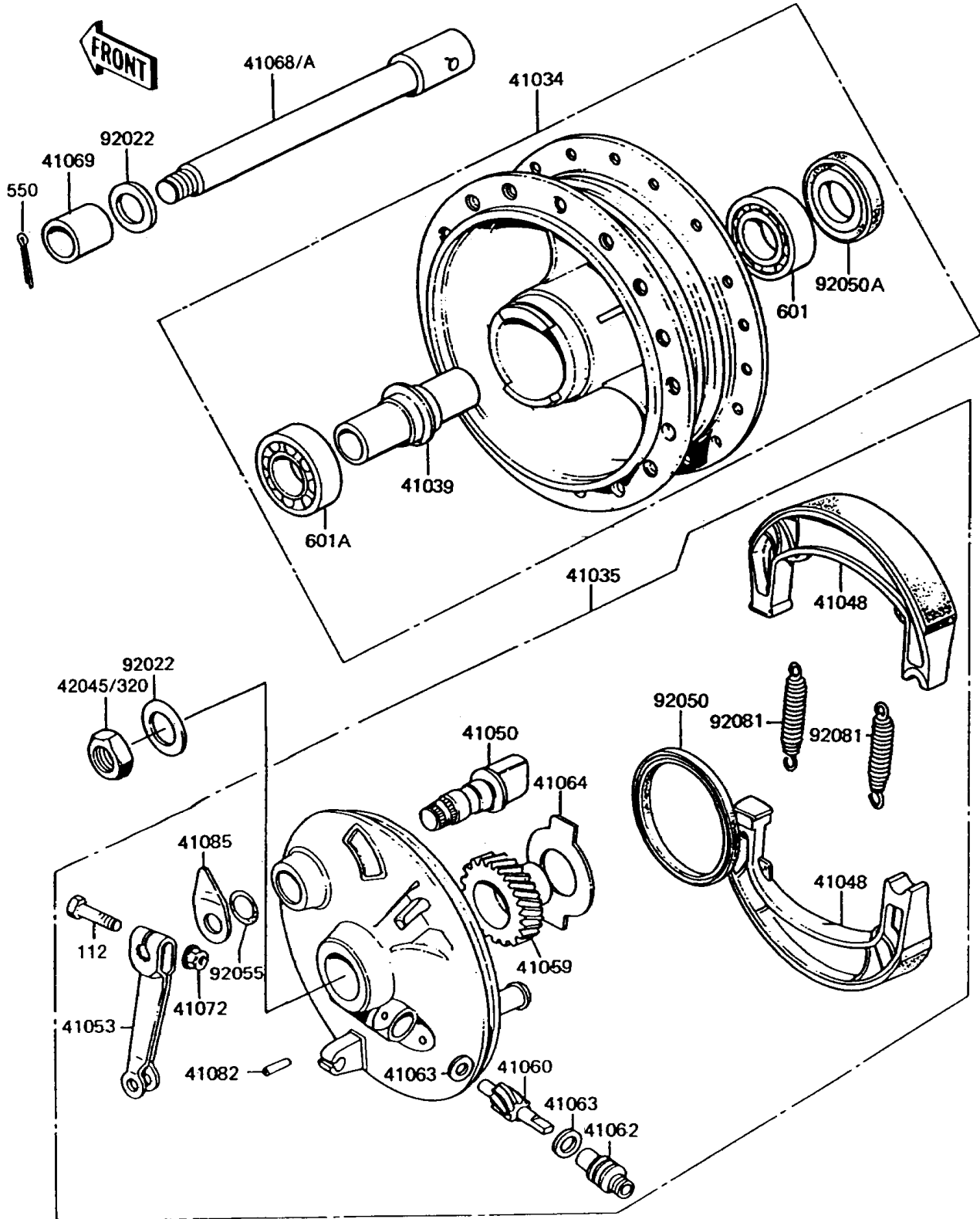

1996 KE100 PARTS LIST

Front Hub

| ITEM NAME | PART NUMBER | QUANTITY |
|-----------------------------------------|-------------|----------|
| BOLT-UPSET (Ref # 112) | 112G0630 | 1 |
| NUT-CASTLE,10MM (Ref # 320) | 320B1000 | 1 |
| PIN-COTTER,2.5X25 (Ref # 550) | 550D2525 | 1 |
| BEARING-BALL,#6200G (Ref # 601) | 601B6200G | 1 |
| BEARING-BALL,#6300ZG (Ref # 601A) | 601B6300ZG | 1 |
| DRUM-ASSY,FR (Ref # 41034) | 41034-1047 | 1 |
| PANEL-ASSY-BRAKE,FR (Ref # 41035) | 41035-1291 | 1 |
| COLLAR,L=51 (Ref # 41039) | 41039-002 | 1 |
| SHOE-BRAKE (Ref # 41048) | 41048-1085 | 2 |
| CAM-BRAKE (Ref # 41050) | 41050-018 | 1 |
| LEVER-BRAKE CAM (Ref # 41053) | 41053-005 | 1 |
| GEAR-METER SCREW,22T (Ref # 41059) | 41059-022 | 1 |
| GEAR-METER SCREW,8T (Ref # 41060) | 41060-004 | 1 |
| BUSHING,SPEEDOMETER CABLE (Ref # 41062) | 41062-005 | 1 |
| WASHER,5.1X9X0.4 (Ref # 41063) | 41063-001 | 2 |
| RECEIVER-SPEEDOMETER (Ref # 41064) | 41064-010 | 1 |
| AXLE,FR (Ref # 41068A) | 41068-1359 | 1 |
| COLLAR,L=13 (Ref # 41069) | 41069-026 | 1 |
| NUT,6MM (Ref # 41072) | 41072-007 | 1 |
| PIN,SPRING (Ref # 41082) | 41082-001 | 1 |
| INDICATOR,BRAKE SHOE (Ref # 41085) | 41085-008 | 1 |
| WASHER,10.5X22X1.6 (Ref # 92022) | 92022-1558 | 2 |
| SEAL-OIL,BRAKE PANEL (Ref # 92050) | 92050-002 | 1 |
| SEAL-OIL,TC17317 (Ref # 92050A) | 92050-063 | 1 |
| RING-O,BRAKE CAM (Ref # 92055) | 92055-004 | 1 |
| SPRING,BRAKE SHOE (Ref # 92081) | 92081-1766 | 2 |