

2001 KE100 PARTS DIAGRAM

Carburetor

E1611

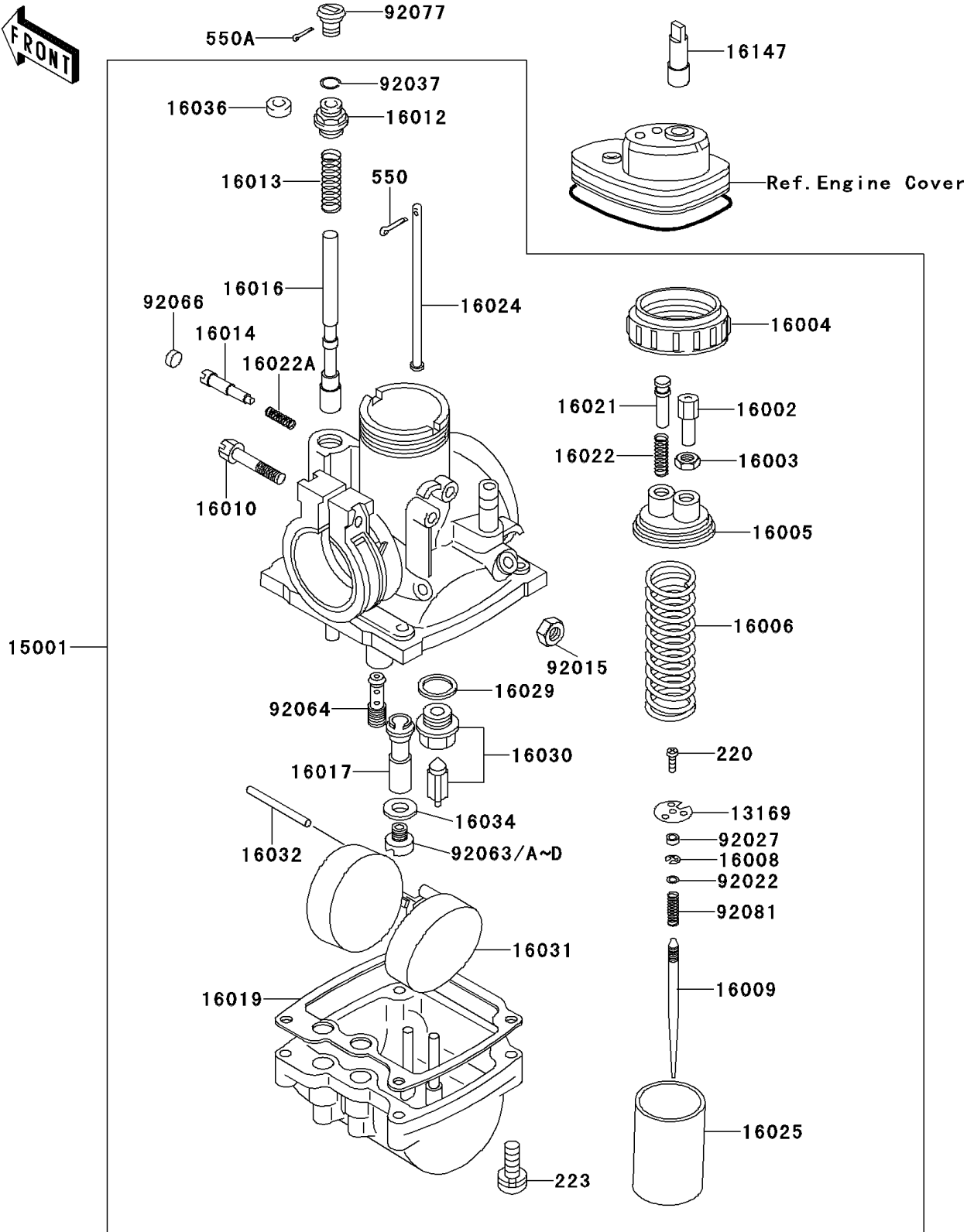

2001 KE100 PARTS LIST

Carburetor

ITEM NAME	PART NUMBER	QUANTITY
PLATE,THROTTLE VALVE (Ref # 13169)	13169-1676	1
CARBURETOR-ASSY (Ref # 15001)	15001-1220	1
ADJUSTER-CABLE (Ref # 16002)	16002-017	1
NUT,CABLE ADJUST LOCK (Ref # 16003)	16003-004	1
CAP-CHAMBER,MIXING (Ref # 16004)	16004-010	1
TOP-CHAMBER,MIXING (Ref # 16005)	16005-005	1
SPRING,THROTTLE VALVE (Ref # 16006)	16006-013	1
CLAMP,E-TYPE (Ref # 16008)	16008-010	1
NEEDLE-JET,4EJ39 (Ref # 16009)	16009-1289	1
SCREW,CLAMP (Ref # 16010)	16010-004	1
CAP-STARTER PLUNGER (Ref # 16012)	16012-021	1
SPRING,STARTER PLUNGER (Ref # 16013)	16013-010	1
SCREW-PILOT AIR (Ref # 16014)	16014-002	1
PLUNGER,STARTER (Ref # 16016)	16016-012	1
JET-NEEDLE,O-1 (Ref # 16017)	16017-1299	1
GASKET,FLOAT CHAMBER (Ref # 16019)	16019-021	1
SCREW-THROTTLE STOP (Ref # 16021)	16021-002	1
SPRING,THROTTLE STOP SCREW (Ref # 16022)	16022-005	1
SPRING,PILOT AIR SCREW (Ref # 16022A)	16022-007	1
ROD,THROTTLE VALVE STOP (Ref # 16024)	16024-006	1
VALVE-THROTTLE,CA2.0 (Ref # 16025)	16025-1013	1
GASKET,FLOAT VALVE SEAT (Ref # 16029)	16029-002	1
SCREW-PAN-CROS (Ref # 220)	220B0308	1
VALVE-FLOAT,#2.0 (Ref # 16030)	16030-001	1
FLOAT (Ref # 16031)	16031-015	1
PIN,FLOAT (Ref # 16032)	16032-003	1
WASHER,MAIN JET (Ref # 16034)	16034-001	1
BOOT,STARTER PLUNGER (Ref # 16036)	16036-012	1
PLUG,12X40 (Ref # 16147)	16147-001	1

2001 KE100 PARTS LIST

Carburetor

ITEM NAME	PART NUMBER	QUANTITY
NUT,6MM (Ref # 92015)	92015-1026	1
WASHER,THROTTLE VALVE (Ref # 92022)	92022-1068	1
COLLAR,THROTTLE VALVE (Ref # 92027)	92027-1103	1
CLAMP (Ref # 92037)	92037-1077	1
JET-MAIN,#A80R (Ref # 92063)	92063-1030	1
JET-MAIN,#A77.5R (Ref # 92063A)	92063-1032	1
JET-MAIN,#A75R (Ref # 92063B)	92063-1111	1
JET-MAIN,#A82,5R (Ref # 92063C)	92063-1322	1
JET-MAIN,#A85R (Ref # 92063D)	92063-1323	1
JET-PILOT,#A15 (Ref # 92064)	92064-1018	1
PLUG,PILOT AIR SCREW,6.9X2 (Ref # 92066)	92066-1051	1
KNOB,CARBURETOR (Ref # 92077)	92077-022	1
SPRING,JET NEEDLE (Ref # 92081)	92081-1072	1
SCREW-PAN-WS-CROS (Ref # 223)	223B0418	4
PIN-COTTER,1.2X10 (Ref # 550)	550D1210	1
PIN-COTTER,1.6X15 (Ref # 550A)	550D1615	1