

# 2013 VULCAN® 1700 VOYAGER® ABS PARTS DIAGRAM

Front Fork

F2340

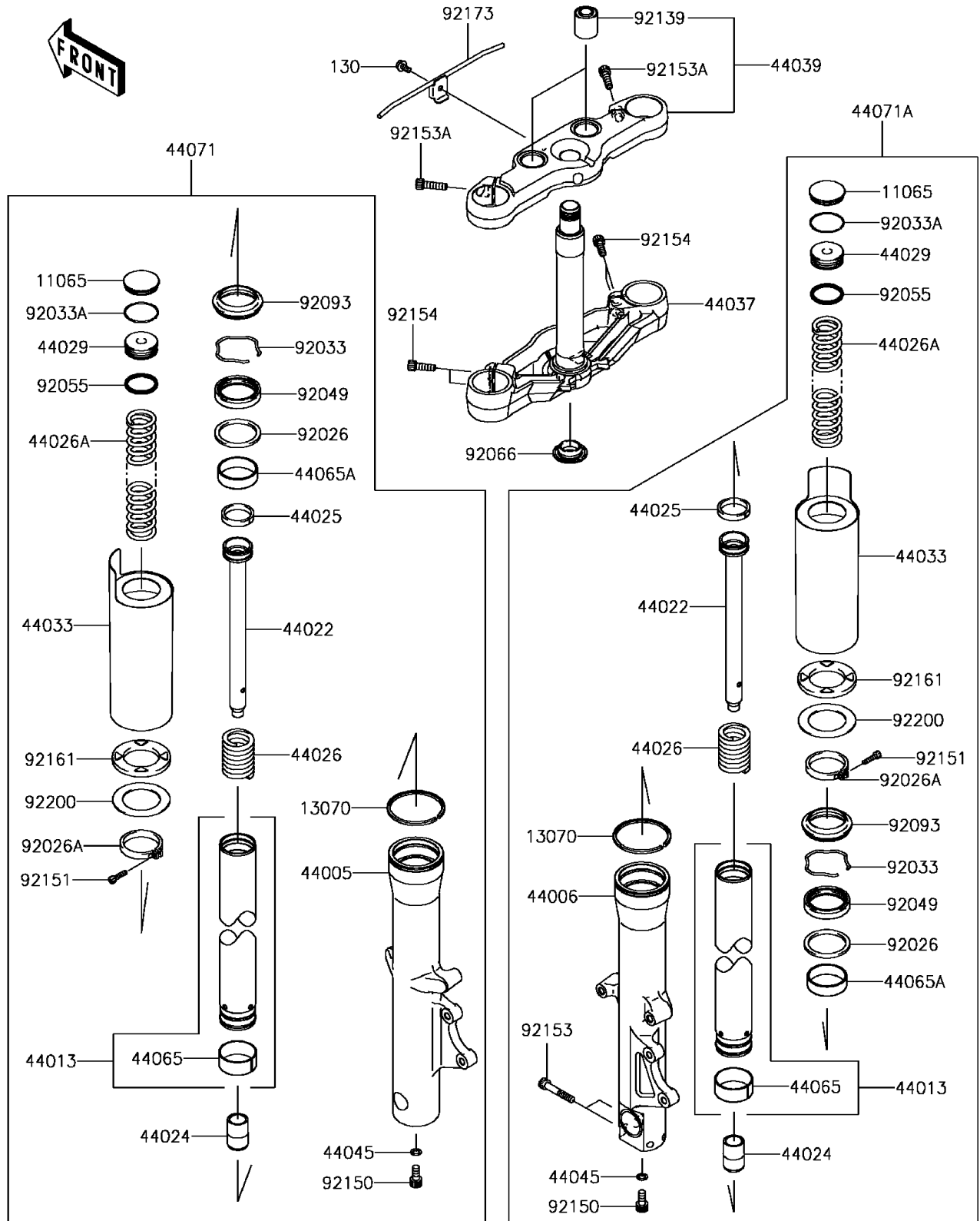

## 2013 VULCAN® 1700 VOYAGER® ABS PARTS LIST

### Front Fork

ITEM NAME	PART NUMBER	QUANTITY
BOLT-FLANGED,6X12 (Ref # 130)	130BB0612	1
CAP,FORK TOP (Ref # 11065)	11065-0279	2
GUIDE,CASE (Ref # 13070)	13070-0103	2
PIPE-LEFT FORK OUTER (Ref # 44005)	44005-0073	1
PIPE-RIGHT FORK OUTER (Ref # 44006)	44006-0067	1
PIPE-FORK INNER (Ref # 44013)	44013-0124	2
CYLINDER-FORK (Ref # 44022)	44022-0026	2
CAP-OIL-LOCK (Ref # 44024)	44024-0006	2
RING-FORK PISTON (Ref # 44025)	44025-0005	2
SPRING-FRONT FORK (Ref # 44026)	44026-0129	2
SPRING-FRONT FORK (Ref # 44026A)	44026-0138	2
SEAT-FORK SPRING (Ref # 44029)	44029-0012	2
COVER-FORK (Ref # 44033)	44033-0052	2
HOLDER-FORK UNDER (Ref # 44037)	44037-0086	1
HOLDER-FORK UPPER (Ref # 44039)	44039-0099	1
GASKET,FORK CYLINDER BOLT (Ref # 44045)	44045-051	2
BUSHING-FRONT FORK,INNER TUBE (Ref # 44065)	44065-0023	2
BUSHING-FRONT FORK (Ref # 44065A)	44065-0024	2
DAMPER-ASSY,FORK,LH (Ref # 44071)	44071-0551	1
DAMPER-ASSY,FORK,RH (Ref # 44071A)	44071-0605	1
SPACER (Ref # 92026)	92026-0132	2
SPACER (Ref # 92026A)	92026-0133	2
RING-SNAP (Ref # 92033)	92033-0060	2
RING-SNAP (Ref # 92033A)	92033-1303	2
SEAL-OIL (Ref # 92049)	92049-0118	2
RING-O (Ref # 92055)	92055-0169	2
PLUG (Ref # 92066)	92066-0032	1
SEAL,DUST (Ref # 92093)	92093-0147	2
BUSHING (Ref # 92139)	92139-0285	2

## 2013 VULCAN® 1700 VOYAGER® ABS PARTS LIST

### Front Fork

ITEM NAME	PART NUMBER	QUANTITY
BOLT,SOCKET,8X18 (Ref # 92150)	92150-1432	2
BOLT,SOCKET,4X16 (Ref # 92151)	92151-1356	2
BOLT (Ref # 92153)	92153-0499	2
BOLT,SOCKET,8X30 (Ref # 92153A)	92153-0500	2
BOLT,SOCKET (Ref # 92154)	92154-0113	4
DAMPER (Ref # 92161)	92161-0683	2
CLAMP (Ref # 92173)	92173-0035	1
WASHER (Ref # 92200)	92200-0468	2