

# 2004 Super Sherpa (Canada Only) PARTS DIAGRAM

Rear Suspension

F2150

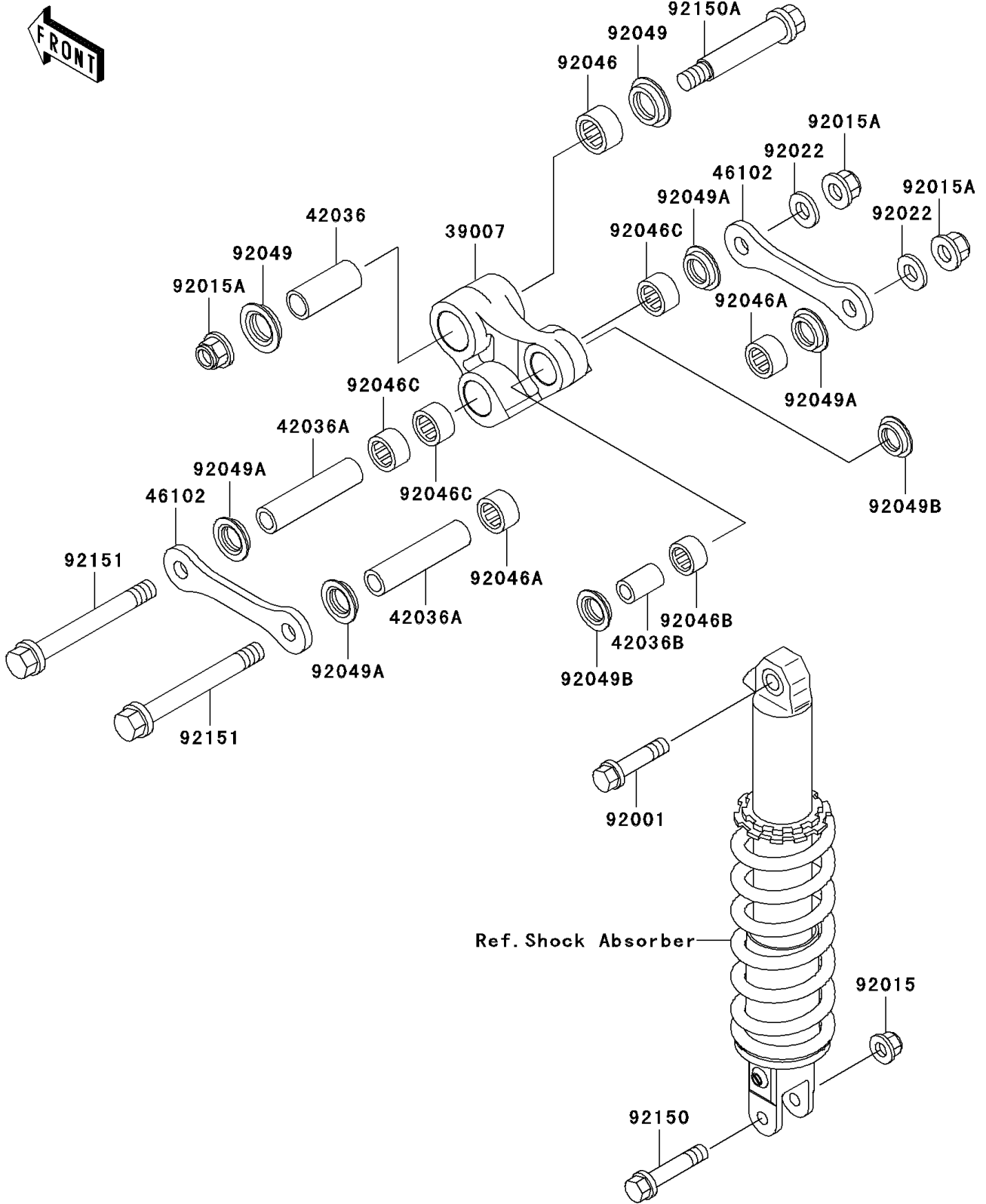

## 2004 Super Sherpa (Canada Only) PARTS LIST

### Rear Suspension

ITEM NAME	PART NUMBER	QUANTITY
ARM-SUSP,UNI TRAK (Ref # 39007)	39007-1265	1
SLEEVE,15X20X47.5 (Ref # 42036)	42036-1204	1
SLEEVE,12.1X18X77.5 (Ref # 42036A)	42036-1336	2
SLEEVE,10.1X16X26.5 (Ref # 42036B)	42036-1337	1
ROD,SUSPENSION (Ref # 46102)	46102-1428	2
BOLT,FLANGED,10X44 (Ref # 92001)	92001-1499	1
NUT,FLANGED,10MM (Ref # 92015)	92015-1335	1
NUT,FLANGED,12MM (Ref # 92015A)	92015-1433	3
WASHER,12.4X28X4.5 (Ref # 92022)	92022-1196	2
BEARING-NEEDLE,BM202726 (Ref # 92046)	92046-1110	1
BEARING-NEEDLE,18BM2416 (Ref # 92046A)	92046-1144	2
BEARING-NEEDLE,16BM2212 (Ref # 92046B)	92046-1192	1
BEARING-NEEDLE,7E-HVS18X24X16 (Ref # 92046C)	92046-1238	3
SEAL-OIL,ARM,CNT (Ref # 92049)	92049-1109	2
SEAL-OIL (Ref # 92049A)	92049-1328	4
SEAL-OIL,SD03 16 22 5.7 (Ref # 92049B)	92049-1466	2
BOLT,FLANGED,10X50 (Ref # 92150)	92150-1125	1
BOLT,ROD,12X85 (Ref # 92150A)	92150-1213	1
BOLT,FLANGED,12X110 (Ref # 92151)	92151-1169	2