

2003 KLR650 PARTS DIAGRAM

Engine Cover(s)

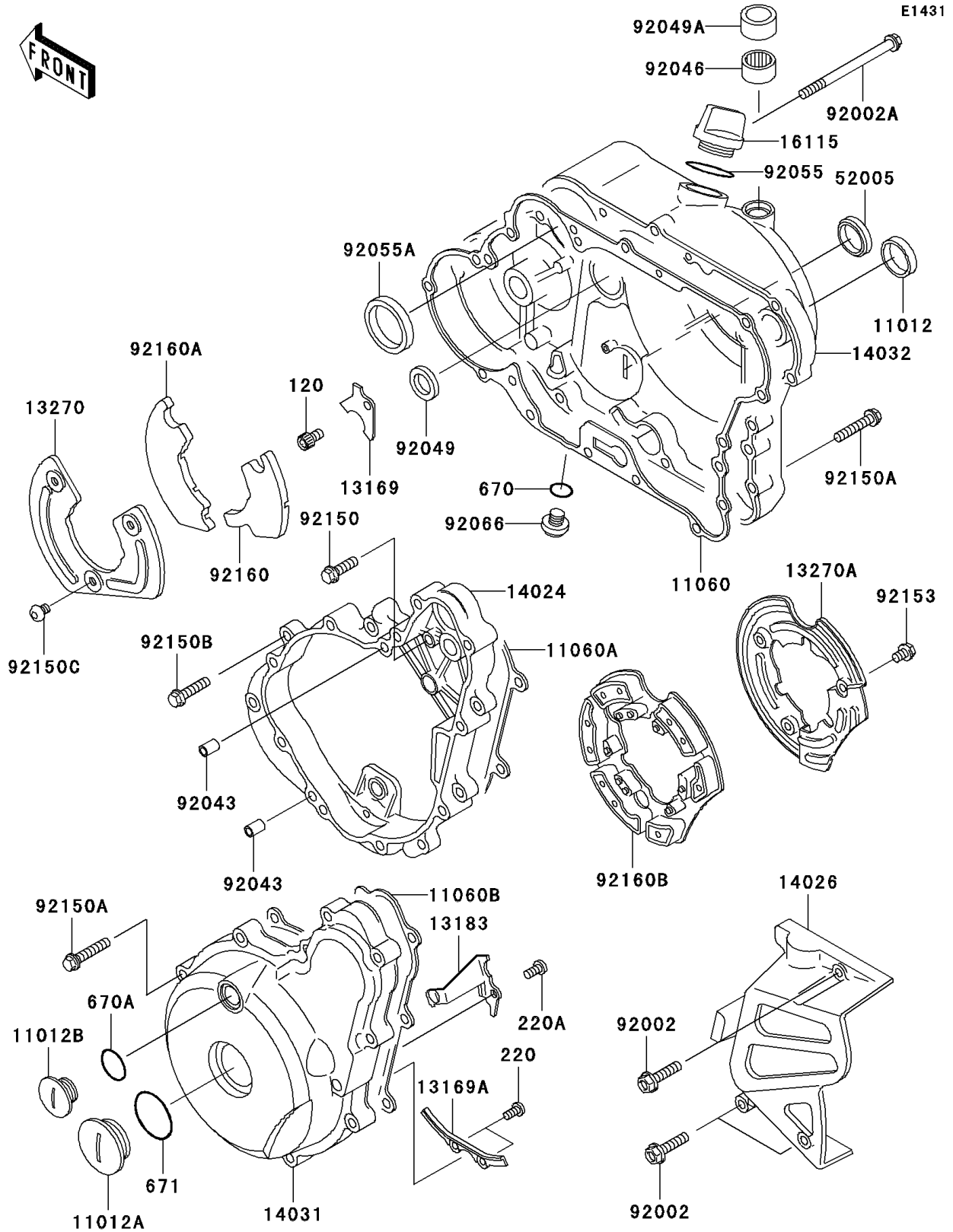

2003 KLR650 PARTS LIST

Engine Cover(s)

| ITEM NAME | PART NUMBER | QUANTITY |
|--|-------------|----------|
| BOLT-SOCKET,6X10 (Ref # 120) | 120P0610 | 1 |
| SCREW-PAN-CROS (Ref # 220) | 220B0510 | 2 |
| SCREW-PAN-CROS,6X12 (Ref # 220A) | 220B0612 | 1 |
| O RING,11MM (Ref # 670) | 670B2011 | 1 |
| O RING,18MM (Ref # 670A) | 670B2018 | 1 |
| O RING,40MM (Ref # 671) | 671B2540 | 1 |
| CAP (Ref # 11012) | 11012-1567 | 1 |
| CAP (Ref # 11012A) | 11012-1693 | 1 |
| CAP,TOP MARK (Ref # 11012B) | 11012-1694 | 1 |
| GASKET,CLUTCH COVER (Ref # 11060) | 11060-1111 | 1 |
| GASKET,GENERATOR CASE COVER (Ref # 11060A) | 11060-1692 | 1 |
| GASKET,GENERATOR COVER (Ref # 11060B) | 11060-1693 | 1 |
| PLATE,OIL SEAL (Ref # 13169) | 13169-1735 | 1 |
| PLATE,PULSING COIL LEAD (Ref # 13169A) | 13169-1882 | 1 |
| PLATE,GENERATOR (Ref # 13183) | 13183-1144 | 1 |
| PLATE (Ref # 13270) | 13270-1438 | 1 |
| PLATE (Ref # 13270A) | 13270-1667 | 1 |
| COVER,GENERATOR CASE (Ref # 14024) | 14024-1773 | 1 |
| COVER-CHAIN (Ref # 14026) | 14026-1225 | 1 |
| COVER-GENERATOR (Ref # 14031) | 14031-1305 | 1 |
| COVER-CLUTCH (Ref # 14032) | 14032-1488 | 1 |
| CAP-OIL FILLER (Ref # 16115) | 16115-1009 | 1 |
| GAUGE,OIL LEVEL (Ref # 52005) | 52005-1009 | 1 |
| BOLT,6X25 (Ref # 92002) | 92002-1086 | 3 |
| BOLT,6X80 (Ref # 92002A) | 92002-1568 | 1 |
| PIN,6.2X8X14 (Ref # 92043) | 92043-1263 | 2 |
| BEARING-NEEDLE,HK1210 (Ref # 92046) | 92046-1010 | 1 |
| SEAL-OIL,SCY 15X30X7 (Ref # 92049) | 92049-1158 | 1 |
| SEAL-OIL,TB12205.5 (Ref # 92049A) | 92049-1271 | 1 |

2003 KLR650 PARTS LIST

Engine Cover(s)

| ITEM NAME | PART NUMBER | QUANTITY |
|-----------------------------------|-------------|----------|
| RING-O,31.7X2.4 (Ref # 92055) | 92055-049 | 1 |
| RING-O,62.6X66X3.1 (Ref # 92055A) | 92055-1221 | 1 |
| PLUG,DRAIN (Ref # 92066) | 92066-1156 | 1 |
| BOLT,6X20 (Ref # 92150) | 92150-1010 | 1 |
| BOLT,6X30 (Ref # 92150A) | 92150-1021 | 24 |
| BOLT,6X25 (Ref # 92150B) | 92150-1779 | 8 |
| BOLT,6X7 (Ref # 92150C) | 92150-1902 | 3 |
| BOLT,6X8 (Ref # 92153) | 92153-0528 | 3 |
| DAMPER (Ref # 92160) | 92160-1608 | 1 |
| DAMPER (Ref # 92160A) | 92160-1609 | 1 |
| DAMPER (Ref # 92160B) | 92160-1763 | 1 |