

1988 Mojave 110E PARTS DIAGRAM

Camshaft(s)/Tensioner

E1230-0057

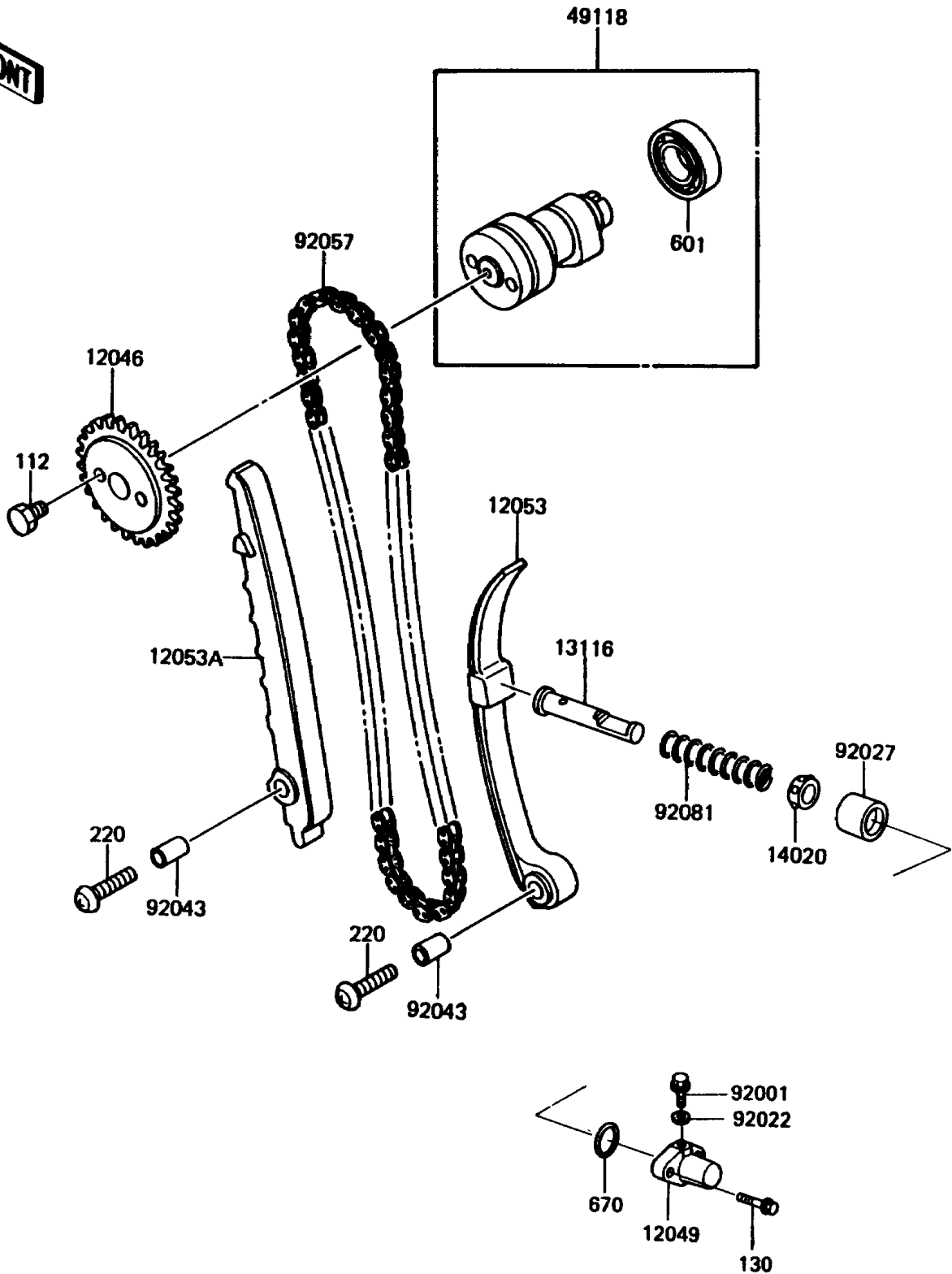

1988 Mojave 110E PARTS LIST

Camshaft(s)/Tensioner

| ITEM NAME | PART NUMBER | QUANTITY |
|-------------------------------------|-------------|----------|
| SPROCKET,CAM CHAIN (Ref # 12046) | 12046-1035 | 1 |
| TENSIONER,CAM CHAIN (Ref # 12049) | 12049-1055 | 1 |
| GUIDE-CHAIN,RR (Ref # 12053) | 12053-1082 | 1 |
| GUIDE-CHAIN,FR (Ref # 12053A) | 12053-1087 | 1 |
| ROD-PUSH,TENSIONER (Ref # 13116) | 13116-1019 | 1 |
| RETAINER,TENSIONER (Ref # 14020) | 14020-1054 | 1 |
| CAMSHAFT-COMP (Ref # 49118) | 49118-1005 | 1 |
| BOLT,TENSIONER ADJUST (Ref # 92001) | 92001-1155 | 1 |
| WASHER,6.1X12X1 (Ref # 92022) | 92022-077 | 1 |
| COLLAR,TENSIONER (Ref # 92027) | 92027-1273 | 1 |
| PIN,DOWEL,6.3X8X14 (Ref # 92043) | 92042-007 | 2 |
| CHAIN,CAM,BF25H-88L (Ref # 92057) | 92057-1116 | 1 |
| SPRING,TENSIONER (Ref # 92081) | 92081-1105 | 1 |
| BOLT-UPSET (Ref # 112) | 112G0610 | 2 |
| BOLT-FLANGED (Ref # 130) | 130Y0625 | 2 |
| SCREW-PAN-CROS,6X25 (Ref # 220) | 220B0625 | 2 |
| BEARING-BALL,#6002Z (Ref # 601) | 601A6002Z | 1 |
| O RING,21MM (Ref # 670) | 670B2021 | 1 |