

# 1990 Bayou 220 PARTS DIAGRAM

Transmission

E1361-0190

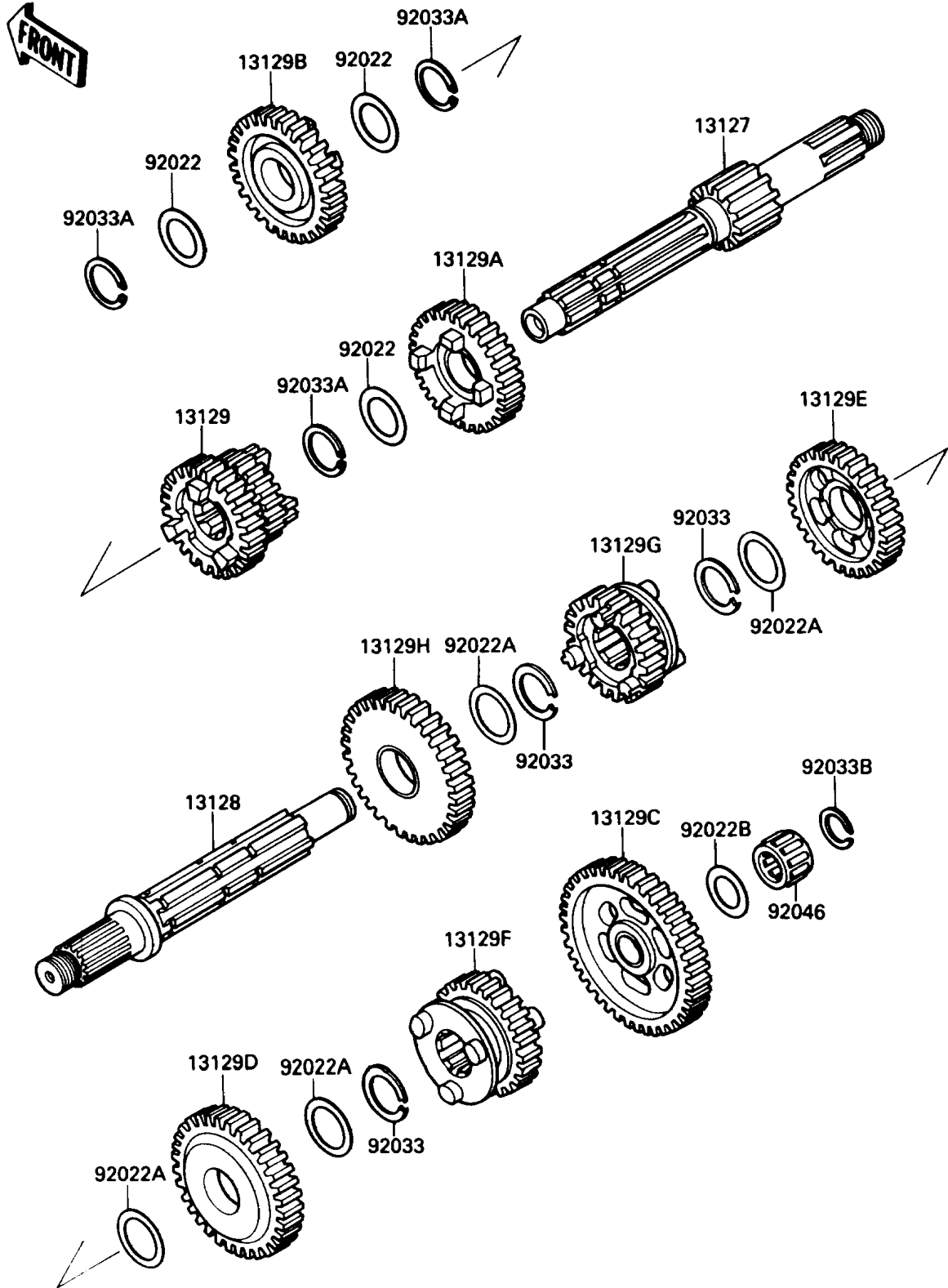

# 1990 Bayou 220 PARTS LIST

## Transmission

ITEM NAME	PART NUMBER	QUANTITY
SHAFT-TRANSMISSION INPUT,13T (Ref # 13127)	13127-1152	1
SHAFT-TRANSMISSION OUTPUT (Ref # 13128)	13128-1146	1
GEAR,INPUT 2ND&3RD,23T&19T (Ref # 13129)	13129-1860	1
GEAR,INPUT 4TH,26 (Ref # 13129A)	13129-1861	1
GEAR,INPUT TOP,28T (Ref # 13129B)	13129-1862	1
GEAR,OUTPUT LOW,38T (Ref # 13129C)	13129-1864	1
GEAR,OUTPUT 2ND,32T (Ref # 13129D)	13129-1865	1
GEAR,OUTPUT 3RD,27T (Ref # 13129E)	13129-1866	1
GEAR,OUTPUT 4TH,24T (Ref # 13129F)	13129-1867	1
GEAR,OUTPUT TOP,22T (Ref # 13129G)	13129-1868	1
GEAR,REVERSE,33T (Ref # 13129H)	13129-1869	1
WASHER (Ref # 92022)	92022-1885	3
WASHER,22.3X27X0.5 (Ref # 92022A)	92022-198	4
WASHER,15.3X25X1 (Ref # 92022B)	92022-279	1
RING-SNAP,20X25.5X1.2 (Ref # 92033)	92033-025	3
RING-SNAP,18MM (Ref # 92033A)	92033-029	3
RING-SNAP,14X17.5X1.2 (Ref # 92033B)	92033-1234	1
BEARING-NEEDLE,K15X21X15 (Ref # 92046)	92046-1173	1