

1988 Bayou 220 PARTS DIAGRAM

Starter Motor

E1840-0090

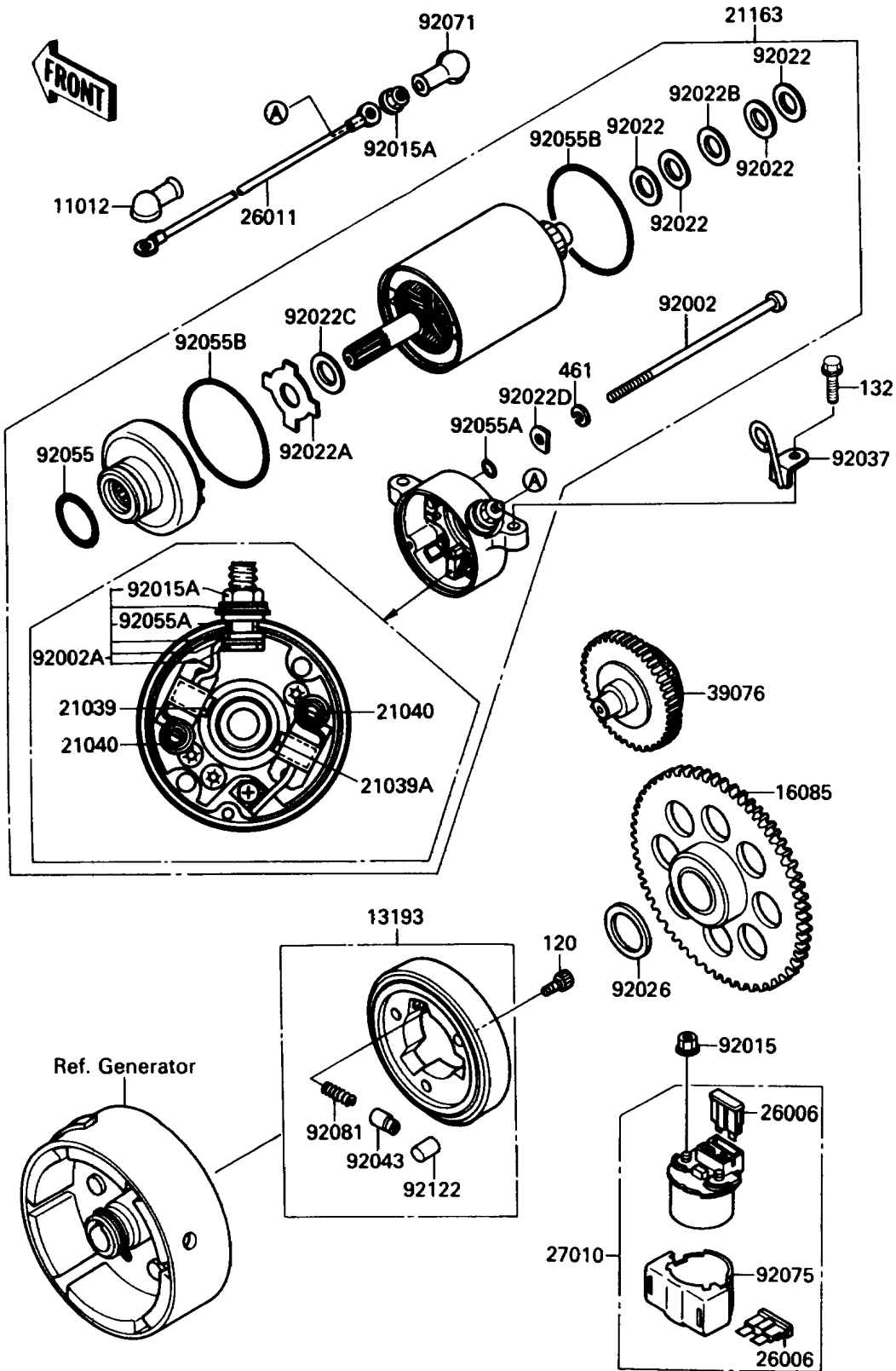

1988 Bayou 220 PARTS LIST

Starter Motor

ITEM NAME	PART NUMBER	QUANTITY
BOLT-SOCKET,8X14 (Ref # 120)	120P0814	3
BOLT-FLANGED-SMALL (Ref # 132)	132Y0625	2
WASHER-SPRING,5MM,BLACK (Ref # 461)	461K0500	2
CAP,TERMINAL (Ref # 11012)	11012-1354	1
CLUTCH-ASSY-ONEWAY (Ref # 13193)	13193-1002	1
GEAR,ONEWAY CLUTCH (Ref # 16085)	16085-1198	1
BRUSH,CARBON(+) (Ref # 21039)	21039-1001	1
BRUSH,CARBON(-) (Ref # 21039A)	21039-1056	1
SPRING-BRUSH (Ref # 21040)	21040-1053	2
STARTER-ELECTRIC (Ref # 21163)	21163-1130	1
FUSE,20A-Y (Ref # 26006)	26006-1051	2
WIRE-LEAD,STARTER (Ref # 26011)	26011-1417	1
SWITCH (Ref # 27010)	27010-1243	1
LIMITER,STARTER IDLE (Ref # 39076)	39076-1060	1
BOLT,STARTER (Ref # 92002)	92002-1818	2
BOLT,TERMINAL (Ref # 92002A)	92002-1819	1
NUT,FLANGED,6MM (Ref # 92015)	92015-1193	2
NUT,STARTER MOTOR (Ref # 92015A)	92015-1476	2
WASHER,9.1X18X0.2 (Ref # 92022)	21025-011	4
WASHER,THRUST SUPPORT (Ref # 92022A)	92022-1130	1
WASHER,9.1X18X0.8 (Ref # 92022B)	92022-1132	1
WASHER,22X12.2X0.5 (Ref # 92022C)	92022-1714	1
WASHER,LOCK (Ref # 92022D)	92022-1825	2
SPACER,22X35.5X1.0 (Ref # 92026)	92026-092	1
CLAMP (Ref # 92037)	92037-1962	1
PIN (Ref # 92043)	92043-132	3
RING-O (Ref # 92055)	92055-1303	1
RING-O,4.5X2.0 (Ref # 92055A)	92055-1370	3
RING-O (Ref # 92055B)	92055-1418	2

1988 Bayou 220 PARTS LIST

Starter Motor

ITEM NAME	PART NUMBER	QUANTITY
GROMMET,STARTER TERMINAL (Ref # 92071)	21017-017	1
DAMPER,MAGNETIC SWITCH (Ref # 92075)	92075-1863	1
SPRING,COIL (Ref # 92081)	92081-159	3
ROLLER (Ref # 92122)	92122-006	3