

1998 Bayou 300 PARTS DIAGRAM

Optional Parts(CN)(Brake Switch)

F2890C

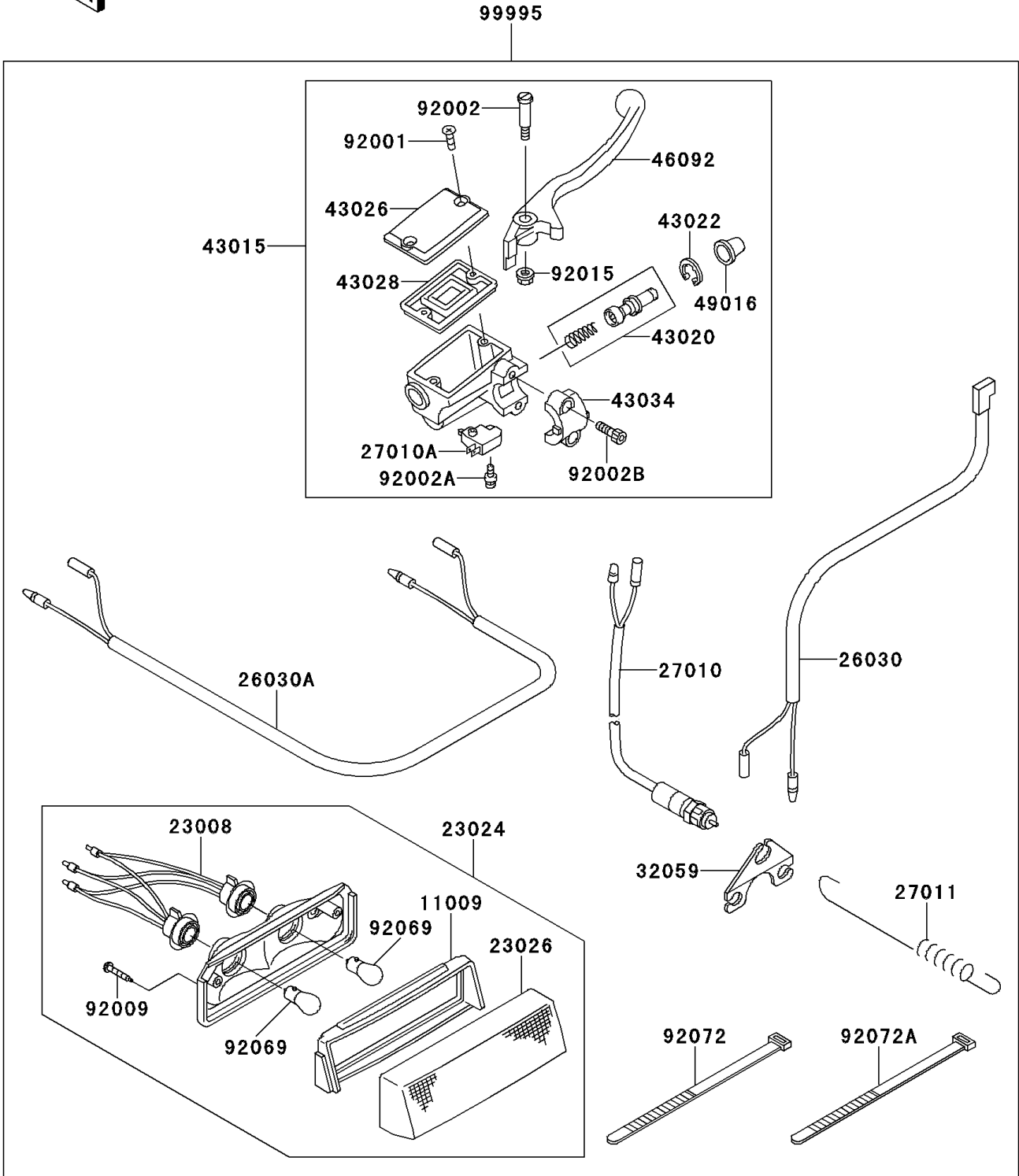

1998 Bayou 300 PARTS LIST

Optional Parts(CN)(Brake Switch)

ITEM NAME	PART NUMBER	QUANTITY
GASKET,TAIL LAMP (Ref # 11009)	11009-1404	1
SOCKET-ASSY,TAIL LAMP (Ref # 23008)	23008-1461	1
LAMP-ASSY-TAIL (Ref # 23024)	23024-1121	1
LENS,TAIL LAMP (Ref # 23026)	23026-1056	1
HARNESS (Ref # 26030)	26030-1058	1
HARNESS,REAR BRAKE (Ref # 26030A)	26030-1062	1
SWITCH,BRAKE LAMP (Ref # 27010)	27010-025	1
SWITCH,BRAKE (Ref # 27010A)	27010-1170	1
SPRING,SWITCH (Ref # 27011)	27011-014	1
BRACKET-SWITCH,REAR BRAKE (Ref # 32059)	32059-1107	1
CYLINDER-ASSY-MASTER,FR (Ref # 43015)	43015-1438	1
PISTON-COMP-BRAKE,FR (Ref # 43020)	43020-1056	1
STOPPER-BRAKE,PISTON (Ref # 43022)	43022-1010	1
CAP-BRAKE (Ref # 43026)	43026-1059	1
DIAPHRAGM,MASTER CYLINDER (Ref # 43028)	43028-1058	1
HOLDER-BRAKE,MASTER CYLINDER (Ref # 43034)	43034-1053	1
LEVER-GRIP,FRONT BRAKE (Ref # 46092)	46092-1167	1
COVER-SEAL,MASTER CYLINDER (Ref # 49016)	49016-1044	1
SCREW,5MM,BLACK (Ref # 92001)	92001-1727	2
BOLT,LEVER SET,BLACK (Ref # 92002)	92002-1322	1
BOLT,SCREW,4X12 (Ref # 92002A)	92002-1323	1
BOLT,SOCKET,6X20,BLACK (Ref # 92002B)	92002-1324	2
SCREW,TAPPING,4X30 (Ref # 92009)	92009-1056	2
NUT,FLANGED,6MM,BLACK (Ref # 92015)	92015-1233	1
BULB,12V 27/8W (Ref # 92069)	92069-059	2
BAND,L=123 (Ref # 92072)	92072-030	6
BAND,L=186 (Ref # 92072A)	92072-056	1
KIT.,BRAKE SWITCH (Ref # 99995)	99995-1441	1