

1994 Bayou 400 4X4 PARTS DIAGRAM

Engine Cover(s)

E1431

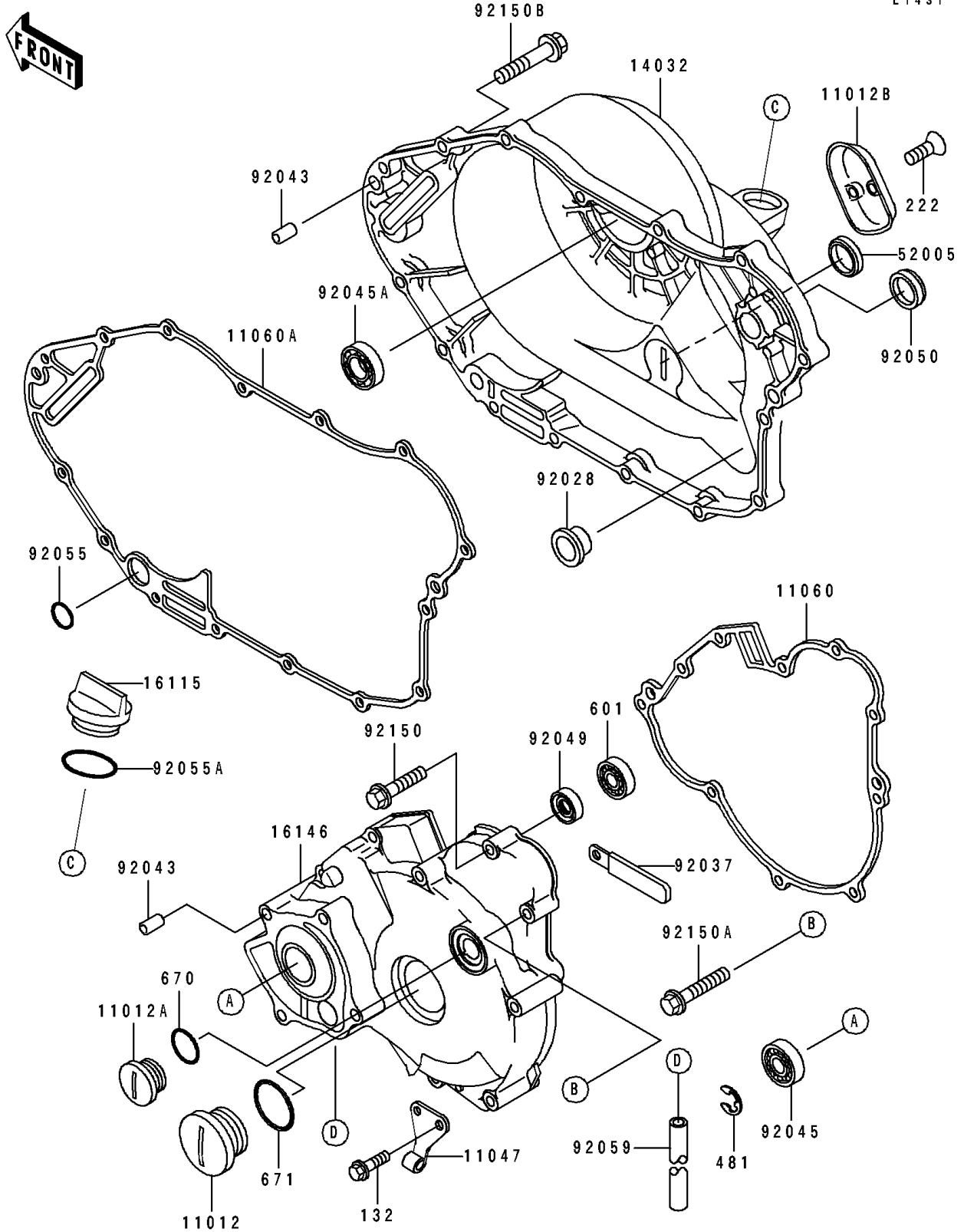

1994 Bayou 400 4X4 PARTS LIST

Engine Cover(s)

| ITEM NAME | PART NUMBER | QUANTITY |
|--|-------------|----------|
| CAP (Ref # 11012) | 11012-1362 | 1 |
| CAP, TOP MARK (Ref # 11012A) | 11012-1363 | 1 |
| CAP, CLUTCH RELEASE (Ref # 11012B) | 11012-1644 | 1 |
| BRACKET, CABLE (Ref # 11047) | 11047-1494 | 1 |
| GASKET, GENERATOR (Ref # 11060) | 11060-1208 | 1 |
| GASKET, CLUTCH COVER (Ref # 11060A) | 11060-1209 | 1 |
| COVER-CLUTCH (Ref # 14032) | 14032-5021 | 1 |
| CAP-OIL FILLER (Ref # 16115) | 16115-1009 | 1 |
| COVER-ASSY, GENERATOR (Ref # 16146) | 16146-1155 | 1 |
| GAUGE, OIL LEVEL (Ref # 52005) | 52005-1009 | 1 |
| BUSHING (Ref # 92028) | 92028-1544 | 1 |
| CLAMP, WIRING HARNESS (Ref # 92037) | 92037-1539 | 1 |
| PIN, 6.2X8X14 (Ref # 92043) | 92043-1263 | 4 |
| BEARING-BALL (Ref # 92045) | 92045-1206 | 1 |
| BEARING-BALL, 6303RUED2C3 (Ref # 92045A) | 92045-1256 | 1 |
| SEAL-OIL, SC10227 (Ref # 92049) | 92049-1157 | 1 |
| SEAL-OIL (Ref # 92050) | 92050-078 | 1 |
| RING-O, OD=18 (Ref # 92055) | 92055-048 | 1 |
| RING-O, 31.5X2.6 (Ref # 92055A) | 92055-049 | 1 |
| TUBE, 4.5X9X190 (Ref # 92059) | 92059-080 | 1 |
| BOLT, 6X35 (Ref # 92150) | 92150-1600 | 5 |
| BOLT, 6X50 (Ref # 92150A) | 92150-1601 | 5 |
| BOLT, 6X30 (Ref # 92150B) | 92150-1602 | 15 |
| BOLT-FLANGED-SMALL (Ref # 132) | 132G0612 | 1 |
| SCREW-CSK-RD-CROS (Ref # 222) | 222C0512 | 2 |
| CIRCLIP (Ref # 481) | 481J2200 | 1 |
| BEARING-BALL (Ref # 601) | 601A6000 | 1 |
| O RING, 18MM (Ref # 670) | 670B2018 | 1 |
| O RING, 40MM (Ref # 671) | 671B2540 | 1 |