

2004 KLX125L PARTS DIAGRAM

Valve(s)/Camshaft(s)

E1211

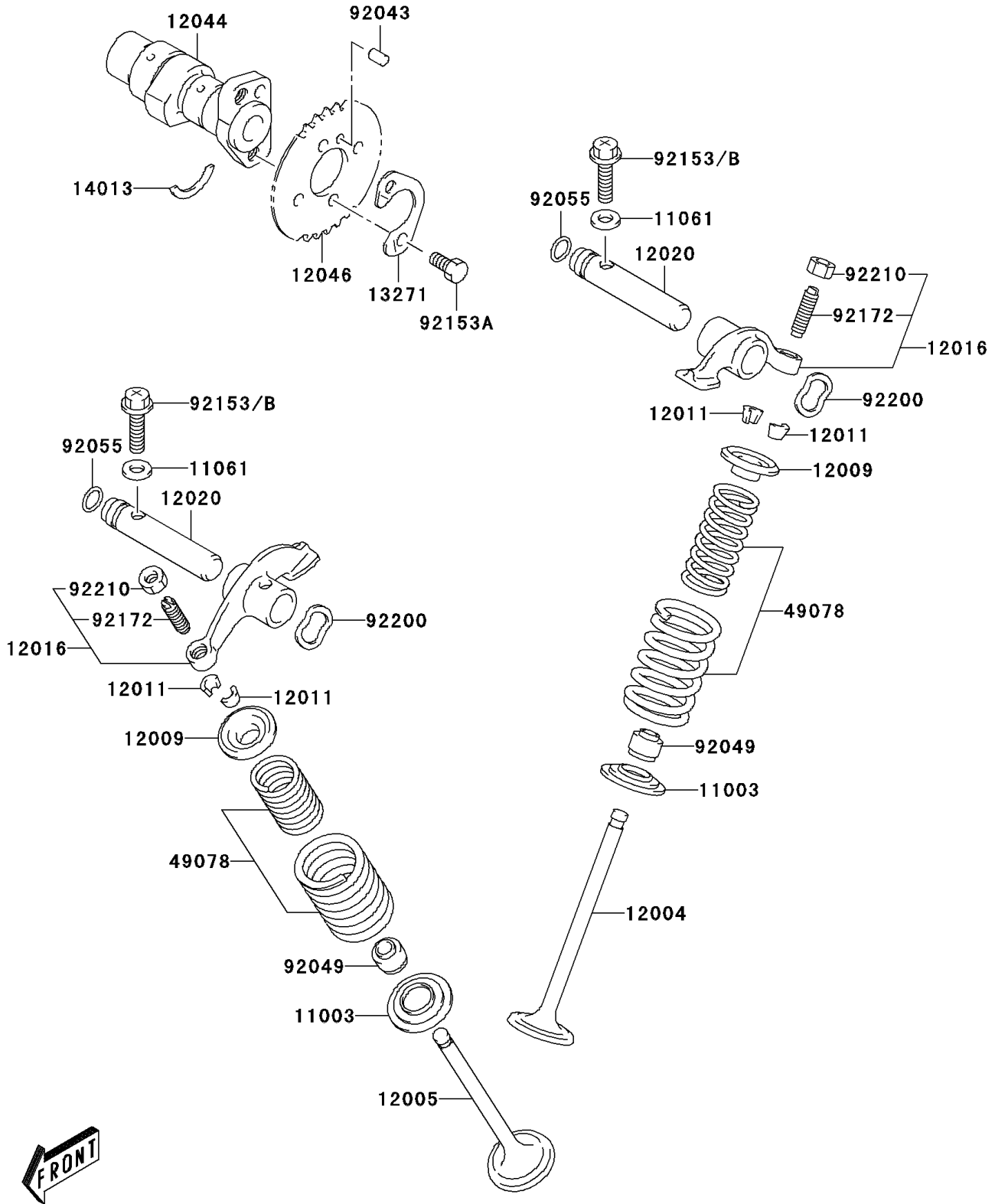

2004 KLX125L PARTS LIST

Valve(s)/Camshaft(s)

| ITEM NAME | PART NUMBER | QUANTITY |
|--------------------------------------|-------------|----------|
| SEAT-VALVE (Ref # 11003) | 11003-S002 | 2 |
| GASKET,5.8X13X1.2 (Ref # 11061) | 11061-S001 | 2 |
| VALVE-INTAKE (Ref # 12004) | 12004-S003 | 1 |
| VALVE-EXHAUST (Ref # 12005) | 12005-S003 | 1 |
| RETAINER-VALVE SPRING (Ref # 12009) | 12009-S002 | 2 |
| COLLET (Ref # 12011) | 12011-S002 | 4 |
| ARM-ROCKER (Ref # 12016) | 12016-S005 | 2 |
| SHAFT-ROCKER (Ref # 12020) | 12020-S003 | 2 |
| CAMSHAFT-VALVE (Ref # 12044) | 12044-S002 | 1 |
| SPROCKET,CAMSHAFT (Ref # 12046) | 12046-S004 | 1 |
| PLATE (Ref # 13271) | 13271-S018 | 1 |
| RING-POSITION,CAMSHAFT (Ref # 14013) | 14013-S001 | 1 |
| SPRING-ENGINE VALVE (Ref # 49078) | 49078-S002 | 2 |
| PIN,5X8 (Ref # 92043) | 92043-S008 | 1 |
| SEAL-OIL (Ref # 92049) | 92049-S021 | 2 |
| RING-O,D=1.9 (Ref # 92055) | 92055-S033 | 2 |
| BOLT (Ref # 92153A) | 92153-S099 | 2 |
| BOLT (Ref # 92153B) | 92153-S133 | 2 |
| SCREW (Ref # 92172) | 92172-S096 | 2 |
| WASHER (Ref # 92200) | 92200-S057 | 2 |
| NUT (Ref # 92210) | 92210-S049 | 2 |