

2004 KLX300R PARTS DIAGRAM

Cylinder Head

E1111

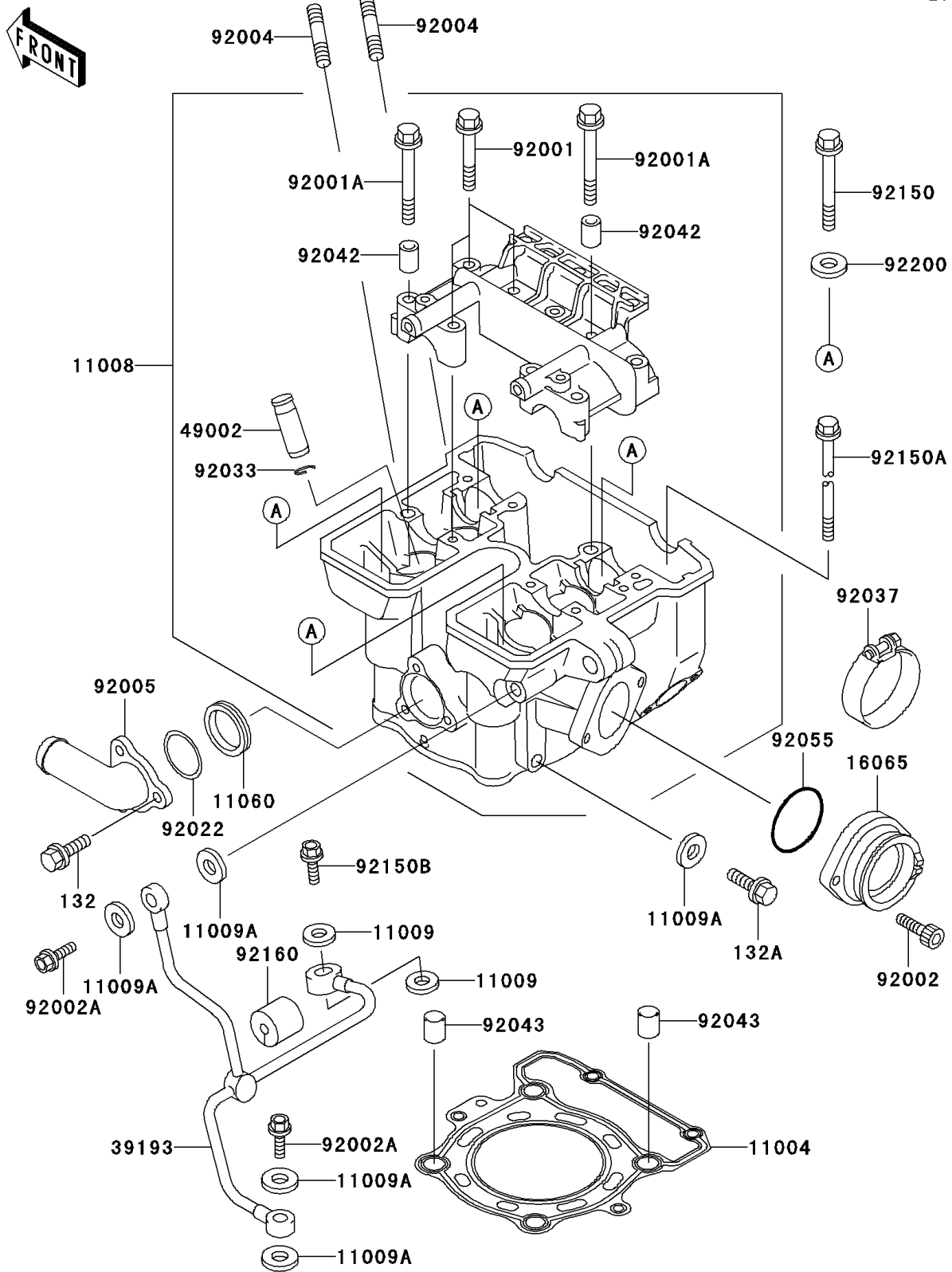

2004 KLX300R PARTS LIST

Cylinder Head

| ITEM NAME | PART NUMBER | QUANTITY |
|---|-------------|----------|
| BOLT-FLANGED-SMALL (Ref # 132) | 132Y0612 | 3 |
| BOLT-FLANGED-SMALL (Ref # 132A) | 132Y0810 | 1 |
| GASKET-HEAD (Ref # 11004) | 11004-1314 | 1 |
| HEAD-COMP-CYLINDER (Ref # 11008) | 11008-1317 | 1 |
| GASKET,10X14.5X1.5 (Ref # 11009) | 11009-1105 | 2 |
| GASKET,OIL PIPE,8.2X14X1.0 (Ref # 11009A) | 11009-1344 | 5 |
| GASKET,THERMOSTAT (Ref # 11060) | 11060-1300 | 1 |
| HOLDER-CARBURETOR (Ref # 16065) | 16065-1283 | 1 |
| PIPE-OIL (Ref # 39193) | 39193-1029 | 1 |
| GUIDE-VALVE (Ref # 49002) | 49002-1126 | AR |
| BOLT,FLANGED,6X38 (Ref # 92001) | 92001-1105 | 6 |
| BOLT,6X46 (Ref # 92001A) | 92001-1872 | 2 |
| BOLT,6X16 (Ref # 92002) | 92002-1143 | 2 |
| BOLT,BANJO,8X20 (Ref # 92002A) | 92002-1618 | 2 |
| STUD,8X22 (Ref # 92004) | 92004-1217 | 2 |
| FITTING (Ref # 92005) | 92005-1258 | 1 |
| WASHER,25.3X30X1 (Ref # 92022) | 92022-161 | 1 |
| RING-SNAP (Ref # 92033) | 92033-1247 | 4 |
| CLAMP,ID=53,BLACK (Ref # 92037) | 92037-1304 | 1 |
| PIN,DOWEL,6.3X8X14 (Ref # 92042) | 92042-007 | 2 |
| PIN,10.1X12X14 (Ref # 92043) | 92043-4009 | 2 |
| RING-O (Ref # 92055) | 92055-1255 | 1 |
| BOLT,10X165 (Ref # 92150) | 92150-1368 | 4 |
| BOLT,6X135 (Ref # 92150A) | 92150-1552 | 2 |
| BOLT,BANJO,10X23 (Ref # 92150B) | 92150-1641 | 1 |
| DAMPER,6.3X22X20 (Ref # 92160) | 92160-1013 | 1 |
| WASHER,10.5X19X2.3 (Ref # 92200) | 92200-1042 | 4 |