

2009 Ninja® ZX™-6R PARTS DIAGRAM

Fuel Tank

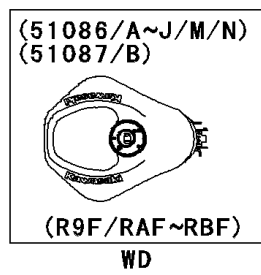

(51086)	Orange
(51086A/F)	Red
(51086B/G/M/N)	Green
(51086C/H)	M. D. Black
(51086D/I)	C. S. Blue
(51086E/J)	M. S. Black
(51087/B)	Ebony

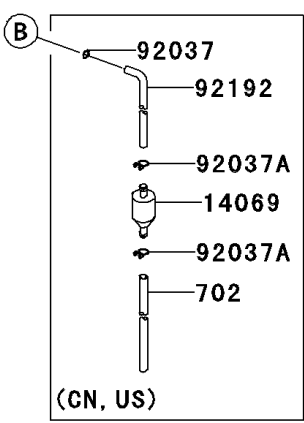
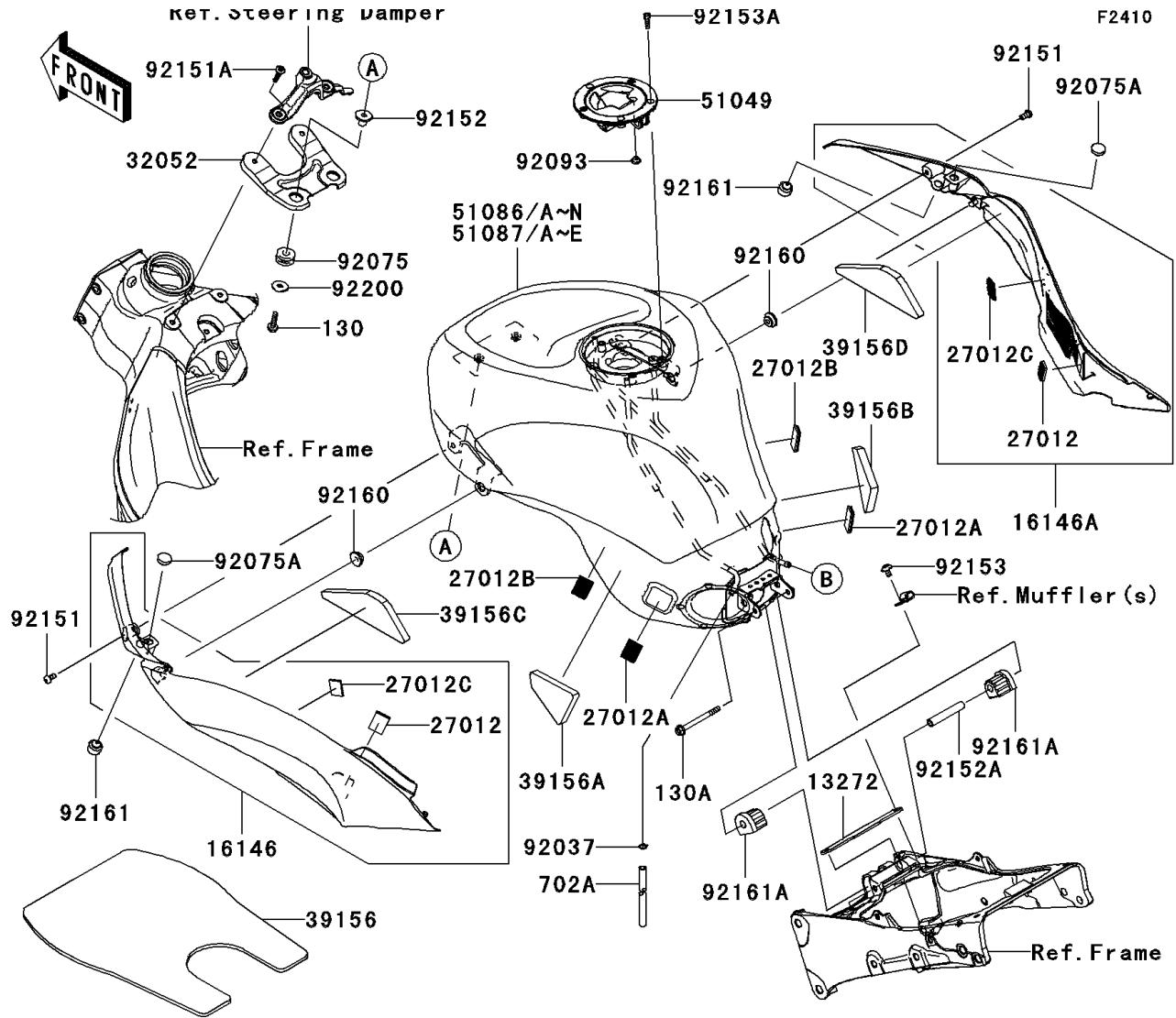
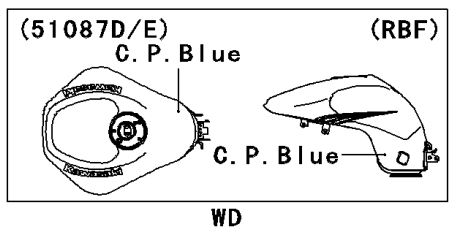
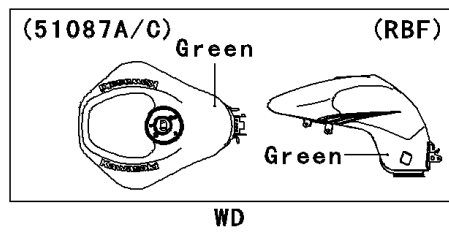
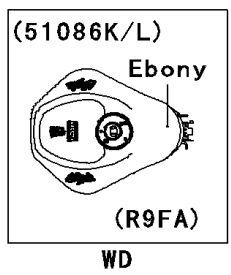

2009 Ninja® ZX™-6R PARTS LIST

Fuel Tank

ITEM NAME	PART NUMBER	QUANTITY
PLATE,FUEL TANK,RR (Ref # 13272)	13272-0505	1
BREATHER,FUEL TANK (Ref # 14069)	14069-1004	1
COVER-ASSY,KNEE GRIP,LH (Ref # 16146)	16146-0112	1
COVER-ASSY,KNEE GRIP,RH (Ref # 16146A)	16146-0113	1
HOOK (Ref # 27012)	27012-0091	2
HOOK (Ref # 27012A)	27012-0115	2
HOOK (Ref # 27012B)	27012-0170	2
HOOK (Ref # 27012C)	27012-0171	2
BRACKET-TANK,FR (Ref # 32052)	32052-0131	1
PAD,FUEL TANK (Ref # 39156)	39156-0469	1
PAD,FUEL TANK,LH (Ref # 39156A)	39156-0507	1
PAD,FUEL TANK,RH (Ref # 39156B)	39156-0508	1
PAD,KNEE GRIP,LH (Ref # 39156C)	39156-0511	1
PAD,KNEE GRIP,RH (Ref # 39156D)	39156-0512	1
CAP-TANK,FUEL (Ref # 51049)	51049-0030	1
TANK-COMP-FUEL,C.B.ORANGE (Ref # 51086)	51086-5190-17L	1
TANK-COMP-FUEL,L.GREEN (Ref # 51086B)	51086-5190-777	1
TANK-COMP-FUEL,M.D,BLACK (Ref # 51086C)	51086-5191-17K	1
TANK-COMP-FUEL,C.S.BLUE (Ref # 51086D)	51086-5191-25V	1
TANK-COMP-FUEL,L.GREEN (Ref # 51086G)	51086-5192-777	1
TANK-COMP-FUEL,M.D,BLACK (Ref # 51086H)	51086-5193-17K	1
TANK-COMP-FUEL,C.S.BLUE (Ref # 51086I)	51086-5193-25V	1
CLAMP,TUBE (Ref # 92037)	92037-010	1
CLAMP,TUBE (Ref # 92037A)	92037-147	2
DAMPER (Ref # 92075)	92075-1690	2
DAMPER (Ref # 92075A)	92075-1983	2
SEAL,FUEL TANK CAP (Ref # 92093)	92093-1030	1
BOLT,SOCKET,6X12 (Ref # 92151)	92151-1219	2
BOLT,SOCKET,6X30 (Ref # 92151A)	92151-1605	2

2009 Ninja® ZX™-6R PARTS LIST

Fuel Tank

ITEM NAME	PART NUMBER	QUANTITY
COLLAR (Ref # 92152)	92152-0091	2
COLLAR,6.8X10X60 (Ref # 92152A)	92152-1182	1
BOLT,SOCKET,6X10 (Ref # 92153)	92153-0410	1
BOLT,SOCKET,5X16 (Ref # 92153A)	92153-1616	3
DAMPER (Ref # 92160)	92160-1613	2
DAMPER (Ref # 92161)	92161-0738	2
DAMPER,FUEL TANK,RR (Ref # 92161A)	92161-1330	2
TUBE,BREATHER (Ref # 92192)	92192-0798	1
WASHER,6.5X22X1.6 (Ref # 92200)	92200-1087	2
BOLT-FLANGED,6X22 (Ref # 130)	130BA0622	2
BOLT-FLANGED,6X70 (Ref # 130A)	130BB0670	1
TUBE-RUBBER,6X9X660 (Ref # 702)	702A06660	1
TUBE-RUBBER,6X850 (Ref # 702A)	702A06850	1
CLAMP,TUBE (Ref # 92037)	92037-010	2