

2013 VERSYS® 1000 (European) PARTS DIAGRAM

Chassis Electrical Equipment

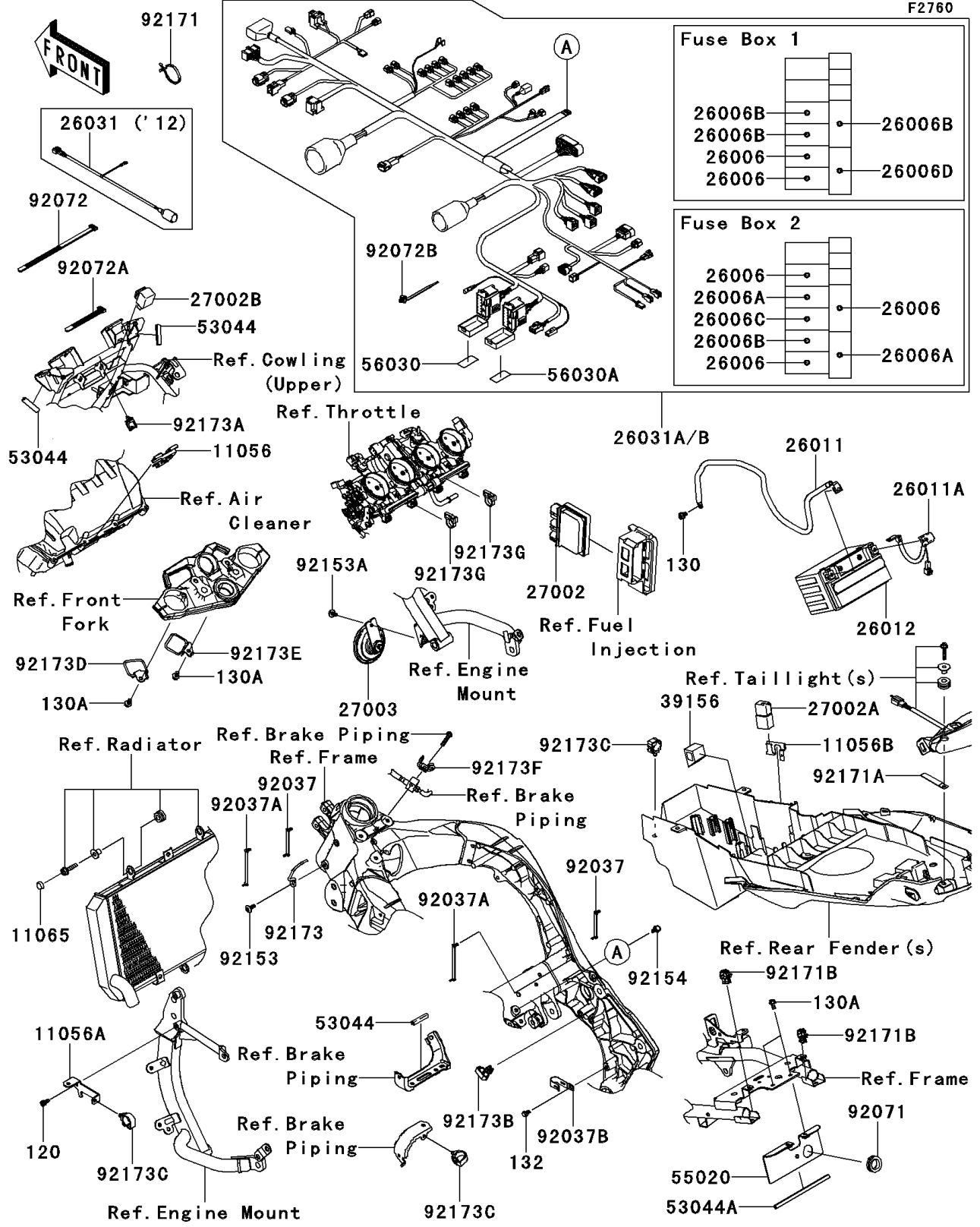

2013 VERSYS® 1000 (European) PARTS LIST

Chassis Electrical Equipment

ITEM NAME	PART NUMBER	QUANTITY
BRACKET,AIR BOX (Ref # 11056)	11056-1132	1
BRACKET,ENGINE (Ref # 11056A)	11056-1478	1
BRACKET,RELAY (Ref # 11056B)	11056-1735	1
CAP,BOLT (Ref # 11065)	11065-0752	1
FUSE,MINI BLADE,15A,BLUE (Ref # 26006)	26006-0001	5
FUSE,MINI BLADE,25A,NATURAL (Ref # 26006A)	26006-0020	2
FUSE,MINI BLADE,7.5A,BROWN (Ref # 26006B)	26006-0055	4
FUSE,MINI BLADE,5A,TAN (Ref # 26006C)	26006-1077	1
FUSE,MINI BLADE,30A,GREEN (Ref # 26006D)	26006-1080	1
WIRE-LEAD,BATTERY(-) (Ref # 26011)	26011-0737	1
WIRE-LEAD,BATTERY(+) (Ref # 26011A)	26011-0758	1
BATTERY,YTX9-BS,12V 8AH (Ref # 26012)	26012-0088	1
HARNESS,MAIN (Ref # 26031B)	26031-1506	1
RELAY-ASSY (Ref # 27002)	27002-0007	1
RELAY-ASSY (Ref # 27002A)	27002-1086	1
RELAY-ASSY,SIGNAL LAMP (Ref # 27002B)	27002-1097	1
HORN (Ref # 27003)	27003-0066	1
PAD (Ref # 39156)	39156-0812	1
TRIM,L=40 (Ref # 53044)	53044-0012	3
TRIM,GUARD (Ref # 53044A)	53044-0558	1
GUARD,HARNESS (Ref # 55020)	55020-0857	1
LABEL,FUSE BOX 1 (Ref # 56030)	56030-0737	1
LABEL,FUSE BOX 2 (Ref # 56030A)	56030-0738	1
CLAMP,SPEED,L=58 (Ref # 92037)	92037-1163	2
CLAMP,SPEED,L=80.5 (Ref # 92037A)	92037-1903	2
CLAMP (Ref # 92037B)	92037-2014	1
GROMMET (Ref # 92071)	92071-3704	1
BAND,L=250 (Ref # 92072)	92072-1237	1
BAND,L=140 (Ref # 92072A)	92072-1293	4

2013 VERSYS® 1000 (European) PARTS LIST

Chassis Electrical Equipment

ITEM NAME	PART NUMBER	QUANTITY
BAND (Ref # 92072B)	92072-1414	10
BOLT,SOCKET,6X16 (Ref # 92153)	92153-1526	1
BOLT,SOCKET,6X12 (Ref # 92153A)	92153-1948	1
BOLT,FLANGED,6X16 (Ref # 92154)	92154-0551	1
CLAMP,CABLE (Ref # 92171)	92171-0226	1
CLAMP (Ref # 92171A)	92171-0652	1
CLAMP (Ref # 92171B)	92171-1722	2
CLAMP (Ref # 92173)	92173-0182	1
CLAMP (Ref # 92173A)	92173-0229	1
BOLT-SOCKET,6X12 (Ref # 120)	120CA0612	1
BOLT-FLANGED,6X10 (Ref # 130)	130BA0610	1
BOLT-FLANGED,6X12 (Ref # 130A)	130BA0612	4
BOLT-FLANGED-SMALL,6X10 (Ref # 132)	132BA0610	1
CLAMP,CLIP (Ref # 92173B)	92173-0799	1
CLAMP (Ref # 92173C)	92173-0861	3
CLAMP,UPP BRACKET,LH (Ref # 92173D)	92173-0874	1
CLAMP,UPP BRACKET,RH (Ref # 92173E)	92173-0875	1
CLAMP (Ref # 92173F)	92173-0880	1
CLAMP (Ref # 92173G)	92173-0970	2