

2017 Ninja 650 ABS PARTS DIAGRAM

Chassis Electrical Equipment

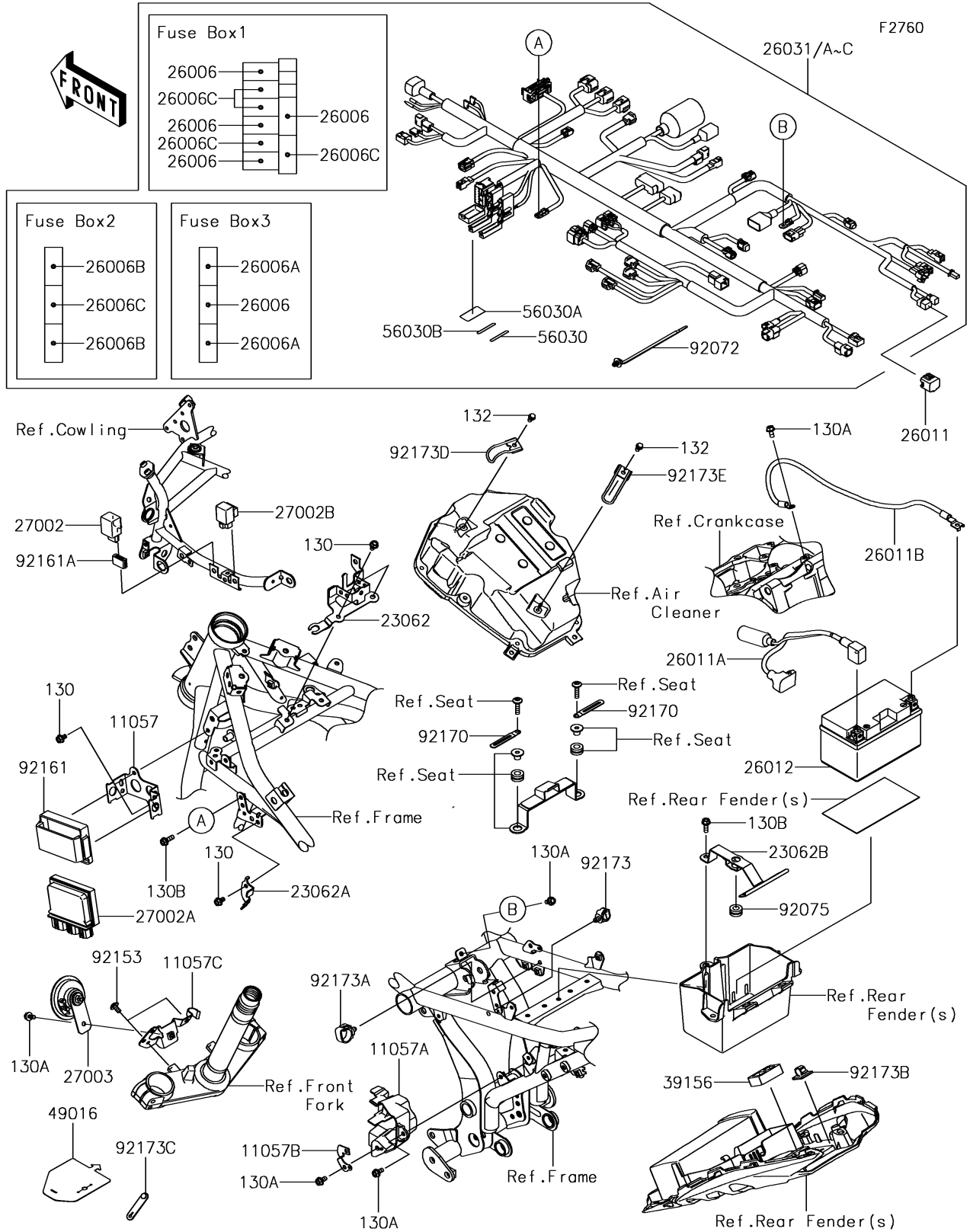

2017 Ninja 650 ABS PARTS LIST

Chassis Electrical Equipment

ITEM NAME	PART NUMBER	QUANTITY
BRACKET,RELAY BOX (Ref # 11057)	11057-0122	1
BRACKET,MAGNETIC SW. (Ref # 11057A)	11057-0137	1
BRACKET,COUPLER (Ref # 11057B)	11057-0138	1
BRACKET,HORN (Ref # 11057C)	11057-0184	1
BRACKET-COMP,VD SENSOR (Ref # 23062)	23062-0875	1
BRACKET-COMP,FUSE BOX (Ref # 23062A)	23062-0882	1
BRACKET-COMP,BATTERY (Ref # 23062B)	23062-0899	1
FUSE,MINI BLADE,15A,BLUE (Ref # 26006)	26006-0001	5
FUSE,MINI BLADE,25A,NATURAL (Ref # 26006A)	26006-0020	2
FUSE,MINI BLADE,5A,TAN (Ref # 26006B)	26006-1077	2
FUSE,MINI BLADE,10A,RED (Ref # 26006C)	26006-1078	5
WIRE-LEAD,CONNECTOR COVER (Ref # 26011)	26011-0275	1
WIRE-LEAD,BATTERY(+) (Ref # 26011A)	26011-0980	1
WIRE-LEAD,BATTERY(-) (Ref # 26011B)	26011-0981	1
BATTERY,YTZ10S,12V 8.6AH (Ref # 26012)	26012-0564	1
HARNESS,MAIN (Ref # 26031)	26031-2269	1
HARNESS,MAIN (Ref # 26031A)	26031-2270	1
RELAY-ASSY,SIGNAL LAMP (Ref # 27002)	27002-0006	1
RELAY-ASSY,BOX (Ref # 27002A)	27002-0025	1
RELAY-ASSY (Ref # 27002B)	27002-1062	1
HORN (Ref # 27003)	27003-0065	1
PAD,CONNECTOR (Ref # 39156)	39156-2136	1
COVER-SEAL (Ref # 49016)	49016-0645	1
LABEL,FUSE BOX3 (Ref # 56030)	56030-0400	1
LABEL,FUSE BOX1 (Ref # 56030A)	56030-0705	1
LABEL,FUSE BOX2 (Ref # 56030B)	56030-0879	1
BAND,OS170-FT7(BLACK) (Ref # 92072)	92072-1414	AR
DAMPER (Ref # 92075)	92075-1880	1
BOLT,SOCKET,6X12 (Ref # 92153)	92153-1948	2

2017 Ninja 650 ABS PARTS LIST

Chassis Electrical Equipment

ITEM NAME	PART NUMBER	QUANTITY
DAMPER,RELAY BOX (Ref # 92161)	92161-0203	1
DAMPER,15X25X8.5 (Ref # 92161A)	92161-1443	1
CLAMP (Ref # 92170)	92170-1514	2
CLAMP,12MM DIA. (Ref # 92173)	92173-0736	1
CLAMP (Ref # 92173A)	92173-0861	1
BOLT-FLANGED,6X10 (Ref # 130)	130BA0610	5
BOLT-FLANGED,6X12 (Ref # 130A)	130BA0612	5
BOLT-FLANGED,6X18 (Ref # 130B)	130BA0618	2
BOLT-FLANGED-SMALL,6X10 (Ref # 132)	132BA0610	2
CLAMP,DRAIN (Ref # 92173B)	92173-1055	1
CLAMP,RUBBER PLATE (Ref # 92173C)	92173-1229	1
CLAMP,A/C CASE,FR (Ref # 92173D)	92173-1586	1
CLAMP,A/C CASE,RR (Ref # 92173E)	92173-1587	1