

1990 650 SX PARTS DIAGRAM

Engine Hood

(F3142)

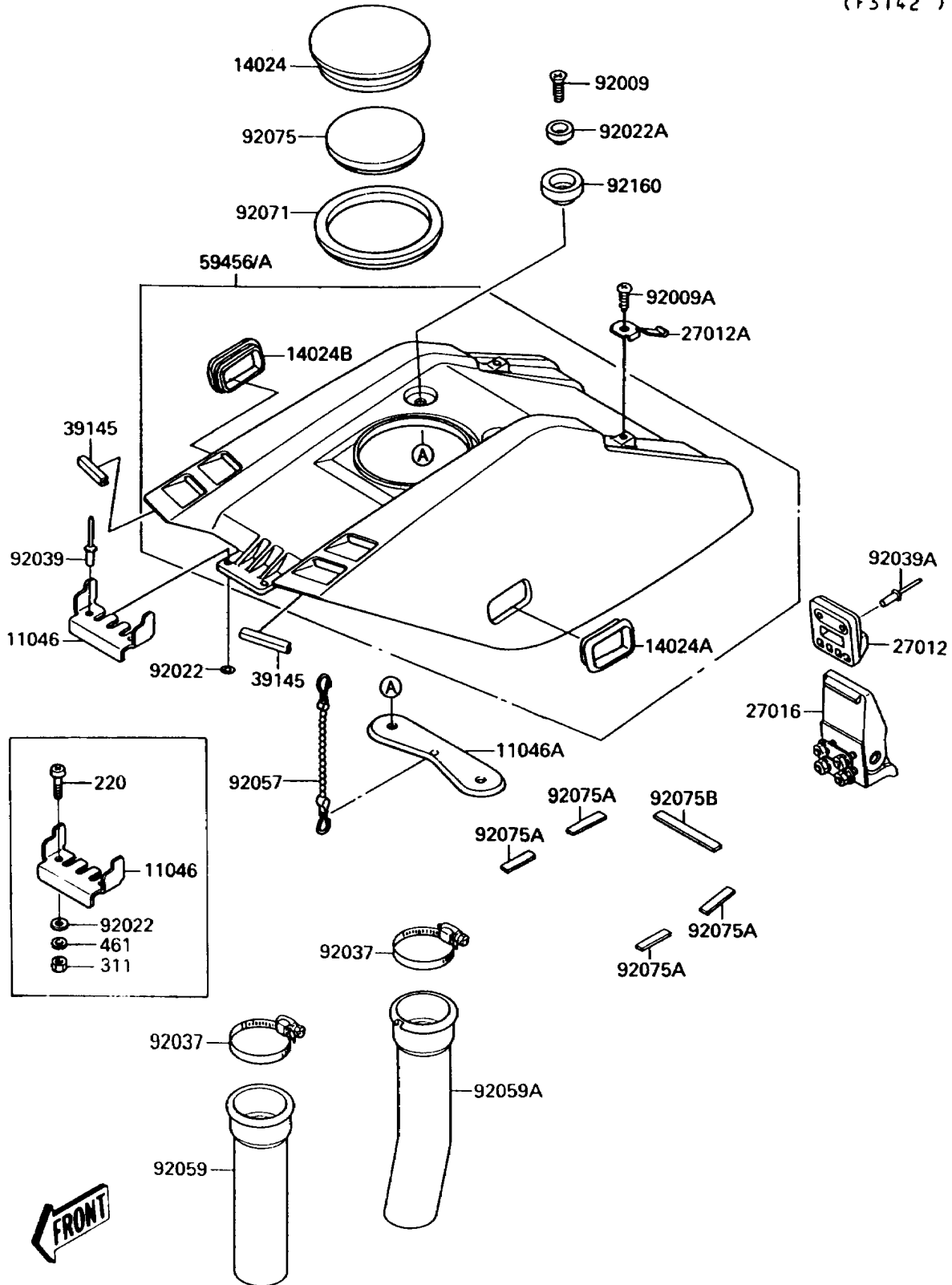

1990 650 SX PARTS LIST

Engine Hood

ITEM NAME	PART NUMBER	QUANTITY
BRACKET (Ref # 11046)	11046-3703	1
BRACKET (Ref # 11046A)	11046-3748	1
COVER (Ref # 14024)	14024-3748	1
COVER,LH,J.WHITE (Ref # 14024A)	14024-3771-8C	1
COVER,RH,J.WHITE (Ref # 14024B)	14024-3772-8C	1
SCREW-PAN-CROS,5X20 (Ref # 220)	220R0520	2
HOOK (Ref # 27012)	27012-3711	1
HOOK,FOR PAD (Ref # 27012A)	27012-3716	2
LOCK-ASSY (Ref # 27016)	27016-3703	1
NUT-HEX,5MM (Ref # 311)	311R0500	2
TRIM-SEAL (Ref # 39145)	39145-3708	2
WASHER-SPRING,5MM (Ref # 461)	461S0500	2
HOOD-COMP-ENGINE,J.WHITE (Ref # 59456A)	59456-3714-8C	1
SCREW,6X25 (Ref # 92009)	92009-3717	2
SCREW,TAPPING (Ref # 92009A)	92011-561	2
WASHER,5X16X1.5 (Ref # 92022)	92022-3041	2
WASHER (Ref # 92022A)	92022-3732	2
CLAMP (Ref # 92037)	92037-3738	2
RIVET (Ref # 92039A)	92039-3722	2
CHAIN,COVER,L=100 (Ref # 92057)	92057-3704	1
TUBE (Ref # 92059)	92059-3803	1
TUBE (Ref # 92059A)	92059-3815	1
GROMMET (Ref # 92071)	92071-3742	1
DAMPER (Ref # 92075)	92075-3737	1
DAMPER,DUCT,RR,LH (Ref # 92075A)	92075-3744	4
DAMPER,DUCT,REAR (Ref # 92075B)	92075-3746	1
DAMPER (Ref # 92160)	92160-3709	2