

1989 Mojave 250 PARTS DIAGRAM

Transmission

E1361

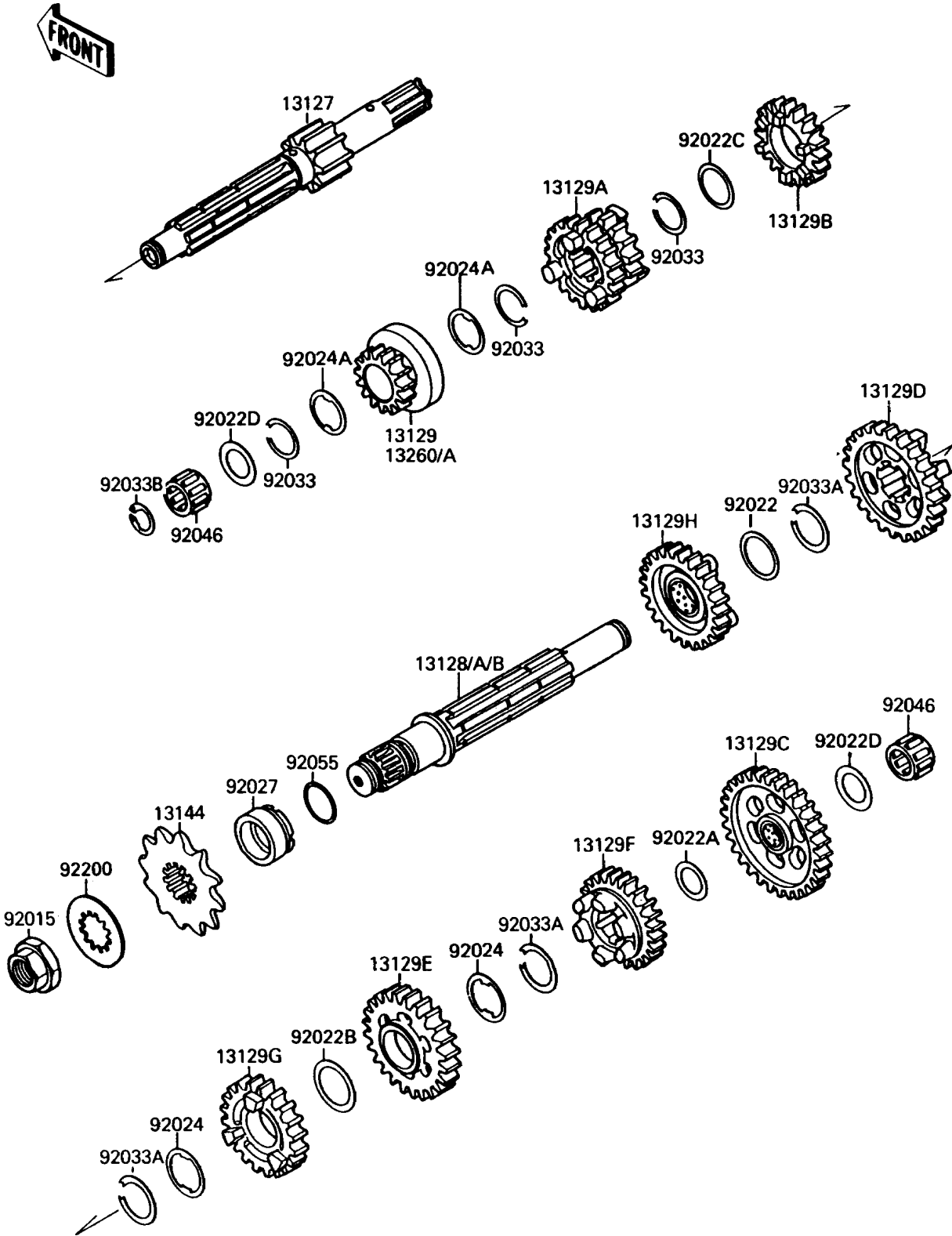

1989 Mojave 250 PARTS LIST

Transmission

ITEM NAME	PART NUMBER	QUANTITY
SHAFT-TRANSMISSION INPUT (Ref # 13127)	13127-1139	1
SHAFT-TRANSMISSION OUTPUT (Ref # 13128)	13128-1135	1
SHAFT-TRANSMISSION OUTPUT (Ref # 13128B)	13128-1171	1
GEAR,INPUT 2ND,15T (Ref # 13129)	13129-1797	1
GEAR,INPUT 3RD&5TH,16T&20T (Ref # 13129A)	13129-1798	1
GEAR,INPUT 4TH,20T (Ref # 13129B)	13129-1799	1
GEAR,OUTPUT LOW,30T (Ref # 13129C)	13129-1800	1
GEAR,OUTPUT 2ND,30T (Ref # 13129D)	13129-1801	1
GEAR,OUTPUT 3RD,24T (Ref # 13129E)	13129-1802	1
GEAR,OUTPUT 4TH,25T (Ref # 13129F)	13129-1803	1
GEAR,OUTPUT 5TH,21T (Ref # 13129G)	13129-1804	1
GEAR,OUTPUT REVERSE,24T (Ref # 13129H)	13129-1805	1
SPROCKET-OUTPUT,12T (Ref # 13144)	13144-1127	1
GEAR,INPUT 2ND,15T (Ref # 13260A)	13260-1077	1
NUT,20MM (Ref # 92015)	92015-1254	1
WASHER,25.3X30X0.5 (Ref # 92022)	92022-159	1
WASHER,17.3X25X0.5 (Ref # 92022A)	92022-1614	1
WASHER,25.3X32X1 (Ref # 92022B)	92022-1800	1
WASHER,22.3X27X0.5 (Ref # 92022C)	92022-198	1
WASHER,17.3X28X1 (Ref # 92022D)	92022-255	2
WASHER,TOOTHED,22.5X31X0.5 (Ref # 92024)	92024-038	2
WASHER,TOOTHED,22.5X27X0.5 (Ref # 92024A)	92024-039	2
COLLAR,25X32X15.3 (Ref # 92027)	92027-1800	1
RING-SNAP,20X25.5X1.2 (Ref # 92033)	92033-025	3
RING-SNAP,24MM (Ref # 92033A)	92033-026	3
RING-SNAP (Ref # 92033B)	92033-032	1
BEARING-NEEDLE,K17X25X13.8X1 (Ref # 92046)	92046-1156	2
RING-O,21.5MM (Ref # 92055)	92055-1293	1
WASHER (Ref # 92200)	92200-1065	1