

2018 NINJA® ZX™-10RR PARTS DIAGRAM

Transmission

E1361

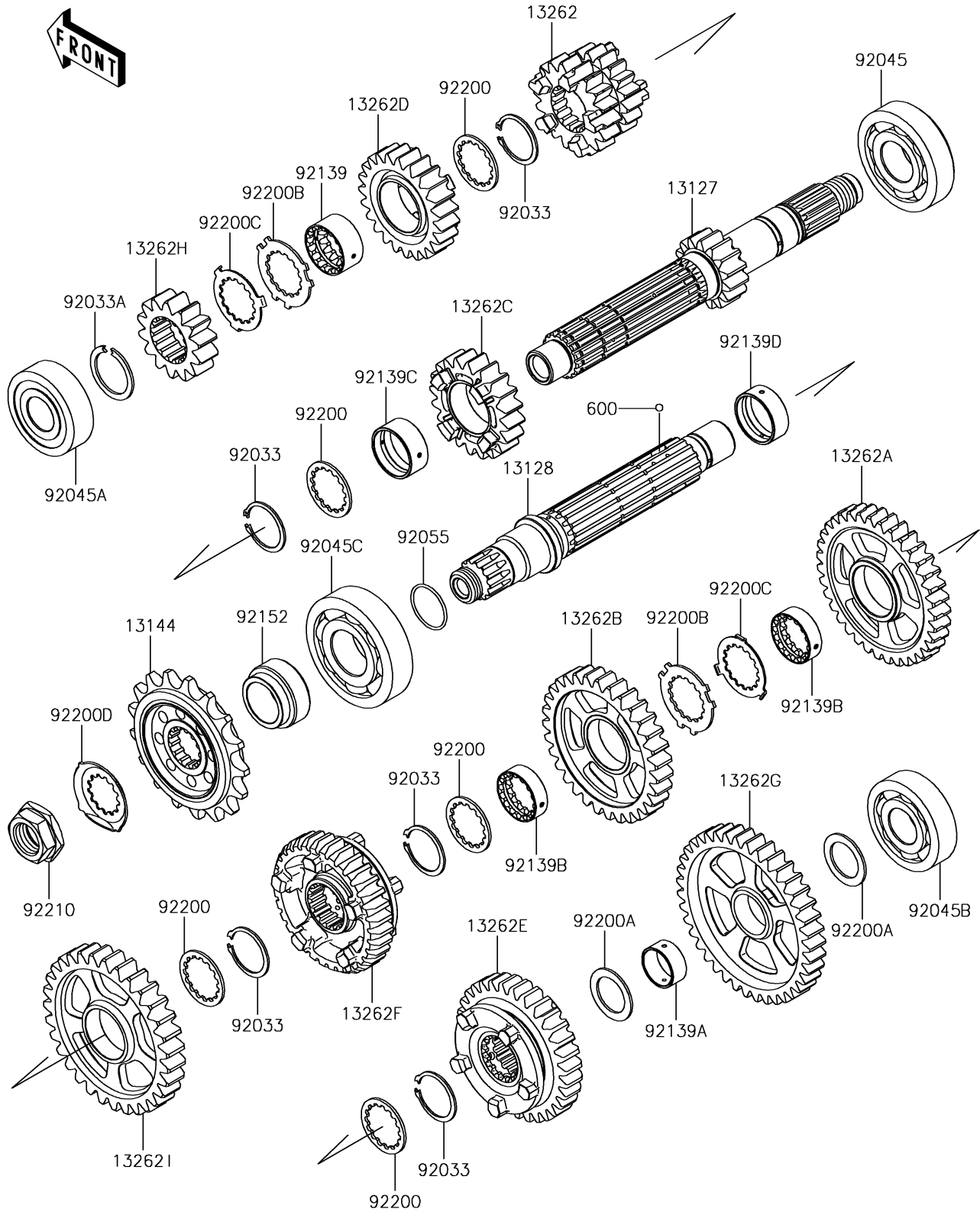

2018 NINJA® ZX™-10RR PARTS LIST

Transmission

| ITEM NAME | PART NUMBER | QUANTITY |
|--------------------------------------------|-------------|----------|
| SHAFT-TRANSMISSION INPUT,15T (Ref # 13127) | 13127-0671 | 1 |
| SHAFT-TRANSMISSION OUTPUT (Ref # 13128) | 13128-0670 | 1 |
| SPROCKET-OUTPUT,17T,#525 (Ref # 13144) | 13144-0004 | 1 |
| GEAR,INPUT 3RD&4TH,18T&18T (Ref # 13262) | 13262-1188 | 1 |
| GEAR,OUTPUT 3RD,35T (Ref # 13262A) | 13262-1192 | 1 |
| GEAR,OUTPUT 4TH,31T (Ref # 13262B) | 13262-1193 | 1 |
| GEAR,INPUT 5TH,20T (Ref # 13262C) | 13262-1203 | 1 |
| GEAR,INPUT 6TH,23T (Ref # 13262D) | 13262-1204 | 1 |
| GEAR,OUTPUT 5TH,31T (Ref # 13262E) | 13262-1205 | 1 |
| GEAR,OUTPUT 6TH,32T (Ref # 13262F) | 13262-1206 | 1 |
| GEAR,OUTPUT LOW,39T (Ref # 13262G) | 13262-1207 | 1 |
| GEAR,INPUT 2ND,14T (Ref # 13262H) | 13262-1210 | 1 |
| GEAR,OUTPUT 2ND,31T (Ref # 13262I) | 13262-1211 | 1 |
| BALL-STEEL,5/32 (Ref # 600) | 600A0500 | 3 |
| RING-SNAP,25.9X30.6X1.2 (Ref # 92033) | 92033-1037 | 5 |
| RING-SNAP,T=1.5 (Ref # 92033A) | 92033-1249 | 1 |
| BEARING-BALL,830045-5SH2 (Ref # 92045) | 92045-0047 | 1 |
| BEARING-BALL,DG2152RDDSH2 (Ref # 92045A) | 92045-0048 | 1 |
| BEARING-BALL,63/22LU (Ref # 92045B) | 92045-0156 | 1 |
| BEARING-BALL,63/28 (Ref # 92045C) | 92045-1189 | 1 |
| RING-O,21.5X1.5 (Ref # 92055) | 92055-1293 | 1 |
| BUSHING,GEAR,6TH IN (Ref # 92139) | 92139-0036 | 1 |
| BUSHING,GEAR,LOW OUT (Ref # 92139A) | 92139-0038 | 1 |
| BUSHING,25.0X31.0X9.4 (Ref # 92139B) | 92139-0309 | 2 |
| BUSHING,28.1X31.0X13.5 (Ref # 92139C) | 92139-0324 | 1 |
| BUSHING,28.1X31.0X11.5 (Ref # 92139D) | 92139-0734 | 1 |
| COLLAR (Ref # 92152) | 92152-0885 | 1 |
| WASHER,28.3X34.0X1.6 (Ref # 92200) | 92200-0050 | 5 |
| WASHER,22.1X32.0X1.4 (Ref # 92200A) | 92200-0138 | 2 |

2018 NINJA® ZX™-10RR PARTS LIST

Transmission

| ITEM NAME | PART NUMBER | QUANTITY |
|-------------------------------------|-------------|----------|
| WASHER,25.8X40.5X1.5 (Ref # 92200B) | 92200-1522 | 2 |
| WASHER,25.2X37.0X1.0 (Ref # 92200C) | 92200-1523 | 2 |
| WASHER (Ref # 92200D) | 92200-1720 | 1 |
| NUT,20MM (Ref # 92210) | 92210-0850 | 1 |