

2006 Ninja® ZX™-14 PARTS DIAGRAM

Clutch Master Cylinder

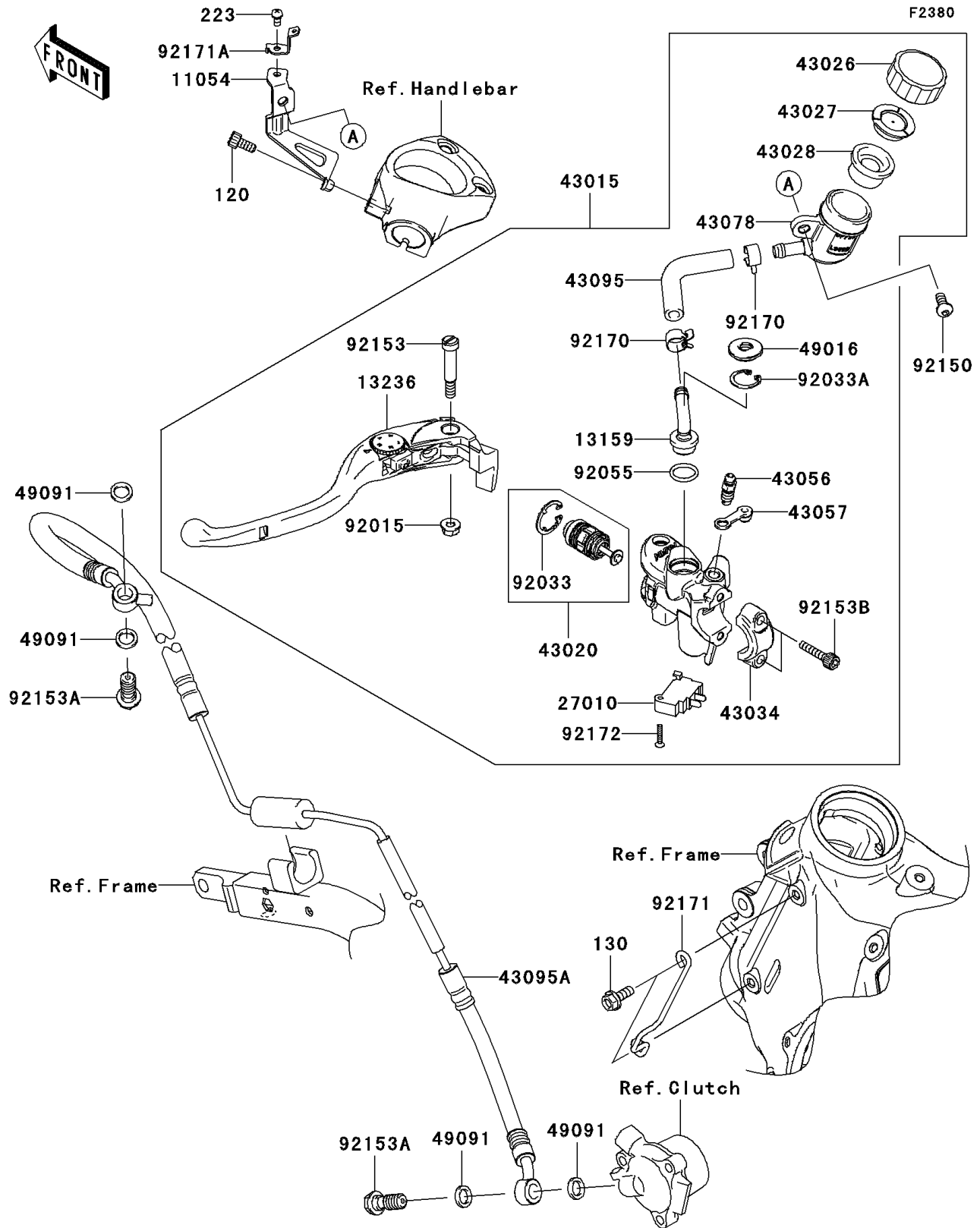

2006 Ninja® ZX™-14 PARTS LIST

Clutch Master Cylinder

| ITEM NAME | PART NUMBER | QUANTITY |
|---|-------------|----------|
| BRACKET,CLUTCH RESERVOIR (Ref # 11054) | 11054-0207 | 1 |
| BOLT-SOCKET,6X12 (Ref # 120) | 120CA0612 | 1 |
| BOLT-FLANGED,6X16 (Ref # 130) | 130BA0616 | 2 |
| CONNECTOR (Ref # 13159) | 13159-1061 | 1 |
| LEVER-COMP,CLUTCH (Ref # 13236) | 13236-0104 | 1 |
| SCREW-PAN-WS-CROS,4X8 (Ref # 223) | 223AA0408 | 1 |
| SWITCH,CLUTCH (Ref # 27010) | 27010-0051 | 1 |
| CYLINDER-ASSY-MASTER,CLUTCH (Ref # 43015) | 43015-0082 | 1 |
| PISTON-COMP-BRAKE (Ref # 43020) | 43020-0004 | 1 |
| CAP-BRAKE (Ref # 43026) | 43026-1070 | 1 |
| PLATE-DIAPHRAGM (Ref # 43027) | 43027-1054 | 1 |
| DIAPHRAGM (Ref # 43028) | 43028-1073 | 1 |
| HOLDER-BRAKE,MASTER CYLINDER (Ref # 43034) | 43034-1016 | 1 |
| BREATHER-BRAKE (Ref # 43056) | 43056-1056 | 1 |
| CAP-BREATHER (Ref # 43057) | 43057-1001 | 1 |
| RESERVOIR (Ref # 43078) | 43078-1102 | 1 |
| HOSE-BRAKE,FR MASTER CYLINDER (Ref # 43095) | 43095-0040 | 1 |
| HOSE-BRAKE,CLUTCH (Ref # 43095A) | 43095-0210 | 1 |
| COVER-SEAL (Ref # 49016) | 49016-1147 | 1 |
| WASHER-SEAL,10.1X14.5X1.5 (Ref # 49091) | 49091-0001 | 4 |
| NUT,FLANGED,6MM,BLACK (Ref # 92015) | 92015-1233 | 1 |
| RING-SNAP (Ref # 92033) | 92033-0034 | 1 |
| RING-SNAP,20.5MM (Ref # 92033A) | 92033-1186 | 1 |
| RING-O,MASTER CYLINDER (Ref # 92055) | 92055-1251 | 1 |
| BOLT,SOCKET,6X14 (Ref # 92150) | 92150-1836 | 1 |
| BOLT,LEVER (Ref # 92153) | 92153-0868 | 1 |
| BOLT,OIL,L=23 (Ref # 92153A) | 92153-1419 | 2 |
| BOLT,SOCKET,6X22 (Ref # 92153B) | 92153-1518 | 2 |
| CLAMP,HOSE (Ref # 92170) | 92170-1091 | 2 |

2006 Ninja® ZX™ -14 PARTS LIST

Clutch Master Cylinder

| ITEM NAME | PART NUMBER | QUANTITY |
|------------------------------------|-------------|----------|
| CLAMP,CLUTCH HOSE (Ref # 92171) | 92171-0633 | 1 |
| CLAMP,RESERVOIR CAP (Ref # 92171A) | 92171-0637 | 1 |
| SCREW,3X16 (Ref # 92172) | 92172-0249 | 1 |