

2019 BRUTE FORCE® 750 4x4i EPS CAMO PARTS DIAGRAM

Front Bevel Gear

E3131

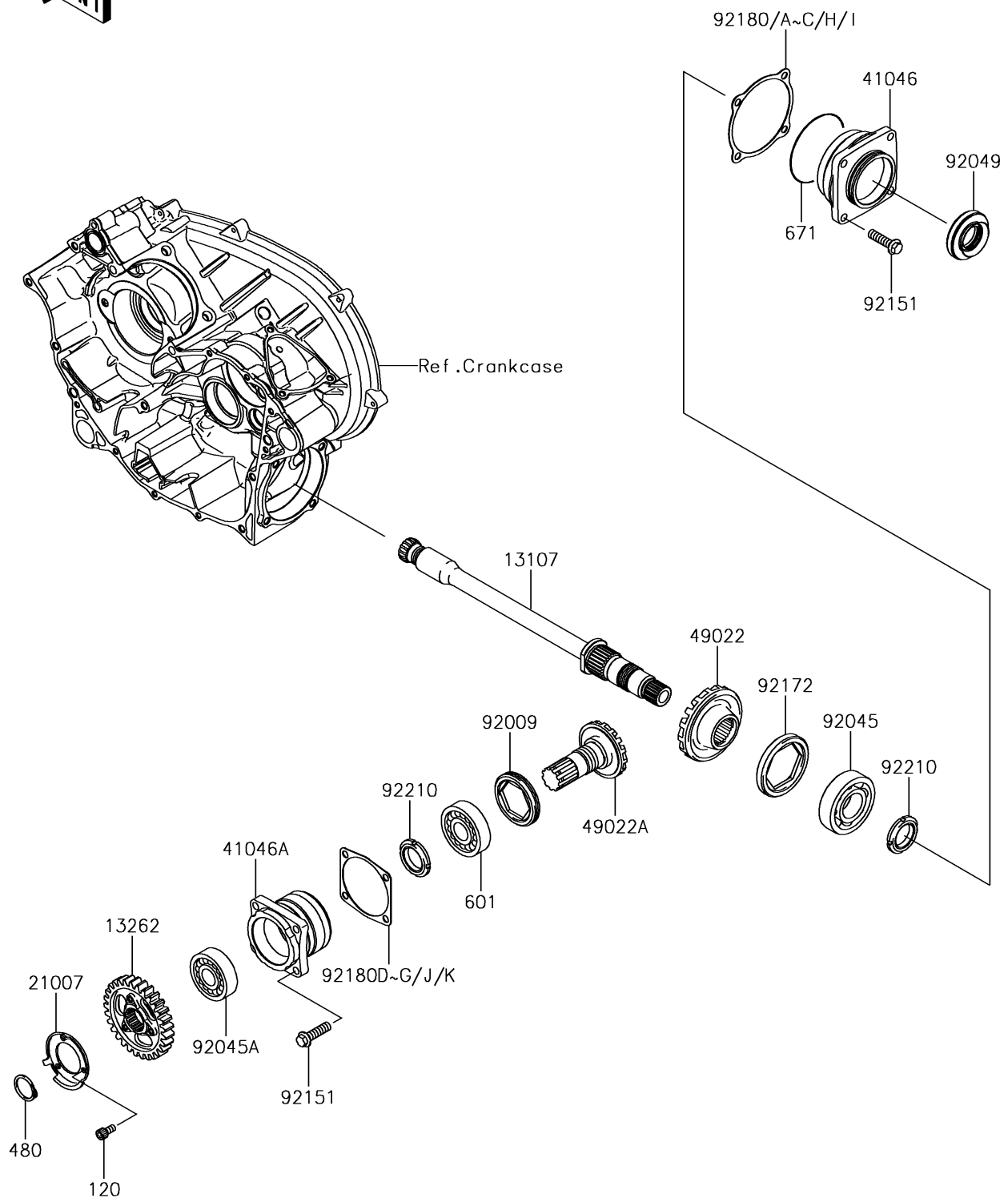

2019 BRUTE FORCE® 750 4x4i EPS CAMO PARTS LIST

Front Bevel Gear

| ITEM NAME | PART NUMBER | QUANTITY |
|---------------------------------------|-------------|----------|
| BOLT-SOCKET,6X12 (Ref # 120) | 120CA0612 | 3 |
| SHAFT,F/R OUTPUT (Ref # 13107) | 13107-0727 | 1 |
| GEAR,OUTPUT,29T (Ref # 13262) | 13262-0960 | 1 |
| ROTOR,REVERSE SENSOR (Ref # 21007) | 21007-1416 | 1 |
| HOUSING-BEARING (Ref # 41046) | 41046-0025 | 1 |
| HOUSING-BEARING (Ref # 41046A) | 41046-1101 | 1 |
| CIRCLIP-TYPE-C,28MM (Ref # 480) | 480J2800 | 1 |
| GEAR-BEVEL,DRIVEN,20T (Ref # 49022) | 49022-0011 | 1 |
| GEAR-BEVEL,DRIVE,12T (Ref # 49022A) | 49022-1192 | 1 |
| BEARING-BALL,#6206C3 (Ref # 601) | 601B6206 | 1 |
| O RING (Ref # 671) | 671D2585 | 1 |
| SCREW,64MM (Ref # 92009) | 92009-1914 | 1 |
| BEARING-BALL,6306SH2 (Ref # 92045) | 92045-1190 | 1 |
| BEARING-BALL,62/28 (Ref # 92045A) | 92045-1207 | 1 |
| SEAL-OIL (Ref # 92049) | 92049-0160 | 1 |
| BOLT-FLANGED-SMALL,8X30 (Ref # 92151) | 92151-1688 | 8 |
| SCREW,SET,75X10 (Ref # 92172) | 92172-0371 | 1 |
| SHIM,DRIVEN,T=0.15 (Ref # 92180) | 92180-1307 | AR |
| SHIM,DRIVEN,T=0.20 (Ref # 92180A) | 92180-1308 | AR |
| SHIM,DRIVEN,T=0.50 (Ref # 92180B) | 92180-1309 | AR |
| SHIM,DRIVEN,T=0.80 (Ref # 92180C) | 92180-1310 | AR |
| SHIM,DRIVE,T=0.15 (Ref # 92180D) | 92180-1311 | AR |
| SHIM,DRIVE,T=0.20 (Ref # 92180E) | 92180-1312 | AR |
| SHIM,DRIVE,T=0.50 (Ref # 92180F) | 92180-1313 | AR |
| SHIM,DRIVE,T=0.80 (Ref # 92180G) | 92180-1314 | AR |
| SHIM,DRIVEN,T=1.00 (Ref # 92180H) | 92180-1349 | AR |
| SHIM,DRIVEN,T=1.20 (Ref # 92180I) | 92180-1350 | AR |
| SHIM,DRIVE,T=1.00 (Ref # 92180J) | 92180-1351 | AR |
| SHIM,DRIVE,T=1.20 (Ref # 92180K) | 92180-1352 | AR |

2019 BRUTE FORCE® 750 4x4i EPS CAMO PARTS LIST

Front Bevel Gear

| ITEM NAME | PART NUMBER | QUANTITY |
|------------------------|-------------|----------|
| NUT,30MM (Ref # 92210) | 92210-1294 | 2 |