

1997 Prairie 400 4X4 PARTS DIAGRAM

Rear Fender(s)

F2172

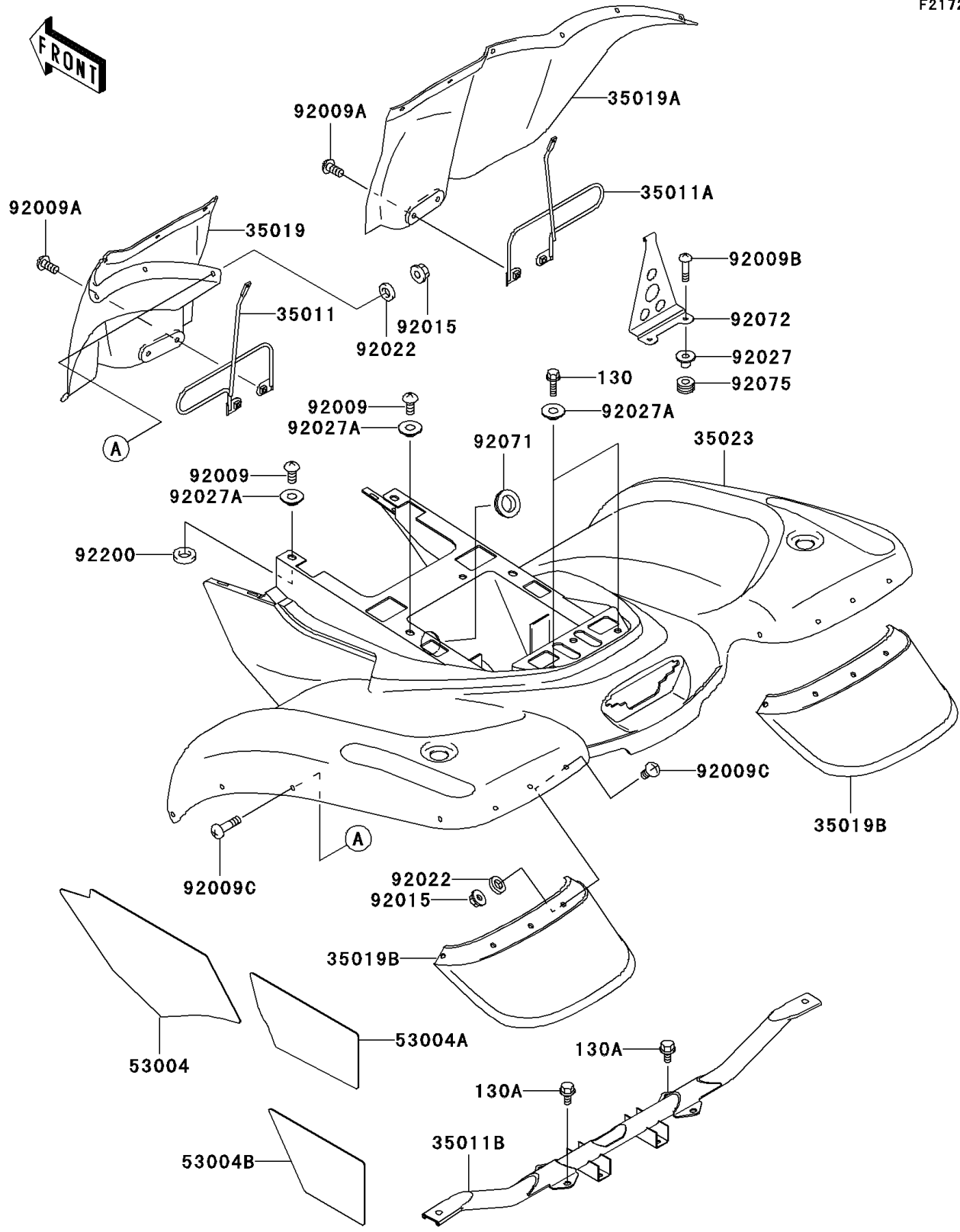

1997 Prairie 400 4X4 PARTS LIST

Rear Fender(s)

| ITEM NAME | PART NUMBER | QUANTITY |
|---|---------------|----------|
| BOLT-FLANGED (Ref # 130) | 130C0618 | 2 |
| BOLT-FLANGED,8X16,BLACK (Ref # 130A) | 130J0816 | 4 |
| STAY,REAR FLAP,LH (Ref # 35011) | 35011-1759 | 1 |
| STAY,REAR FLAP,RH (Ref # 35011A) | 35011-1760 | 1 |
| STAY,REAR FENDER (Ref # 35011B) | 35011-1782 | 1 |
| FLAP,RR,FR,LH,F.BLACK (Ref # 35019) | 35019-1334-6Z | 1 |
| FLAP,RR,FR,RH,F.BLACK (Ref # 35019A) | 35019-1335-6Z | 1 |
| FLAP,RR,RR,F.BLACK (Ref # 35019B) | 35019-1336-6Z | 2 |
| FENDER-REAR,S.GRAY (Ref # 35023) | 35023-1439-RG | 1 |
| MAT,REAR FENDER (Ref # 53004) | 53004-1111 | 1 |
| MAT,REAR FENDER (Ref # 53004A) | 53004-1112 | 1 |
| MAT,REAR FENDER (Ref # 53004B) | 53004-1113 | 1 |
| SCREW (Ref # 92009) | 92009-1166 | 4 |
| SCREW,6X14 (Ref # 92009A) | 92009-1288 | 4 |
| SCREW,6X25 (Ref # 92009B) | 92009-1465 | 2 |
| SCREW,6X16 (Ref # 92009C) | 92009-1621 | 22 |
| NUT,LOCK,FLANGED,6MM (Ref # 92015) | 92015-1675 | 22 |
| WASHER,6.5X16X1.0 (Ref # 92022) | 92022-1093 | 22 |
| COLLAR,FLANGED,L=12.1,BLACK (Ref # 92027) | 92027-1651 | 2 |
| COLLAR,L=4.7 (Ref # 92027A) | 92027-1964 | 6 |
| GROMMET (Ref # 92071) | 92071-1237 | 1 |
| BAND,BATTERY CASE (Ref # 92072) | 92072-1328 | 1 |
| DAMPER,CASE (Ref # 92075) | 92075-222 | 2 |
| WASHER,8.5X20X2.3 (Ref # 92200) | 92200-1055 | 2 |