

# 2002 Prairie 400 PARTS DIAGRAM

Front Fender(s)

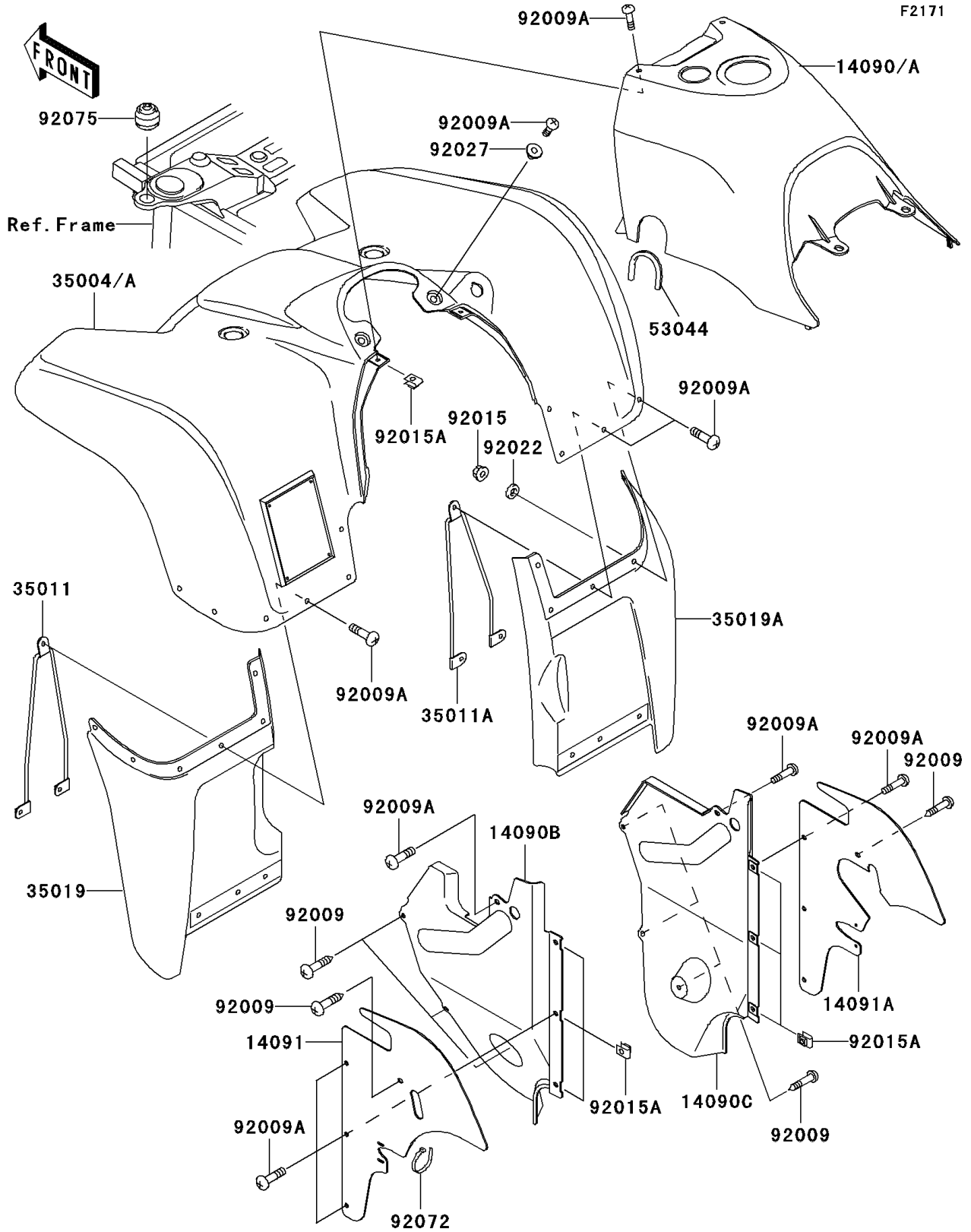

## 2002 Prairie 400 PARTS LIST

### Front Fender(s)

| ITEM NAME                             | PART NUMBER   | QUANTITY |
|---------------------------------------|---------------|----------|
| COVER,FUEL TANK,H.GREEN (Ref # 14090) | 14090-1666-6A | 1        |
| COVER,FUEL TANK,F.RED (Ref # 14090A)  | 14090-1666-6L | 1        |
| COVER,INNER FLAP,LH (Ref # 14090B)    | 14090-1669    | 1        |
| COVER,INNER FLAP,RH (Ref # 14090C)    | 14090-1670    | 1        |
| COVER,INNER FLAP (Ref # 14091)        | 14091-1074    | 1        |
| COVER,INNER FLAP (Ref # 14091A)       | 14091-1075    | 1        |
| FENDER-FRONT,H.GREEN (Ref # 35004)    | 35004-1378-6A | 1        |
| FENDER-FRONT,F.RED (Ref # 35004A)     | 35004-1378-6L | 1        |
| STAY,FRONT FLAP,LH (Ref # 35011)      | 35011-1761    | 1        |
| STAY,FRONT FLAP,RH (Ref # 35011A)     | 35011-1784    | 1        |
| FLAP,FR,LH,F.BLACK (Ref # 35019)      | 35019-1338-6Z | 1        |
| FLAP,FR,RH,F.BLACK (Ref # 35019A)     | 35019-1339-6Z | 1        |
| TRIM,L=150 (Ref # 53044)              | 53044-1303    | 1        |
| SCREW,TAPPING,6X16 (Ref # 92009)      | 92009-1166    | 8        |
| SCREW,6X16 (Ref # 92009A)             | 92009-1621    | 24       |
| NUT,LOCK,FLANGED,6MM (Ref # 92015)    | 92015-1675    | 10       |
| NUT,CLAMP,6MM (Ref # 92015A)          | 92015-1678    | 8        |
| WASHER,6.5X16X1.0 (Ref # 92022)       | 92022-1093    | 10       |
| COLLAR,L=4.7 (Ref # 92027)            | 92027-1964    | 2        |
| BAND,L=149 (Ref # 92072)              | 92072-031     | 1        |
| DAMPER (Ref # 92075)                  | 92075-1744    | 2        |