

2019 CONCOURS®14 ABS PARTS DIAGRAM

Clutch

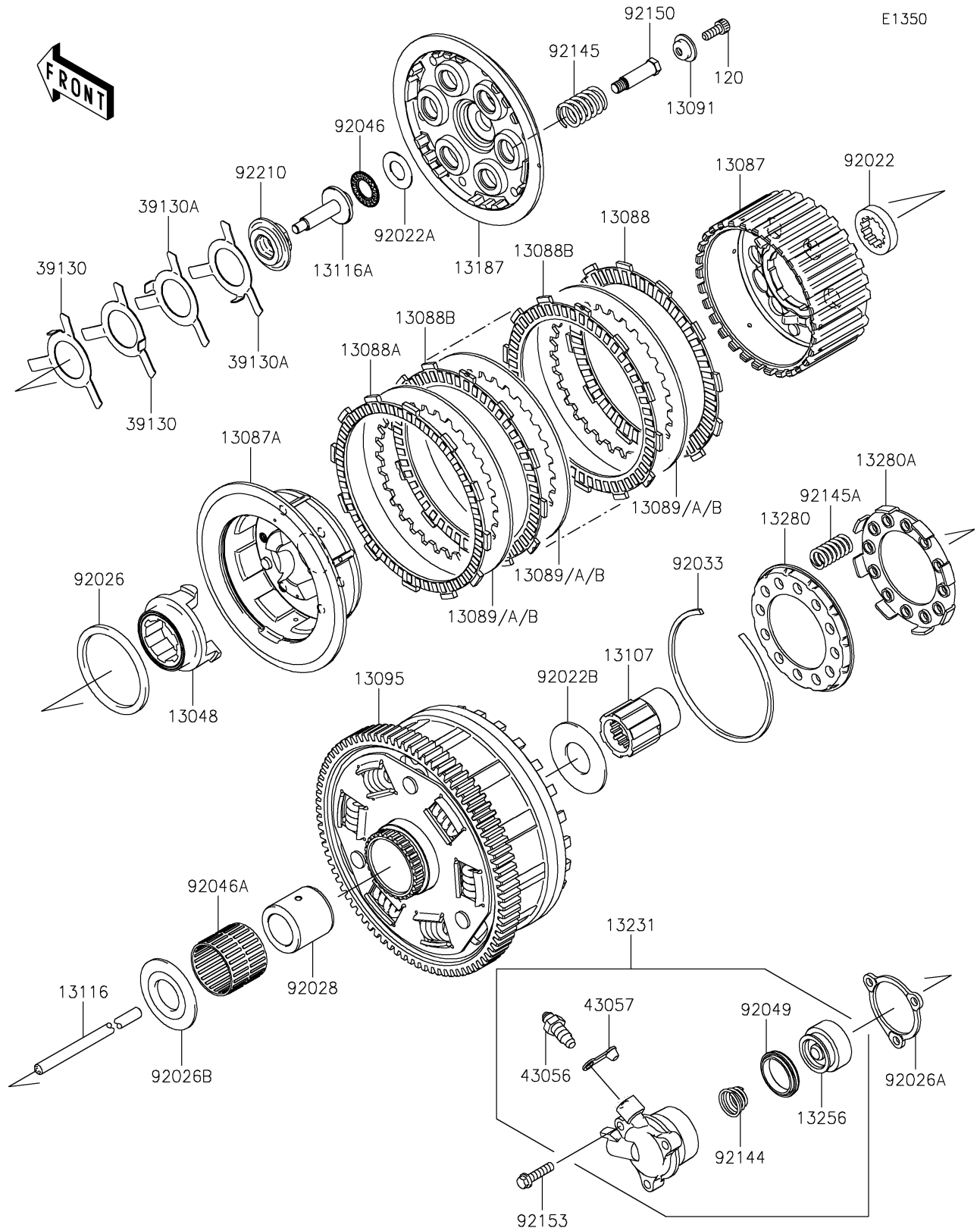

2019 CONCOURS®14 ABS PARTS LIST

Clutch

ITEM NAME	PART NUMBER	QUANTITY
CAM-DAMPER (Ref # 13048)	13048-0015	1
HUB-CLUTCH,MOVABLE (Ref # 13087)	13087-0038	1
HUB-CLUTCH,FIXED (Ref # 13087A)	13087-0044	1
PLATE-FRICTION (Ref # 13088)	13088-0031	1
PLATE-FRICTION (Ref # 13088A)	13088-0033	1
PLATE-FRICTION (Ref # 13088B)	13088-0037	7
PLATE-CLUTCH,T=2.6 (Ref # 13089)	13089-0018	8
PLATE-CLUTCH,T=2.3 (Ref # 13089A)	13089-0019	AR
PLATE-CLUTCH,T=2.9 (Ref # 13089B)	13089-0020	AR
HOLDER,CLUTCH SPRING (Ref # 13091)	13091-1041	6
HOUSING-COMP-CLUTCH (Ref # 13095)	13095-0084	1
SHAFT,CLUTCH (Ref # 13107)	13107-1299	1
ROD-PUSH (Ref # 13116)	13116-0022	1
ROD-PUSH,CLUTCH (Ref # 13116A)	13116-0040	1
PLATE-CLUTCH OPERATING (Ref # 13187)	13187-0012	1
RELEASE-ASSY-CLUTCH (Ref # 13231)	13231-0002	1
PISTON (Ref # 13256)	13256-0004	1
HOLDER,NO MARK (Ref # 13280)	13280-0206	1
HOLDER,ONE MARK (Ref # 13280A)	13280-0207	1
SPRING-LEAF (Ref # 39130)	39130-1078	2
SPRING-LEAF (Ref # 39130A)	39130-1079	2
BREATHER (Ref # 43056)	43056-1055	1
CAP-BREATHER (Ref # 43057)	43057-1001	1
WASHER,TOOTHED,25X40X5 (Ref # 92022)	92022-1114	1
WASHER,15.1X29X1.0 (Ref # 92022A)	92022-1463	1
WASHER,25.3X56X2.0 (Ref # 92022B)	92022-1857	1
SPACER,59X70X3.5 (Ref # 92026)	92026-1043	1
SPACER,CLUTCH RELEASE (Ref # 92026A)	92026-1263	1
SPACER (Ref # 92026B)	92026-1497	1

2019 CONCOURS®14 ABS PARTS LIST

Clutch

ITEM NAME	PART NUMBER	QUANTITY
BUSHING (Ref # 92028)	92028-1934	1
RING-SNAP,98.5X3.4 (Ref # 92033)	92033-0048	1
BEARING-NEEDLE,AXK1102 (Ref # 92046)	92046-1052	1
BEARING-NEEDLE (Ref # 92046A)	92046-1267	1
SEAL-OIL (Ref # 92049)	92049-0086	1
SPRING,CLUTCH RELEASE (Ref # 92144)	92144-1084	1
SPRING,15X2.7 (Ref # 92145)	92145-0440	6
SPRING (Ref # 92145A)	92145-0537	12
BOLT,CLUTCH (Ref # 92150)	92150-1477	6
BOLT,FLANGED-SMALL,6X25 (Ref # 92153)	92153-1565	3
NUT (Ref # 92210)	92210-0152	1
BOLT-SOCKET,6X16 (Ref # 120)	120Q0616	6