

2018 CONCOURS®14 ABS PARTS DIAGRAM

Cowling(Upper)

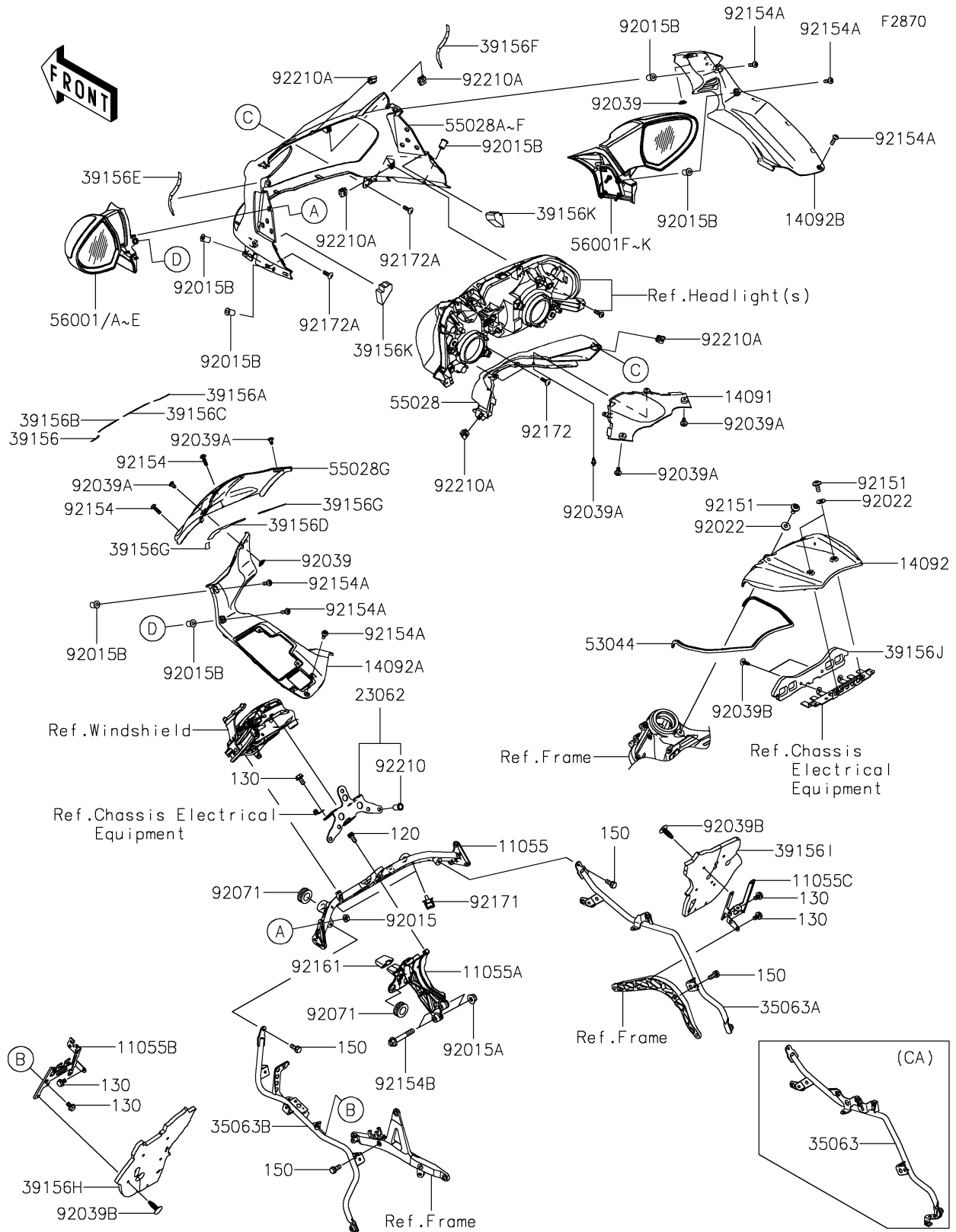

2018 CONCOURS®14 ABS PARTS LIST

Cowling(Upper)

ITEM NAME	PART NUMBER	QUANTITY
BRACKET,MIRROR (Ref # 11055)	11055-0143	1
BRACKET,COWLING (Ref # 11055A)	11055-1804	1
BRACKET,PAD,LH (Ref # 11055B)	11055-1835	1
BRACKET,PAD,RH (Ref # 11055C)	11055-1836	1
COVER,SHROUD,CNT (Ref # 14091)	14091-0859	1
COVER,FUEL TANK (Ref # 14092)	14092-0112	1
COVER,INNER,LH (Ref # 14092A)	14092-0113	1
COVER,INNER,RH (Ref # 14092B)	14092-0114	1
BRACKET-COMP,METER (Ref # 23062)	23062-0036	1
STAY,COWLING,RH (Ref # 35063)	35063-0663	1
STAY,COWLING,RH (Ref # 35063A)	35063-0675	1
STAY,COWLING,LH (Ref # 35063B)	35063-0685	1
PAD,UPP COWLING,CNT,LH (Ref # 39156)	39156-0378	1
PAD,UPP COWLING,CNT,RH (Ref # 39156A)	39156-0379	1
PAD,UPP COWLING,CNT,LH (Ref # 39156B)	39156-0380	1
PAD,UPP COWLING,CNT,RH (Ref # 39156C)	39156-0381	1
PAD,UPP COWLING,CNT (Ref # 39156D)	39156-0382	1
PAD,UPP COWLING,LH (Ref # 39156E)	39156-0384	1
PAD,UPP COWLING,RH (Ref # 39156F)	39156-0385	1
PAD,UPP COWLING,CNT (Ref # 39156G)	39156-0398	2
PAD,LH (Ref # 39156H)	39156-0588	1
PAD,RH (Ref # 39156I)	39156-0589	1
PAD,CNT (Ref # 39156J)	39156-0590	1
PAD (Ref # 39156K)	39156-2155	2
TRIM (Ref # 53044)	53044-0054	1
COWLING,INTAKE (Ref # 55028)	55028-0192	1
COWLING,UPP,M.C.GRAY (Ref # 55028C)	55028-0198-51A	1
COWLING,CNT (Ref # 55028G)	55028-0306	1
MIRROR-ASSY,LH,M.C.GRAY (Ref # 56001B)	56001-0182-51A	1

2018 CONCOURS®14 ABS PARTS LIST

Cowling(Upper)

ITEM NAME	PART NUMBER	QUANTITY
BOLT-SOCKET,6X12 (Ref # 120)	120CA0612	4
BOLT-FLANGED,6X12 (Ref # 130)	130BA0612	6
BOLT-WS,6X16 (Ref # 150)	150R0616	4
MIRROR-ASSY,RH,M.C.GRAY (Ref # 56001H)	56001-0183-51A	1
NUT,FLANGED,6MM (Ref # 92015)	92015-1367	6
NUT,8MM (Ref # 92015A)	92015-1432	2
NUT,WELL,5MM (Ref # 92015B)	92015-1757	8
WASHER,6.5X16X1 (Ref # 92022)	92022-1143	3
RIVET (Ref # 92039)	92039-0048	2
RIVET (Ref # 92039A)	92039-0051	6
RIVET (Ref # 92039B)	92039-0090	10
GROMMET (Ref # 92071)	92071-1131	4
BOLT,SOCKET,6X14 (Ref # 92151)	92151-1654	3
BOLT,SOCKET,5X16 (Ref # 92154)	92154-0026	2
BOLT,SOCKET,5X16 (Ref # 92154A)	92154-0209	6
BOLT,FLANGED,8X53 (Ref # 92154B)	92154-1348	2
DAMPER,HEAD LAMP (Ref # 92161)	92161-0412	1
CLAMP (Ref # 92171)	92171-1665	2
SCREW,TAPPING,5X14 (Ref # 92172)	92172-0265	2
SCREW,5X16 (Ref # 92172A)	92172-0322	2
NUT,POP,6MM,L=16.5 (Ref # 92210)	92210-0324	2
NUT (Ref # 92210A)	92210-0571	8