

# 2016 KX™ 85 PARTS DIAGRAM

Clutch

E1350

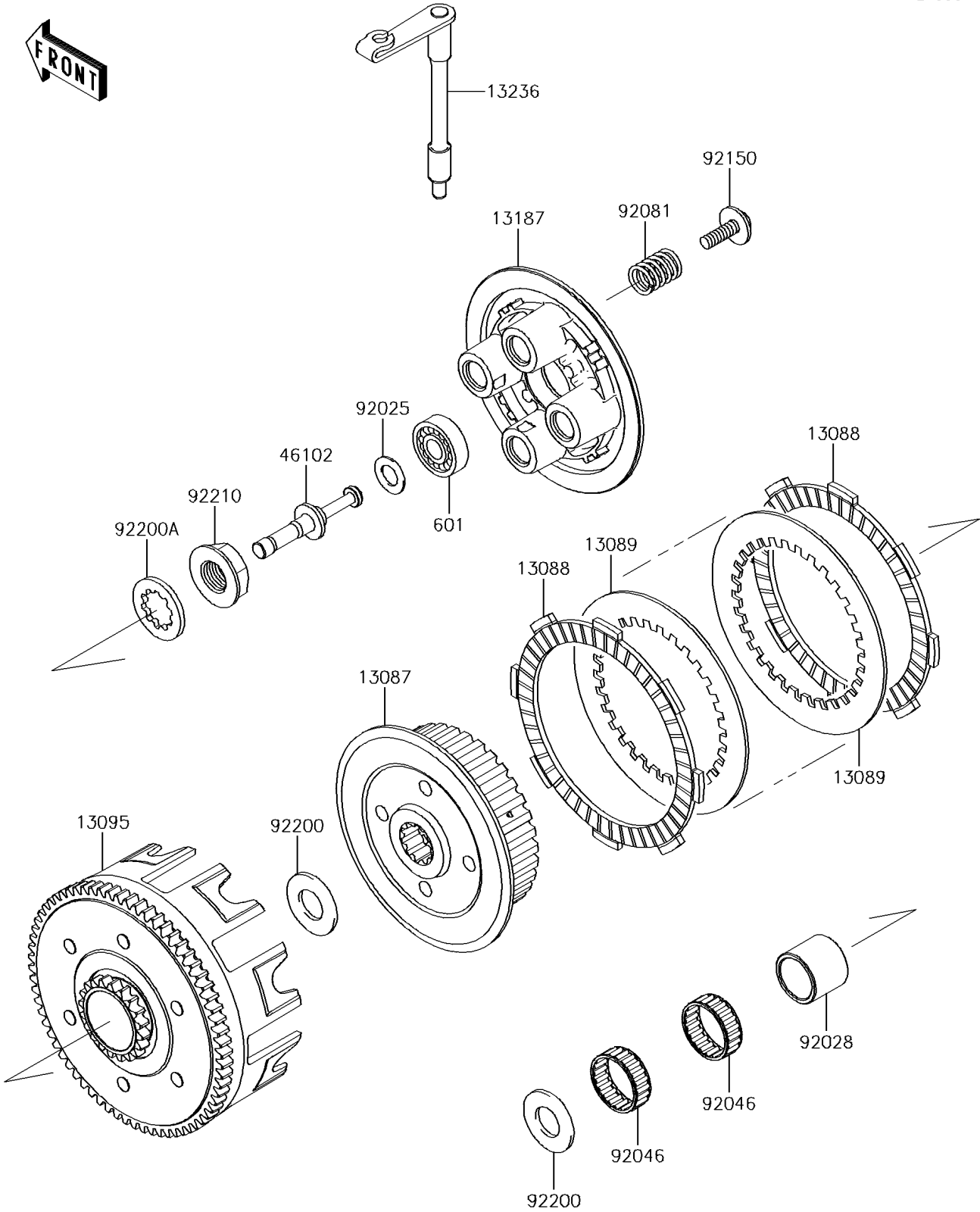

## 2016 KX™ 85 PARTS LIST

### Clutch

| ITEM NAME                               | PART NUMBER | QUANTITY |
|---|-------------|----------|
| HUB-CLUTCH (Ref # 13087)                | 13087-1170  | 1        |
| PLATE-FRICTION,ID=91 (Ref # 13088)      | 13088-1016  | 6        |
| PLATE-CLUTCH (Ref # 13089)              | 13089-1120  | 5        |
| HOUSING-COMP-CLUTCH (Ref # 13095)       | 13095-1406  | 1        |
| PLATE-CLUTCH OPERATING (Ref # 13187)    | 13187-1013  | 1        |
| LEVER-COMP,RELEASE (Ref # 13236)        | 13236-1298  | 1        |
| ROD,CLUTCH RELEASE (Ref # 46102)        | 46102-1409  | 1        |
| BEARING-BALL (Ref # 601)                | 601A6001    | 1        |
| SHIM (Ref # 92025)                      | 92025-1780  | 1        |
| BUSHING,20X25X21.1 (Ref # 92028)        | 92028-1811  | 1        |
| BEARING-NEEDLE,KT252910EG (Ref # 92046) | 92046-1254  | 2        |
| SPRING,CLUTCH (Ref # 92081)             | 92081-1492  | 4        |
| BOLT,6X20,WASHER (Ref # 92150)          | 92150-1715  | 4        |
| WASHER,20.3X33X2.0 (Ref # 92200)        | 92200-1351  | 2        |
| WASHER,20X30X2.6 (Ref # 92200A)         | 92200-1352  | 1        |
| NUT,16MM (Ref # 92210)                  | 92210-1113  | 1        |