

2003 Prairie 650 4X4 Advantage Classic PARTS DIAGRAM

Valve(s)

E1210

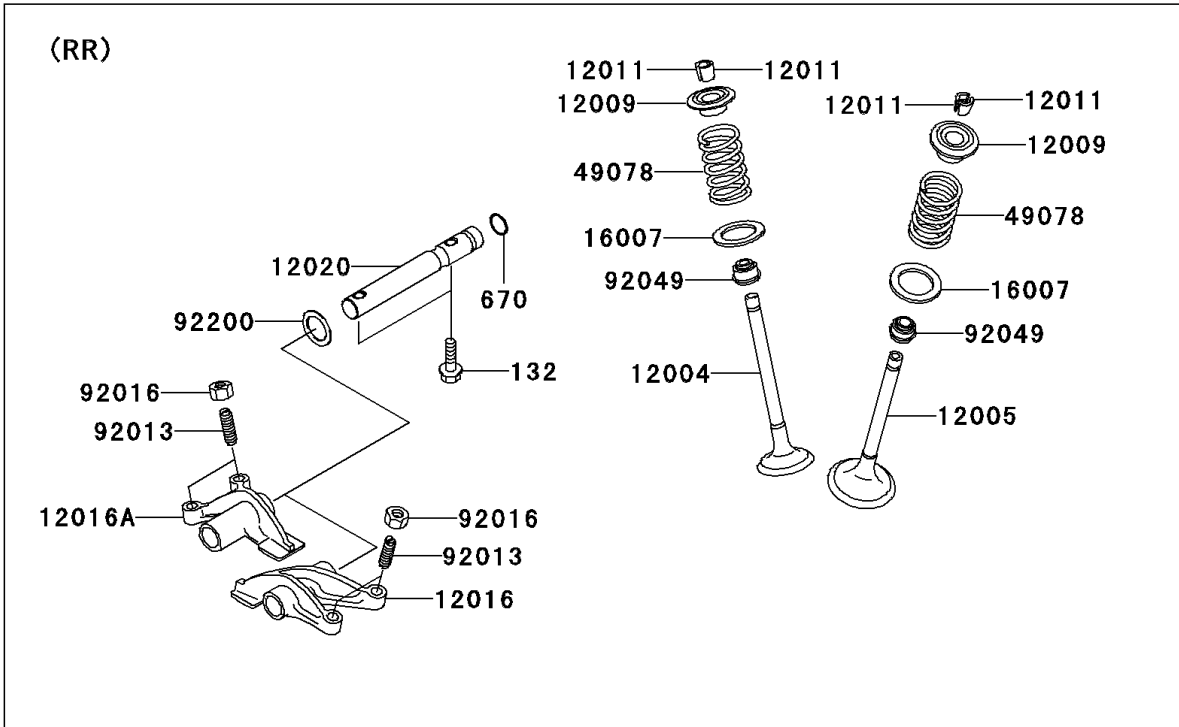
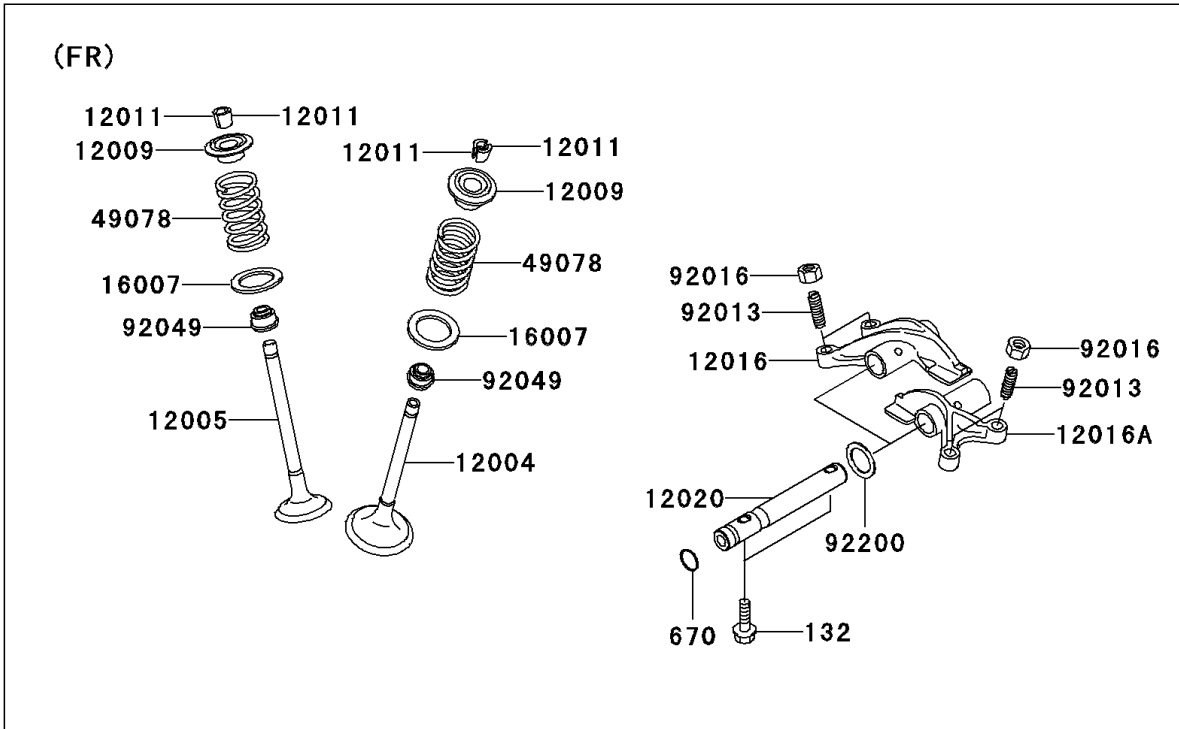

2003 Prairie 650 4X4 Advantage Classic PARTS LIST

Valve(s)

ITEM NAME	PART NUMBER	QUANTITY
BOLT-FLANGED-SMALL (Ref # 132)	132Y0612	8
O RING,9MM (Ref # 670)	670D1509	4
VALVE-INTAKE (Ref # 12004)	12004-1146	4
VALVE-EXHAUST (Ref # 12005)	12005-1349	4
RETAINER-VALVE SPRING (Ref # 12009)	12009-1056	8
COLLET (Ref # 12011)	12011-1051	16
ARM-ROCKER,EXHAUST (Ref # 12016)	12016-1128	2
ARM-ROCKER,INTAKE (Ref # 12016A)	12016-1129	2
SHAFT-ROCKER (Ref # 12020)	12020-1083	4
SEAT-SPRING,17.5X23.8X0.5 (Ref # 16007)	16007-1178	8
SPRING-ENGINE VALVE (Ref # 49078)	49078-1073	8
SCREW,6MM (Ref # 92013)	92013-009	8
NUT,6MM (Ref # 92016)	92016-061	8
SEAL-OIL,VSB58.558 (Ref # 92049)	92049-1218	8
WASHER,ROCKER ARM (Ref # 92200)	92200-1508	4