

# 2003 Prairie 650 4X4 Advantage Classic PARTS DIAGRAM

Frame

F2120

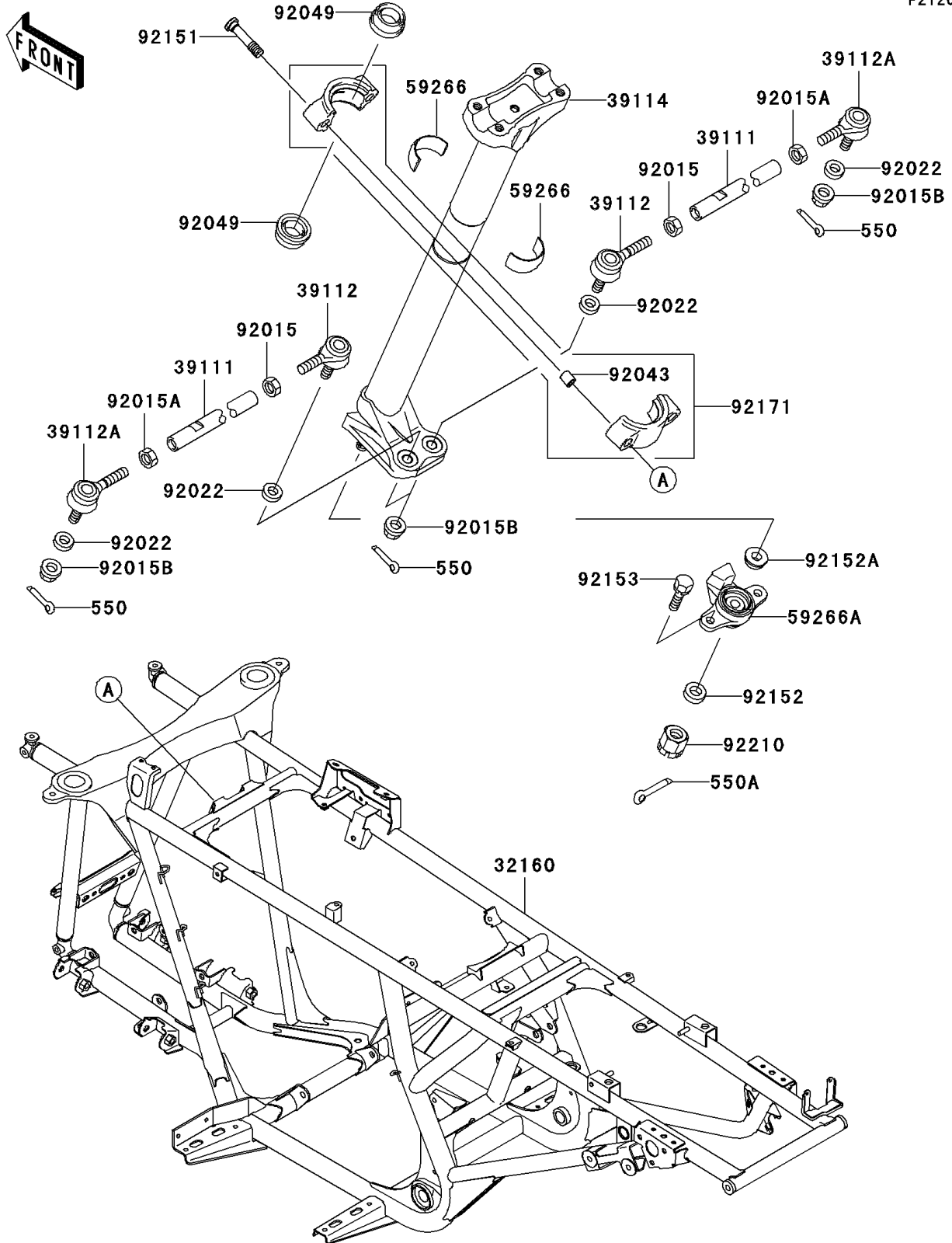

## 2003 Prairie 650 4X4 Advantage Classic PARTS LIST

### Frame

ITEM NAME	PART NUMBER	QUANTITY
PIN-COTTER,2.0X15 (Ref # 550)	550D2015	4
PIN-COTTER,3.0X25 (Ref # 550A)	550D3025	1
FRAME-COMP (Ref # 32160)	32160-1814	1
ROD-TIE (Ref # 39111)	39111-1090	2
RODEND-TIE (Ref # 39112)	39112-1083	2
RODEND-TIE (Ref # 39112A)	39112-1085	2
SHAFT-COMP-STRG (Ref # 39114)	39114-1090	1
JOINT-BALL (Ref # 59266)	59266-1117	2
JOINT-BALL (Ref # 59266A)	59266-1125	1
NUT,LOCK,10MM (Ref # 92015)	92015-1460	2
NUT,LOCK,10MM (Ref # 92015A)	92015-1494	2
NUT,LOCK,FLANGED,10MM (Ref # 92015B)	92015-1717	4
WASHER,10.2X20X1.5 (Ref # 92022)	92022-3742	4
PIN,8.2X10X14 (Ref # 92043)	92043-1264	2
SEAL-OIL,SR7 39.6X49X6-2 NS (Ref # 92049)	92049-1580	2
BOLT,8X53 (Ref # 92151)	92151-1711	2
COLLAR,12X21.3X7 (Ref # 92152)	92152-1351	1
COLLAR (Ref # 92152A)	92152-1358	1
BOLT,8X30 (Ref # 92153)	92153-1065	2
CLAMP,STEERING SHAFT (Ref # 92171)	92171-1449	1
NUT,12MM (Ref # 92210)	92210-7501	1