

2005 Brute Force 650 4x4 PARTS DIAGRAM

Fuel Tank

F2410

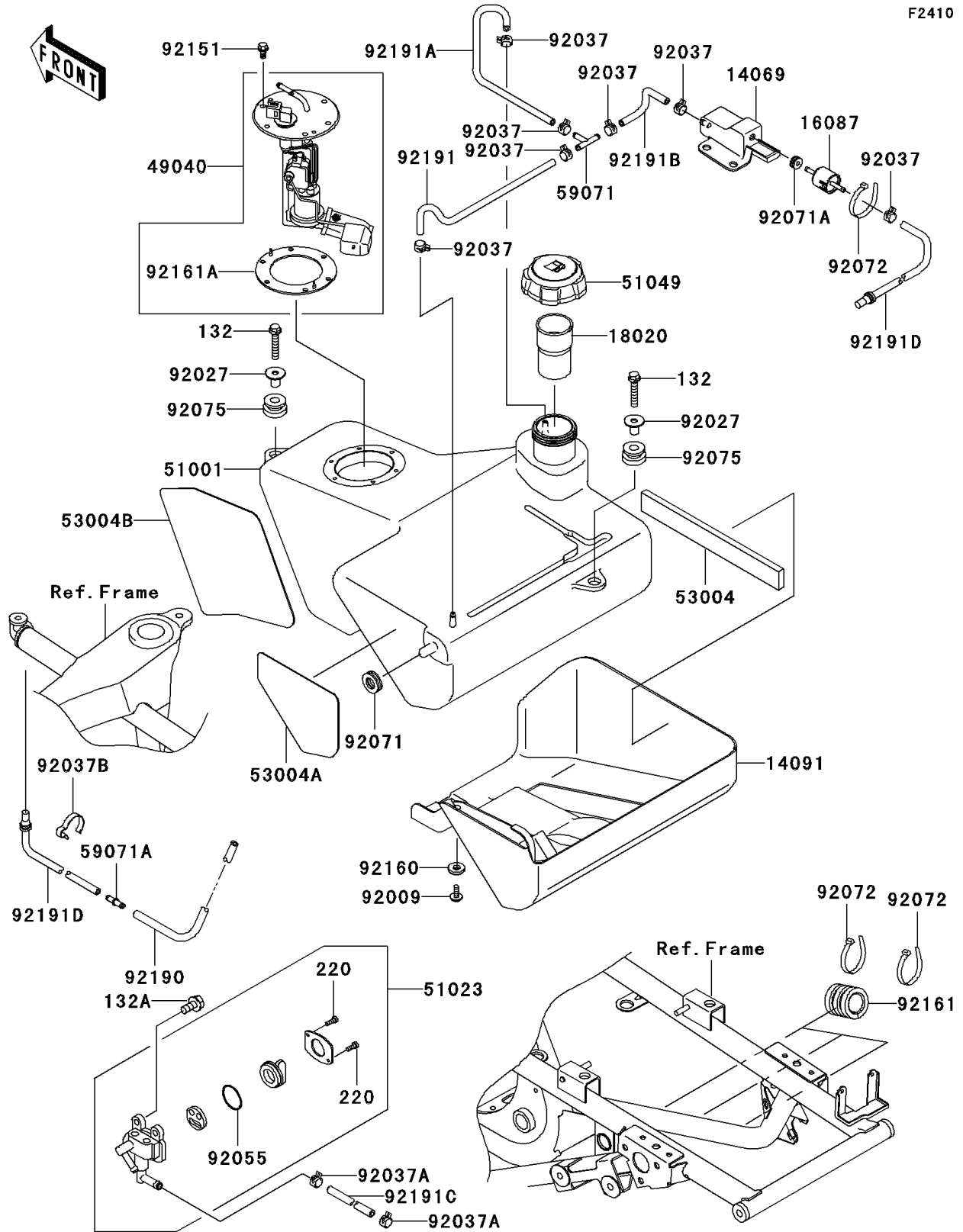

2005 Brute Force 650 4x4 PARTS LIST

Fuel Tank

ITEM NAME	PART NUMBER	QUANTITY
BOLT-FLANGED-SMALL,6X30 (Ref # 132)	132G0630	2
BOLT-FLANGED-SMALL,6X12 (Ref # 132A)	132J0612	2
SCREW-PAN-CROS,3X8 (Ref # 220)	220B0308	2
BREATHER,TANK (Ref # 14069)	14069-1069	1
COVER,FUEL TANK (Ref # 14091)	14091-1404	1
VALVE-CHECK (Ref # 16087)	16087-1054	1
BAFFLE,FUEL TANK CAP (Ref # 18020)	18020-1278	1
PUMP-FUEL (Ref # 49040)	49040-0006	1
TANK-COMP-FUEL (Ref # 51001)	51001-1638	1
TAP-ASSY,FUEL (Ref # 51023)	51023-0002	1
CAP-TANK,FUEL (Ref # 51049)	51049-0001	1
MAT,FUEL TANK COVER (Ref # 53004)	53004-1161	1
MAT,FUEL TANK (Ref # 53004A)	53004-1164	1
MAT,FUEL TANK (Ref # 53004B)	53004-1165	1
JOINT (Ref # 59071)	59071-3705	1
JOINT (Ref # 59071A)	59071-3717	1
SCREW,6X12 (Ref # 92009)	92009-1480	1
COLLAR,L=16.1 (Ref # 92027)	92027-1847	2
CLAMP,TUBE (Ref # 92037)	92037-1461	7
CLAMP,TUBE (Ref # 92037A)	92037-1505	2
CLAMP,HOSE (Ref # 92037B)	92037-1552	1
RING-O (Ref # 92055)	92055-0017	1
GROMMET,AIR SUCTION VALVE (Ref # 92071)	92071-1249	1
GROMMET (Ref # 92071A)	92071-1266	1
BAND,L=188 (Ref # 92072)	92072-1239	7
DAMPER (Ref # 92075)	92075-1787	2
BOLT,FLANGED,5X11.5 (Ref # 92151)	92151-1754	6
DAMPER (Ref # 92160)	92160-1017	1
DAMPER,FUEL TANK,RR (Ref # 92161)	92161-1111	3

2005 Brute Force 650 4x4 PARTS LIST

Fuel Tank

ITEM NAME	PART NUMBER	QUANTITY
DAMPER,FUEL PUMP (Ref # 92161A)	92161-1272	1
TUBE,5X9X530 (Ref # 92190)	92190-1256	1
TUBE,TANK-FRONT (Ref # 92191)	92191-1639	1
TUBE,TANK-REAR (Ref # 92191A)	92191-1640	1
TUBE,5X9X160 (Ref # 92191B)	92191-1641	1
TUBE,5.3X10.5X425 (Ref # 92191C)	92191-1665	1
TUBE,TANK BREATHER (Ref # 92191D)	92191-1666	2