

2018 BRUTE FORCE® 300 PARTS DIAGRAM

Drive Shaft/Final Gear

E3132

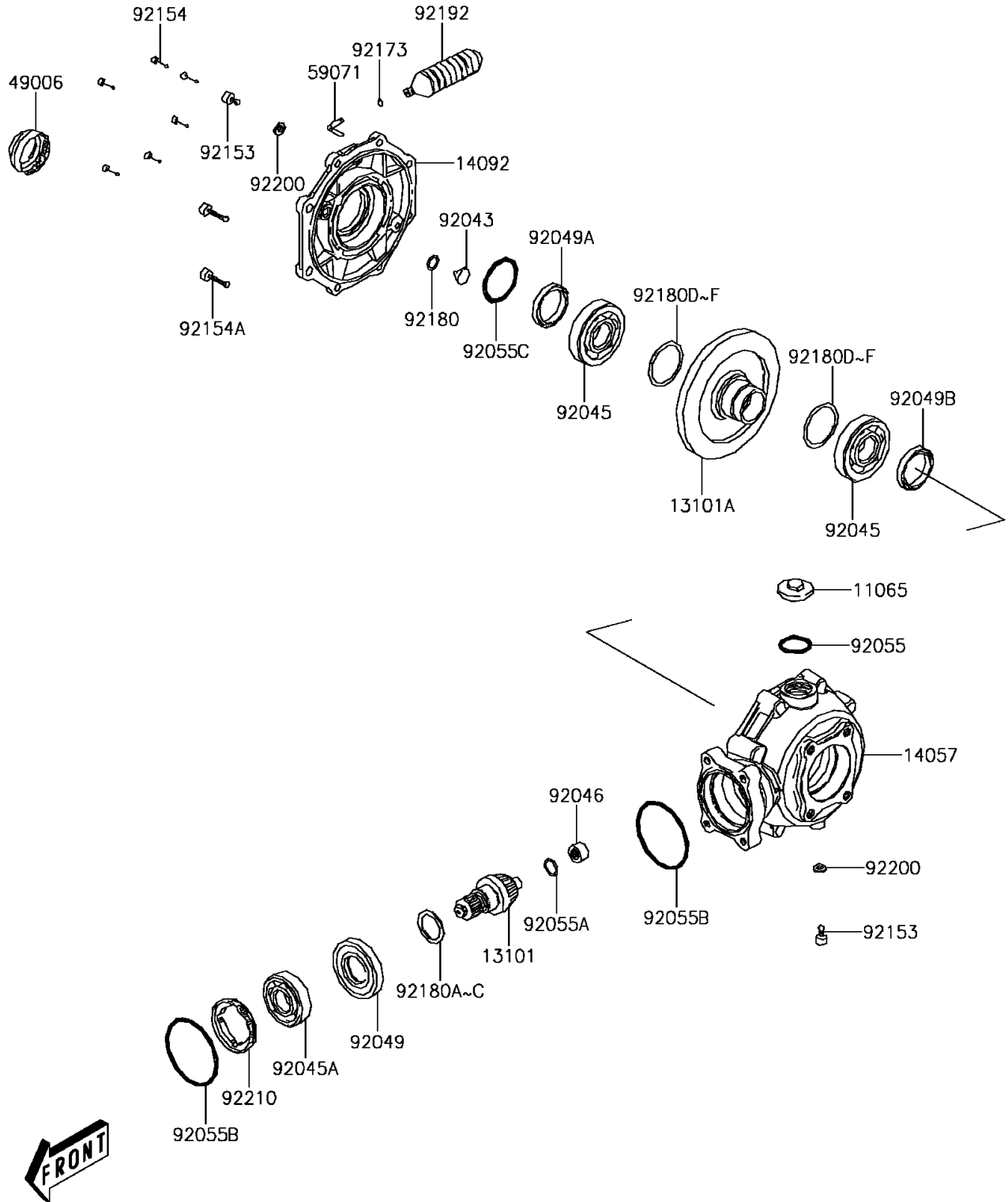

2018 BRUTE FORCE® 300 PARTS LIST

Drive Shaft/Final Gear

ITEM NAME	PART NUMBER	QUANTITY
CAP (Ref # 11065)	11065-Y006	1
GEAR-ASSY,PINION (Ref # 13101)	13101-Y001	1
GEAR-ASSY,RING (Ref # 13101A)	13101-Y002	1
CASE-COMP-GEAR (Ref # 14057)	14057-Y001	1
COVER,RH (Ref # 14092)	14092-Y018	1
BOOT,RR,AXLE SHAFT (Ref # 49006)	49006-Y007	1
JOINT,BREATHER (Ref # 59071)	59071-Y002	1
PIN,RING GEAR,STOPPER (Ref # 92043)	92043-Y022	1
BEARING-BALL,6009 (Ref # 92045)	92045-Y022	2
BEARING-BALL,6206 (Ref # 92045A)	92045-Y029	1
BEARING-NEEDLE,14X20X12 (Ref # 92046)	92046-Y007	1
SEAL-OIL,35X70X10 (Ref # 92049)	92049-Y020	1
SEAL-OIL,44X60X7 (Ref # 92049A)	92049-Y021	1
SEAL-OIL,42X62X7 (Ref # 92049B)	92049-Y022	1
RING-O,30.8MM (Ref # 92055)	92055-Y005	1
CIRCLIP (Ref # 92055A)	92055-Y031	1
RING-O,74.4X3.1 (Ref # 92055B)	92055-Y032	2
RING-O,31.7X3.5 (Ref # 92055C)	92055-Y033	1
BOLT,FLANGE,8X12 (Ref # 92153)	92153-Y031	2
BOLT,FLANGE,8X30 (Ref # 92154)	92154-Y137	6
BOLT,FLANGE,10X35 (Ref # 92154A)	92154-Y140	2
CLAMP,10.5 (Ref # 92173)	92173-Y023	1
SHIM,T=0.3 (Ref # 92180)	92180-Y025	1
SHIM,PINION GEAR,A (Ref # 92180A)	92180-Y026	AR
SHIM,PINION GEAR,B (Ref # 92180B)	92180-Y027	AR
SHIM,PINION GEAR,C (Ref # 92180C)	92180-Y028	AR
SHIM,RING GEAR,A (Ref # 92180D)	92180-Y029	AR
SHIM,RING GEAR,B (Ref # 92180E)	92180-Y030	AR
SHIM,RING GEAR,C (Ref # 92180F)	92180-Y031	AR

2018 BRUTE FORCE® 300 PARTS LIST

Drive Shaft/Final Gear

ITEM NAME	PART NUMBER	QUANTITY
TUBE,BREATHER (Ref # 92192)	92192-Y016	1
WASHER,8MM (Ref # 92200)	92200-Y010	2
NUT,LOCK,65MM (Ref # 92210)	92210-Y052	1