

# 2006 Brute Force 750 4x4i PARTS DIAGRAM

Drive Shaft-Front

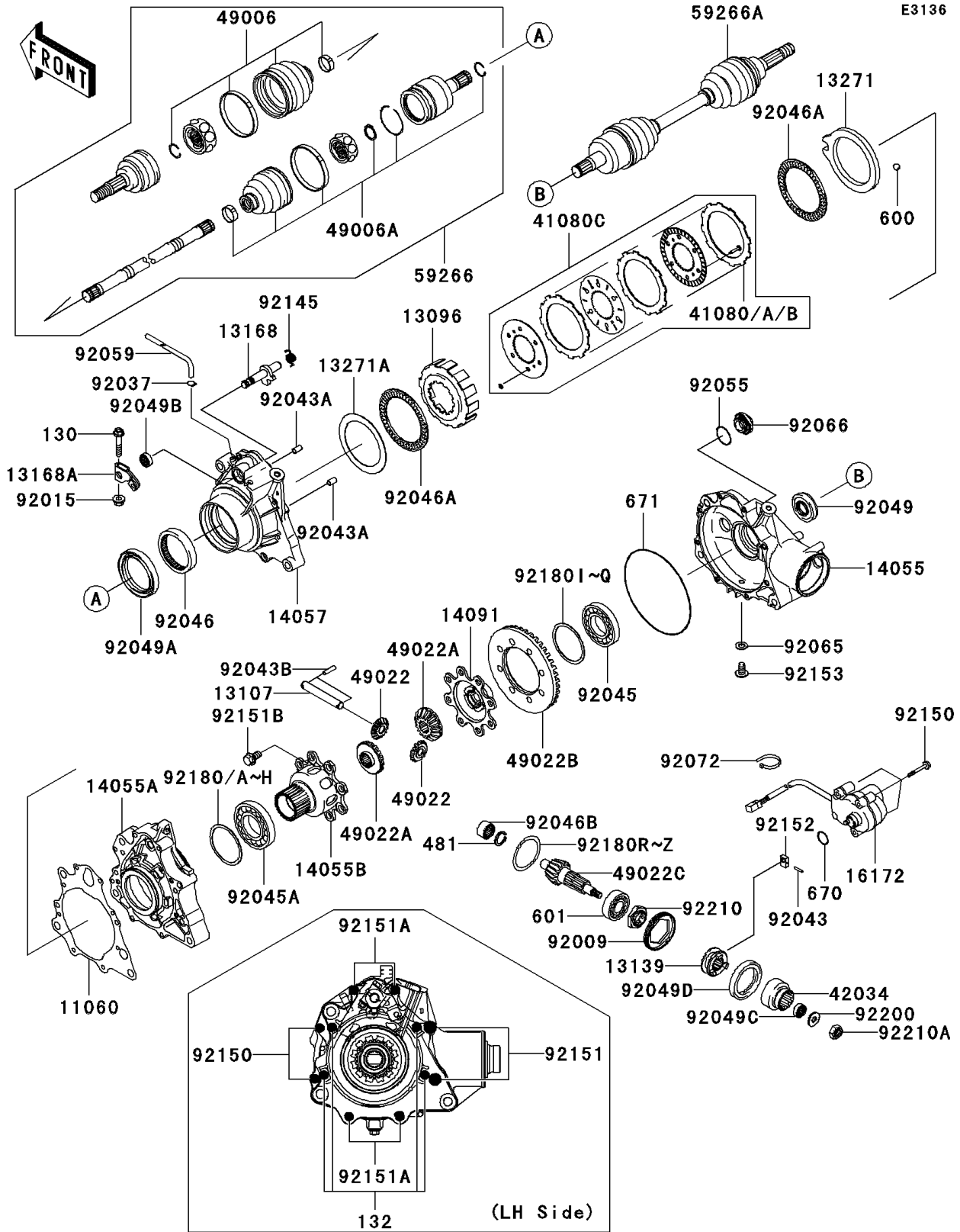

## 2006 Brute Force 750 4x4i PARTS LIST

### Drive Shaft-Front

| ITEM NAME                                  | PART NUMBER | QUANTITY |
|--------------------------------------------|-------------|----------|
| GASKET,DIFF CASE (Ref # 11060)             | 11060-1982  | 1        |
| HOUSING-CLUTCH,DISC (Ref # 13096)          | 13096-1163  | 1        |
| SHAFT,CROSS (Ref # 13107)                  | 13107-0123  | 1        |
| SHIFTER,DIFFERENTIAL (Ref # 13139)         | 13139-1097  | 1        |
| LEVER,DIFF (Ref # 13168)                   | 13168-1724  | 1        |
| LEVER,DIFFERENTIAL (Ref # 13168A)          | 13168-1725  | 1        |
| PLATE,CAM (Ref # 13271)                    | 13271-1497  | 1        |
| PLATE,DISC (Ref # 13271A)                  | 13271-1503  | 1        |
| CASE-GEAR (Ref # 14055)                    | 14055-0014  | 1        |
| CASE-GEAR,CENTER (Ref # 14055A)            | 14055-1155  | 1        |
| CASE-GEAR,BEVEL,LH (Ref # 14055B)          | 14055-1156  | 1        |
| CASE-COMP-GEAR,DIFF,LH (Ref # 14057)       | 14057-1004  | 1        |
| COVER,BEVEL,RH (Ref # 14091)               | 14091-1197  | 1        |
| ACTUATOR (Ref # 16172)                     | 16172-0007  | 1        |
| DISC,T=1.20 (Ref # 41080)                  | 41080-1499  | AR       |
| DISC,T=1.80 (Ref # 41080A)                 | 41080-1500  | AR       |
| DISC,T=2.40 (Ref # 41080B)                 | 41080-1501  | AR       |
| DISC ASSY,DIFFERENTIAL LOCK (Ref # 41080C) | 41080-1512  | 1        |
| COUPLING,BEVEL (Ref # 42034)               | 42034-1192  | 1        |
| BOOT,UJ (Ref # 49006)                      | 49006-0016  | 2        |
| BOOT,DOJ (Ref # 49006A)                    | 49006-0017  | 2        |
| GEAR-BEVEL,10T (Ref # 49022)               | 49022-1177  | 2        |
| GEAR-BEVEL,16T (Ref # 49022A)              | 49022-1178  | 2        |
| GEAR-BEVEL,35T (Ref # 49022B)              | 49022-1190  | 1        |
| GEAR-BEVEL,8T (Ref # 49022C)               | 49022-1201  | 1        |
| JOINT-BALL,LH (Ref # 59266)                | 59266-0007  | 1        |
| JOINT-BALL,RH (Ref # 59266A)               | 59266-0008  | 1        |
| SCREW,64MM (Ref # 92009)                   | 92009-1914  | 1        |
| NUT,LOCK,FLANGED,6MM (Ref # 92015)         | 92015-1339  | 1        |

## 2006 Brute Force 750 4x4i PARTS LIST

### Drive Shaft-Front

| ITEM NAME                                 | PART NUMBER | QUANTITY |
|-------------------------------------------|-------------|----------|
| CLAMP,HOSE (Ref # 92037)                  | 92037-1104  | 1        |
| PIN,2X10.5 (Ref # 92043)                  | 92043-0083  | 1        |
| PIN,6.2X8X14 (Ref # 92043A)               | 92043-1263  | 2        |
| PIN (Ref # 92043B)                        | 92043-1575  | 2        |
| BEARING-BALL,60/32 (Ref # 92045)          | 92045-1393  | 1        |
| BEARING-BALL,6910 (Ref # 92045A)          | 92045-1394  | 1        |
| BEARING-NEEDLE,TA627412ZE02 (Ref # 92046) | 92046-1282  | 1        |
| BEARING-NEEDLE,AK1116 (Ref # 92046A)      | 92046-1286  | 2        |
| BEARING-NEEDLE,AJ501515W (Ref # 92046B)   | 92046-1297  | 1        |
| SEAL-OIL,SDD7 22X48X7HS (Ref # 92049)     | 92049-1534  | 1        |
| SEAL-OIL,HTCY 62X81X10.5 (Ref # 92049A)   | 92049-1536  | 1        |
| SEAL-OIL,TC 12X22X7 (Ref # 92049B)        | 92049-1550  | 1        |
| SEAL-OIL,KB 13X19X13 (Ref # 92049C)       | 92049-1572  | 1        |
| SEAL-OIL,TCY 48X65X8 (Ref # 92049D)       | 92049-1573  | 1        |
| RING-O,25.7X2.4 (Ref # 92055)             | 92055-1136  | 1        |
| TUBE,7X12X760,GREEN (Ref # 92059)         | 92059-1679  | 1        |
| GASKET (Ref # 92065)                      | 92065-023   | 1        |
| PLUG (Ref # 92066)                        | 92066-1303  | 1        |
| BAND,L=188 (Ref # 92072)                  | 92072-1239  | 1        |
| SPRING,DIFF RETURN (Ref # 92145)          | 92145-1344  | 1        |
| BOLT,6X45 (Ref # 92150)                   | 92150-1884  | 5        |
| BOLT,8X50 (Ref # 92151)                   | 92151-1794  | 2        |
| BOLT,6X60 (Ref # 92151A)                  | 92151-1795  | 4        |
| BOLT,10X19.5 (Ref # 92151B)               | 92151-1910  | 8        |
| COLLAR (Ref # 92152)                      | 92152-1349  | 1        |
| BOLT,8X15 (Ref # 92153)                   | 92153-0870  | 1        |
| SHIM,62X71X0.15 (Ref # 92180)             | 92180-1390  | AR       |
| SHIM,62X71X0.20 (Ref # 92180A)            | 92180-1391  | AR       |
| SHIM,62X71X0.50 (Ref # 92180B)            | 92180-1392  | AR       |

## 2006 Brute Force 750 4x4i PARTS LIST

### Drive Shaft-Front

| ITEM NAME                           | PART NUMBER | QUANTITY |
|-------------------------------------|-------------|----------|
| SHIM,62X71X0.70 (Ref # 92180C)      | 92180-1393  | AR       |
| SHIM,62X71X0.80 (Ref # 92180D)      | 92180-1394  | AR       |
| SHIM,62X71X0.90 (Ref # 92180E)      | 92180-1395  | AR       |
| SHIM,62X71X1.00 (Ref # 92180F)      | 92180-1396  | AR       |
| SHIM,62X71X1.10 (Ref # 92180G)      | 92180-1397  | AR       |
| SHIM,62X71X1.20 (Ref # 92180H)      | 92180-1398  | AR       |
| SHIM,32X42X0.15 (Ref # 92180I)      | 92180-1399  | AR       |
| SHIM,32X42X0.20 (Ref # 92180J)      | 92180-1400  | AR       |
| SHIM,32X42X0.50 (Ref # 92180K)      | 92180-1401  | AR       |
| SHIM,32X42X0.70 (Ref # 92180L)      | 92180-1402  | AR       |
| SHIM,32X42X0.80 (Ref # 92180M)      | 92180-1403  | AR       |
| SHIM,32X42X0.90 (Ref # 92180N)      | 92180-1404  | AR       |
| SHIM,32X42X1.00 (Ref # 92180O)      | 92180-1405  | AR       |
| SHIM,32X42X1.10 (Ref # 92180P)      | 92180-1406  | AR       |
| SHIM,32X42X1.20 (Ref # 92180Q)      | 92180-1407  | AR       |
| SHIM,50X61X0.15 (Ref # 92180R)      | 92180-1408  | AR       |
| SHIM,50X61X0.20 (Ref # 92180S)      | 92180-1409  | AR       |
| SHIM,50X61X0.50 (Ref # 92180T)      | 92180-1410  | AR       |
| SHIM,50X61X0.70 (Ref # 92180U)      | 92180-1411  | AR       |
| SHIM,50X61X0.80 (Ref # 92180V)      | 92180-1412  | AR       |
| BOLT-FLANGED,6X35 (Ref # 130)       | 130G0635    | 1        |
| BOLT-FLANGED-SMALL,6X30 (Ref # 132) | 132Y0630    | 4        |
| CIRCLIP-TYPE-C,25MM (Ref # 481)     | 481J2500    | 1        |
| BALL-STEEL,11/32" (Ref # 600)       | 600A1100    | 6        |
| BEARING-BALL,#6305 (Ref # 601)      | 601A6305    | 1        |
| O RING (Ref # 670)                  | 670D3022    | 1        |
| O RING (Ref # 671)                  | 671D25145   | 1        |
| SHIM,50X61X0.90 (Ref # 92180W)      | 92180-1413  | AR       |
| SHIM,50X61X1.00 (Ref # 92180X)      | 92180-1414  | AR       |

## 2006 Brute Force 750 4x4i PARTS LIST

### Drive Shaft-Front

| ITEM NAME                      | PART NUMBER | QUANTITY |
|--------------------------------|-------------|----------|
| SHIM,50X61X1.10 (Ref # 92180Y) | 92180-1415  | AR       |
| SHIM,50X61X1.20 (Ref # 92180Z) | 92180-1416  | AR       |
| WASHER,10X24X2.5 (Ref # 92200) | 92200-1635  | 1        |
| NUT,25MM (Ref # 92210)         | 92210-1225  | 1        |
| NUT,LOCK,10MM (Ref # 92210A)   | 92210-1351  | 1        |