

2008 Brute Force 750 4x4i NRA Outdoors PARTS DIAGRAM

Frame Fittings

F2131

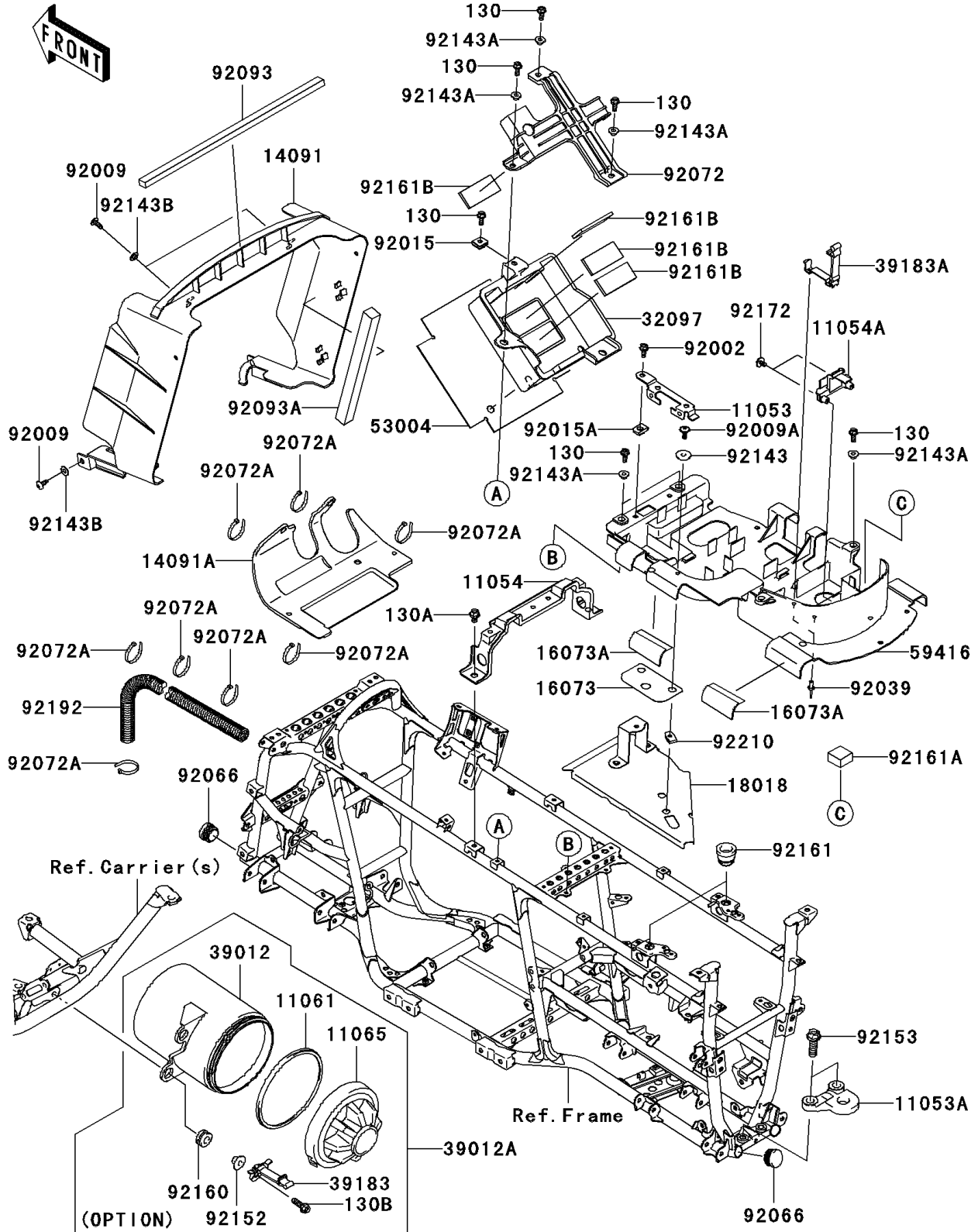

2008 Brute Force 750 4x4i NRA Outdoors PARTS LIST

Frame Fittings

ITEM NAME	PART NUMBER	QUANTITY
BRACKET,FUSE ASSY (Ref # 11053)	11053-0937	1
BRACKET,TRAILER HITCH (Ref # 11053A)	11053-1638	1
BRACKET,SEAT&BATTERY BAND (Ref # 11054)	11054-1236	1
BRACKET,RELAY (Ref # 11054A)	11054-1318	1
GASKET,TOOL CASE (Ref # 11061)	11061-0072	1
CAP,TOOL CASE (Ref # 11065)	11065-0088	1
COVER,RADIATOR (Ref # 14091)	14091-0338	1
COVER,AIR CLEANER (Ref # 14091A)	14091-0540	1
INSULATOR,ELECTRIC CASE (Ref # 16073)	16073-0035	1
INSULATOR,ELECTRIC CASE (Ref # 16073A)	16073-0036	2
PLATE-HEAT GUARD (Ref # 18018)	18018-0009	1
CASE-BATTERY (Ref # 32097)	32097-0009	1
CASE-STORAGE (Ref # 39012)	39012-0005	1
CASE-STORAGE,ASSY (Ref # 39012A)	39012-5013	1
BAND-ASSY,TOOL BAG (Ref # 39183)	39183-0003	1
BAND-ASSY,TOOL BAG (Ref # 39183A)	39183-1065	1
MAT,BATTERY CASE (Ref # 53004)	53004-0002	1
CASE-ELECTRIC (Ref # 59416)	59416-0004	1
BOLT,6X16 (Ref # 92002)	92002-1571	1
SCREW,TAPPING,6X16 (Ref # 92009)	92009-1166	4
SCREW,6X16 (Ref # 92009A)	92009-1621	1
NUT,6MM (Ref # 92015)	92015-1094	1
NUT,6MM (Ref # 92015A)	92015-1602	1
RIVET,4.8MM (Ref # 92039)	92039-3719	2
PLUG (Ref # 92066)	92066-0036	4
BAND,BATTERY (Ref # 92072)	92072-0033	1
BAND,L=188 (Ref # 92072A)	92072-1239	8
SEAL,L=408 (Ref # 92093)	92093-0024	1
SEAL,L=250 (Ref # 92093A)	92093-0028	2

2008 Brute Force 750 4x4i NRA Outdoors PARTS LIST

Frame Fittings

ITEM NAME	PART NUMBER	QUANTITY
COLLAR,L=6.5 (Ref # 92143)	92143-1025	1
COLLAR (Ref # 92143A)	92143-1057	7
COLLAR (Ref # 92143B)	92143-1087	4
COLLAR (Ref # 92152)	92152-0155	2
BOLT,FLANGED,12X35 (Ref # 92153)	92153-0847	2
DAMPER (Ref # 92160)	92160-1151	2
BOLT-FLANGED,6X16 (Ref # 130)	130BB0616	8
BOLT-FLANGED,8X12 (Ref # 130A)	130BB0812	2
BOLT-FLANGED,8X25 (Ref # 130B)	130BB0825	2
DAMPER (Ref # 92161)	92161-0048	2
DAMPER,SENSOR (Ref # 92161A)	92161-0618	1
DAMPER (Ref # 92161B)	92161-1127	4
SCREW,TAPPING,5X16 (Ref # 92172)	92172-0175	2
TUBE,CORRUGATED,L=840 (Ref # 92192)	92192-0572	1
NUT (Ref # 92210)	92210-1331	1