

2008 Brute Force® 650 4x4i PARTS DIAGRAM

Front Suspension

F2152

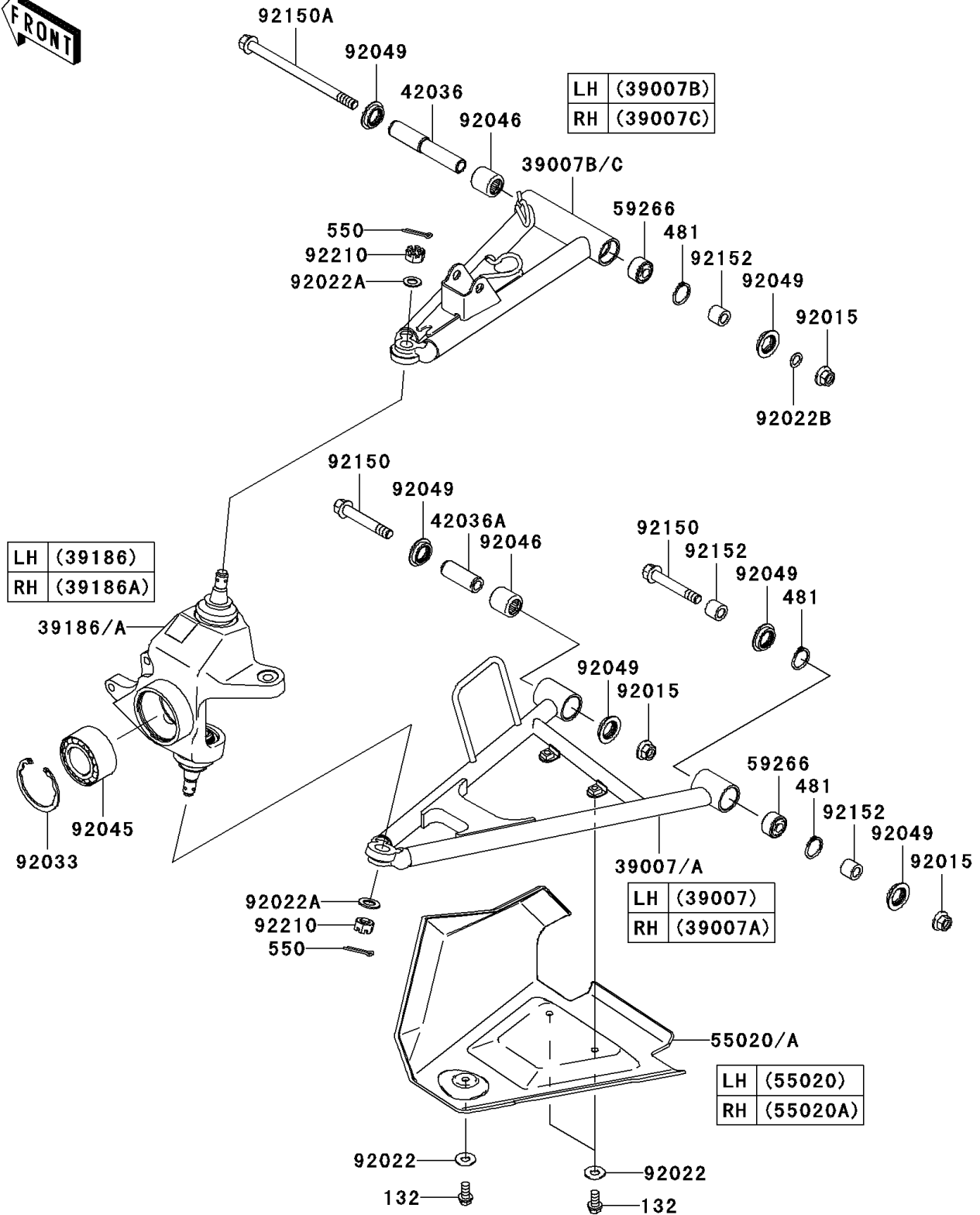

2008 Brute Force® 650 4x4i PARTS LIST

Front Suspension

| ITEM NAME | PART NUMBER | QUANTITY |
|---|---------------|----------|
| BOLT-FLANGED-SMALL,6X12 (Ref # 132) | 132J0612 | 6 |
| ARM-SUSP,FR,LWR,LH (Ref # 39007) | 39007-0064 | 1 |
| ARM-SUSP,FR,LWR,RH (Ref # 39007A) | 39007-0065 | 1 |
| ARM-SUSP,FR,UPP,LH (Ref # 39007B) | 39007-0066 | 1 |
| ARM-SUSP,FR,UPP,RH (Ref # 39007C) | 39007-0067 | 1 |
| KNUCKLE ASSY,FR,LH (Ref # 39186) | 39186-0033 | 1 |
| KNUCKLE ASSY,FR,RH (Ref # 39186A) | 39186-0034 | 1 |
| SLEEVE,SUSPENSION ARM (Ref # 42036) | 42036-0016 | 2 |
| SLEEVE (Ref # 42036A) | 42036-1376 | 2 |
| CIRCLIP (Ref # 481) | 481J2400 | 6 |
| PIN-COTTER,3.0X25 (Ref # 550) | 550D3025 | 4 |
| GUARD,FRONT ARM,LH,F.BLACK (Ref # 55020) | 55020-0109-6Z | 1 |
| GUARD,FRONT ARM,RH,F.BLACK (Ref # 55020A) | 55020-0110-6Z | 1 |
| JOINT-BALL (Ref # 59266) | 59266-0013 | 4 |
| NUT,FLANGED,10MM (Ref # 92015) | 92015-1415 | 6 |
| WASHER,7X16X1.2 (Ref # 92022) | 92022-024 | 6 |
| WASHER,12.3X22X1.6 (Ref # 92022A) | 92022-1065 | 4 |
| WASHER,10.2X16X1 (Ref # 92022B) | 92022-1829 | AR |
| RING-SNAP,55MM (Ref # 92033) | 92033-1274 | 2 |
| BEARING-BALL,30BWD08ACA13 (Ref # 92045) | 92045-0095 | 2 |
| BEARING-NEEDLE (Ref # 92046) | 92046-1046 | 4 |
| SEAL-OIL,MHA17245.7F (Ref # 92049) | 92049-1223 | 12 |
| BOLT,FLANGED,10X63 (Ref # 92150) | 92150-1384 | 4 |
| BOLT,FLANGED,10X150 (Ref # 92150A) | 92150-1686 | 2 |
| COLLAR,10X17X14.5 (Ref # 92152) | 92152-1455 | 6 |
| NUT,CASTLE,12MM (Ref # 92210) | 92210-0395 | 4 |