

# 1989 KX125 PARTS DIAGRAM

Transmission

(E1361 )

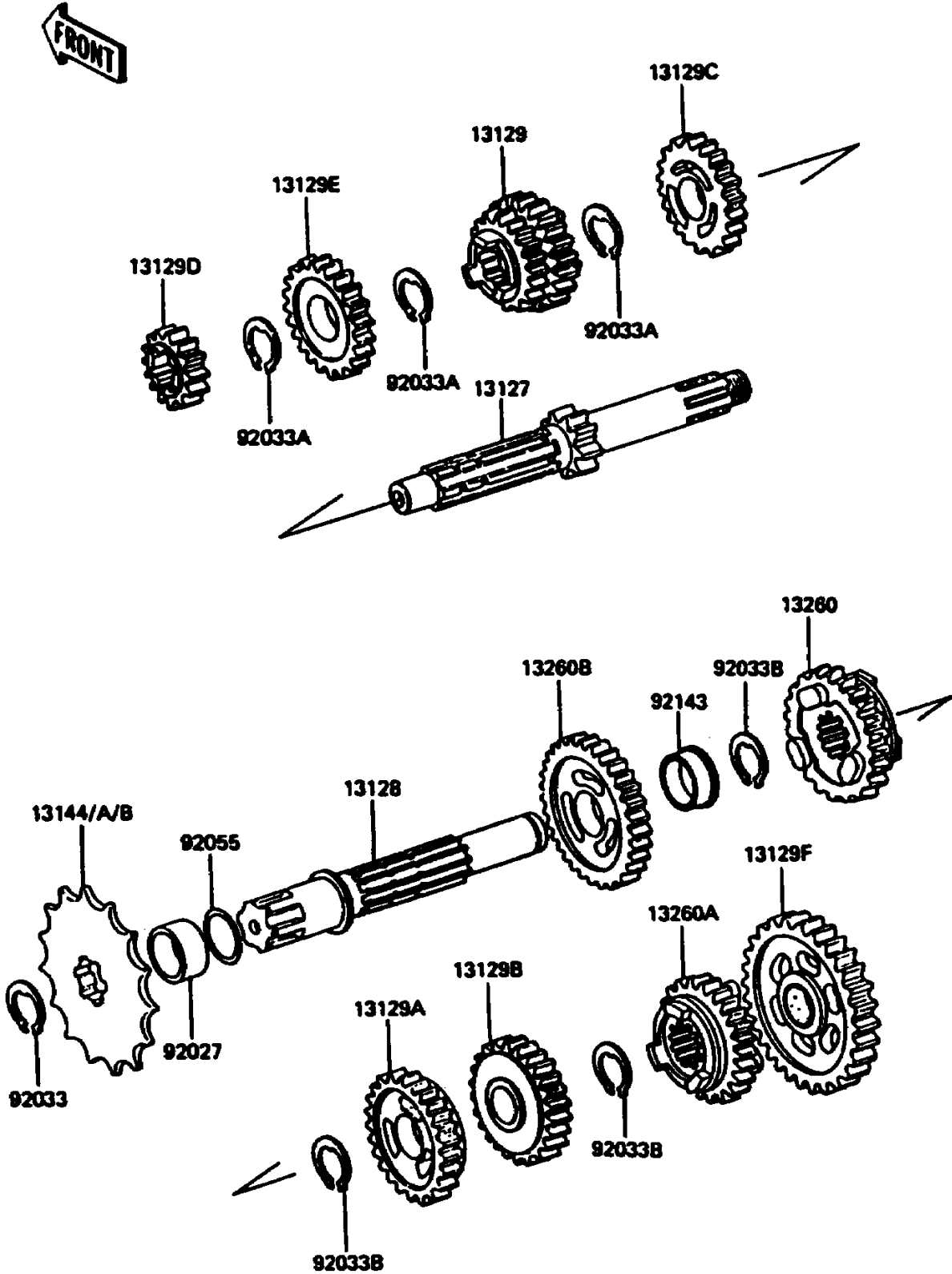

# 1989 KX125 PARTS LIST

## Transmission

ITEM NAME	PART NUMBER	QUANTITY
SHAFT-TRANSMISSION INPUT,14T (Ref # 13127)	13127-1158	1
SHAFT-TRANSMISSION OUTPUT (Ref # 13128)	13128-1163	1
GEAR,INPUT 3RD&4TH,20T&22T (Ref # 13129)	13129-1625	1
GEAR,OUTPUT 3RD,28T (Ref # 13129A)	13129-1627	1
GEAR,OUTPUT 4TH,26T (Ref # 13129B)	13129-1628	1
GEAR,INPUT TOP,25T (Ref # 13129C)	13129-1831	1
GEAR,INPUT 2ND,14T (Ref # 13129D)	13129-1900	1
GEAR,INPUT 5TH,24T (Ref # 13129E)	13129-1901	1
GEAR,OUTPUT LOW,30T (Ref # 13129F)	13129-1902	1
SPROCKET-OUTPUT,11T (Ref # 13144)	13144-1036	1
SPROCKET-OUTPUT,12T (Ref # 13144A)	13144-1049	1
SPROCKET-OUTPUT,13T (Ref # 13144B)	13144-1050	1
GEAR,OUTPUT 5TH,25T (Ref # 13260)	13129-1972	1
GEAR,OUTPUT TOP,23T (Ref # 13260A)	13129-1973	1
GEAR,OUTPUT 2ND,24T (Ref # 13260B)	13260-1032	1
COLLAR,20X25X10.8 (Ref # 92027)	92027-1445	1
RING-SNAP,18MM (Ref # 92033)	92033-1079	1
RING-SNAP,20MM (Ref # 92033A)	92033-1231	3
RING-SNAP,20MM (Ref # 92033B)	92033-1258	3
RING-O,17.5X1.5 (Ref # 92055)	92055-022	1
COLLAR (Ref # 92143)	92143-1272	1