

# 2016 MULE PRO-DXT™ EPS DIESEL PARTS DIAGRAM

## Master Cylinder

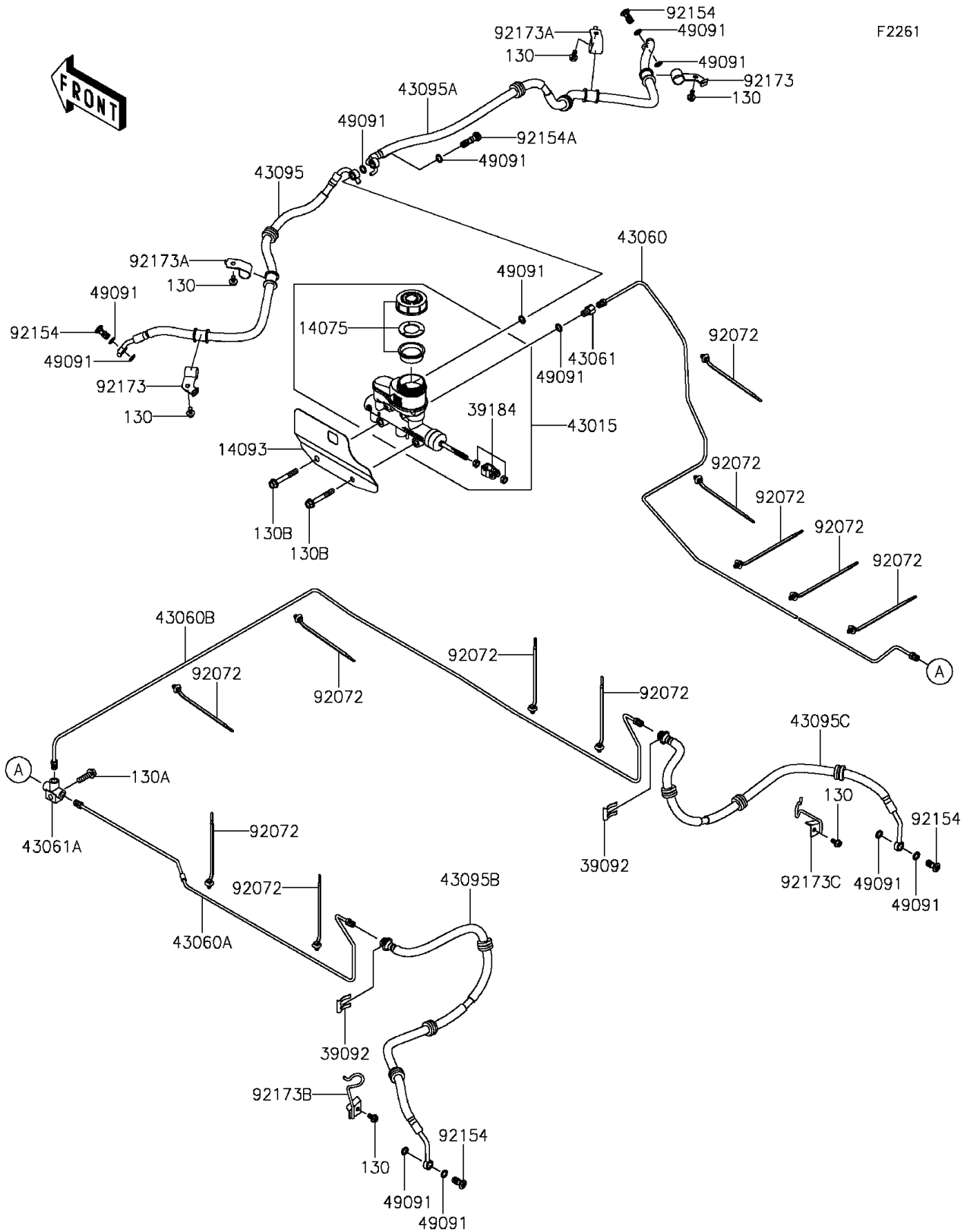

F2261

## 2016 MULE PRO-DXT™ EPS DIESEL PARTS LIST

### Master Cylinder

ITEM NAME	PART NUMBER	QUANTITY
BOLT-FLANGED,6X12 (Ref # 130)	130BA0612	6
BOLT-FLANGED,8X30 (Ref # 130A)	130BA0830	1
BOLT-FLANGED,8X55 (Ref # 130B)	130BA0855	2
CAP-ASSY (Ref # 14075)	14075-0038	1
COVER,M/C BODY (Ref # 14093)	14093-0044	1
PIN-HAIR (Ref # 39092)	39092-1052	2
BRACKET-ASSY (Ref # 39184)	39184-0031	1
CYLINDER-ASSY-MASTER (Ref # 43015)	43015-0595	1
PIPE-BRAKE (Ref # 43060)	43060-0317	1
PIPE-BRAKE,LH (Ref # 43060A)	43060-0318	1
PIPE-BRAKE,RH (Ref # 43060B)	43060-0319	1
JOINT-BRAKE,M/C (Ref # 43061)	43061-0302	1
JOINT-BRAKE (Ref # 43061A)	43061-1063	1
HOSE-BRAKE,661MM (Ref # 43095)	43095-0807	1
HOSE-BRAKE,1011MM (Ref # 43095A)	43095-0808	1
HOSE-BRAKE,847MM (Ref # 43095B)	43095-0809	1
HOSE-BRAKE,767MM (Ref # 43095C)	43095-0810	1
WASHER-SEAL,10.1X14.5X1.5 (Ref # 49091)	49091-0001	12
BAND (Ref # 92072)	92072-1414	11
BOLT,HEXALOBULAR,10X21 (Ref # 92154)	92154-1328	4
BOLT,OIL,10X34.5 (Ref # 92154A)	92154-1398	1
CLAMP (Ref # 92173)	92173-1215	2
CLAMP (Ref # 92173A)	92173-1216	2
CLAMP (Ref # 92173B)	92173-1217	1
CLAMP (Ref # 92173C)	92173-1218	1