

2017 MULE PRO-FX™ RANCH EDITION PARTS DIAGRAM

Transmission

E1361

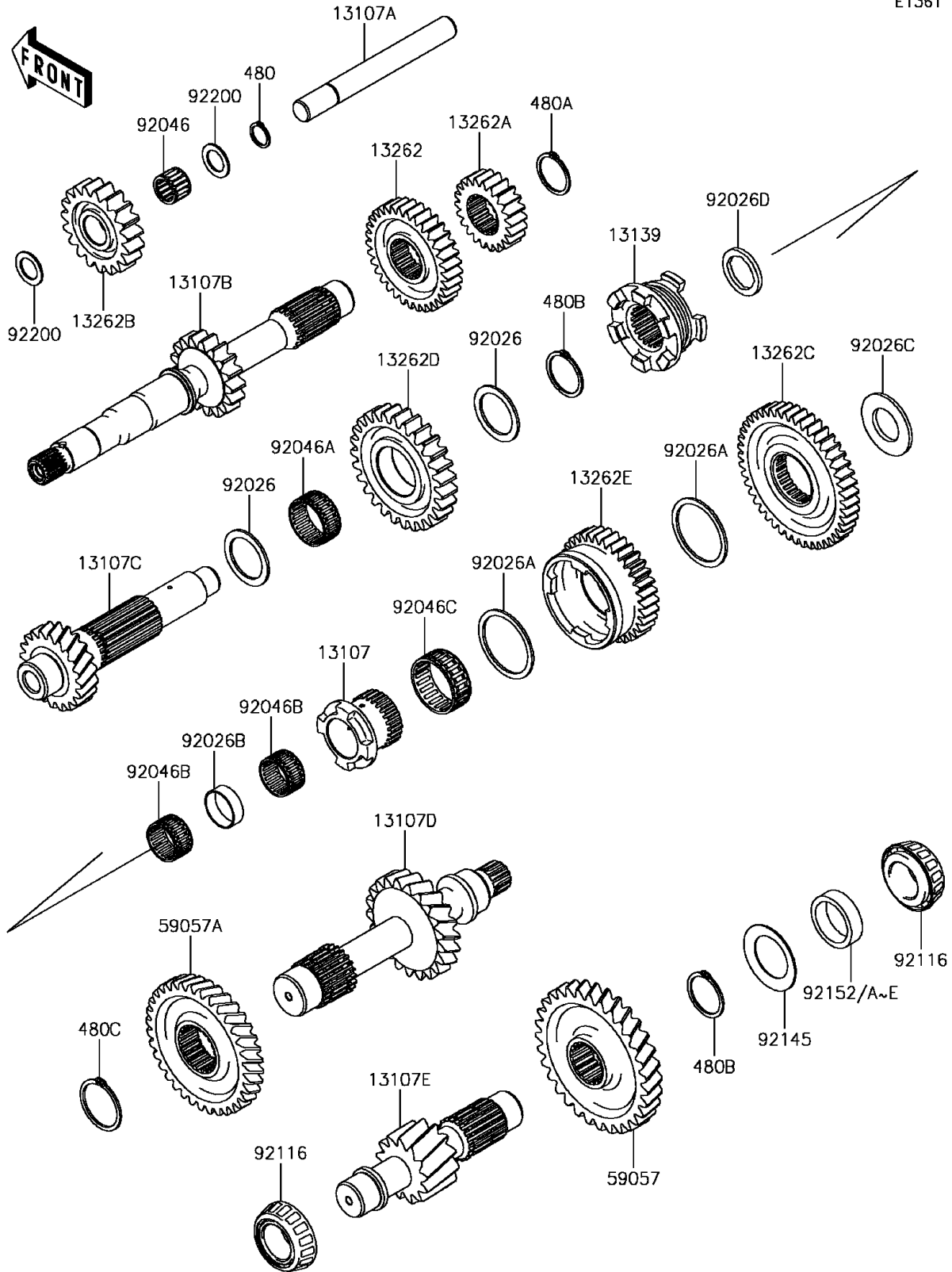

2017 MULE PRO-FX™ RANCH EDITION PARTS LIST

Transmission

ITEM NAME	PART NUMBER	QUANTITY
SHAFT (Ref # 13107)	13107-0779	1
SHAFT,IDLE REV (Ref # 13107A)	13107-0780	1
SHAFT,INPUT,17T (Ref # 13107B)	13107-0782	1
SHAFT,COUNTER,20T (Ref # 13107C)	13107-0783	1
SHAFT,3RD,21T (Ref # 13107D)	13107-0784	1
SHAFT,4TH,13T (Ref # 13107E)	13107-0785	1
SHIFTER (Ref # 13139)	13139-0022	1
GEAR,INPUT HI,33T (Ref # 13262)	13262-1085	1
GEAR,INPUT LOW,22T (Ref # 13262A)	13262-1086	1
GEAR,IDLE REV,19T (Ref # 13262B)	13262-1087	1
GEAR,COUNTER LOW,45T (Ref # 13262C)	13262-1088	1
GEAR,COUNTER REV,27T (Ref # 13262D)	13262-1089	1
GEAR,COUNTER HI,34T (Ref # 13262E)	13262-1090	1
CIRCLIP-TYPE-C,18MM (Ref # 480)	480J1800	1
CIRCLIP-TYPE-C,32MM (Ref # 480A)	480J3200	1
CIRCLIP (Ref # 480B)	480J3500	2
CIRCLIP (Ref # 480C)	480J4000	1
GEAR-HELICAL,31T (Ref # 59057)	59057-0013	1
GEAR-HELICAL,3RD,35T (Ref # 59057A)	59057-0015	1
SPACER,35.2X47X2 (Ref # 92026)	92026-0765	2
SPACER,49.2X58X2 (Ref # 92026A)	92026-0766	2
SPACER,29.4X31.8X10 (Ref # 92026B)	92026-0767	1
SPACER (Ref # 92026C)	92026-0768	1
SPACER,28.2X39X3.6 (Ref # 92026D)	92026-0795	1
BEARING-NEEDLE,FMJ-182417 (Ref # 92046)	92046-0040	1
BEARING-NEEDLE,35X40X17 (Ref # 92046A)	92046-0611	1
BEARING-NEEDLE,KT283317C3 (Ref # 92046B)	92046-0621	2
BEARING-NEEDLE,HIGH GEAR (Ref # 92046C)	92046-1276	1
BEARING-ROLLER (Ref # 92116)	92116-0007	2

2017 MULE PRO-FX™ RANCH EDITION PARTS LIST

Transmission

ITEM NAME	PART NUMBER	QUANTITY
SPRING (Ref # 92145)	92145-1575	1
COLLAR,L=12.1 (Ref # 92152)	92152-1815	AR
COLLAR,L=12.3 (Ref # 92152A)	92152-1816	AR
COLLAR,L=12.5 (Ref # 92152B)	92152-1817	AR
COLLAR,L=12.7 (Ref # 92152C)	92152-1818	AR
COLLAR,L=12.9 (Ref # 92152D)	92152-1819	AR
COLLAR,L=13.1 (Ref # 92152E)	92152-1820	AR
WASHER,18.2X28X1.5 (Ref # 92200)	92200-0716	2