

# 2020 VULCAN® 900 CLASSIC PARTS DIAGRAM

Front Fork

F2340

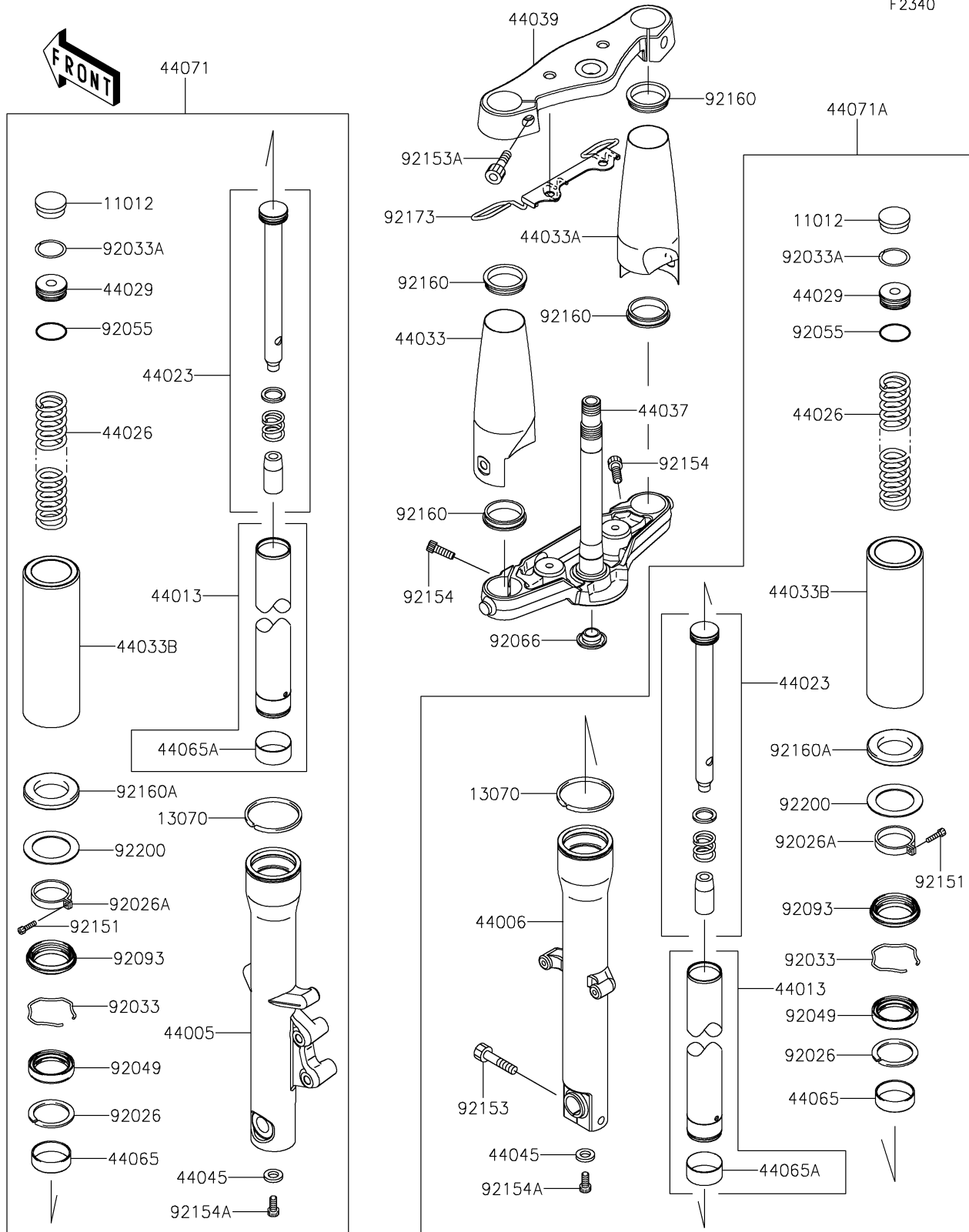

## 2020 VULCAN® 900 CLASSIC PARTS LIST

### Front Fork

ITEM NAME	PART NUMBER	QUANTITY
CAP,FORK TOP (Ref # 11012)	11012-1561	2
GUIDE (Ref # 13070)	13070-0056	2
PIPE-LEFT FORK OUTER (Ref # 44005)	44005-0105	1
PIPE-RIGHT FORK OUTER (Ref # 44006)	44006-0105	1
PIPE-FORK INNER (Ref # 44013)	44013-0257	2
CYLINDER-SET-FORK (Ref # 44023)	44023-0126	2
SPRING-FRONT FORK (Ref # 44026)	44026-0190	2
SEAT-FORK SPRING (Ref # 44029)	44029-0019	2
COVER-FORK,LH,F.S.BLACK (Ref # 44033)	44033-0069-18R	1
COVER-FORK,RH,F.S.BLACK (Ref # 44033A)	44033-0070-18R	1
COVER-FORK,F.S.BLACK (Ref # 44033B)	44033-0071-18R	2
HOLDER-FORK UNDER,F.S.BLACK (Ref # 44037)	44037-0068-18R	1
HOLDER-FORK UPPER,F.S.BLACK (Ref # 44039)	44039-0087-18R	1
GASKET,FORK CYLINDER BOLT (Ref # 44045)	44045-051	2
BUSHING-FRONT FORK (Ref # 44065)	44065-0019	2
BUSHING-FRONT FORK,INNER PIPE (Ref # 44065A)	44065-1087	2
DAMPER-ASSY,FORK,LH (Ref # 44071)	44071-1089	1
DAMPER-ASSY,FORK,RH (Ref # 44071A)	44071-1090	1
SPACER,FORK (Ref # 92026)	92026-0090	2
SPACER (Ref # 92026A)	92026-1515	2
RING-SNAP (Ref # 92033)	92033-0756	2
RING-SNAP (Ref # 92033A)	92033-0757	2
SEAL-OIL (Ref # 92049)	92049-0058	2
RING-O,SPRING SEAT (Ref # 92055)	92055-1363	2
PLUG (Ref # 92066)	92066-0078	1
SEAL,DUST (Ref # 92093)	92093-0659	2
BOLT,SOCKET,4X16 (Ref # 92151)	92151-1356	2
BOLT (Ref # 92153)	92153-0533	1
BOLT,SOCKET,8X30 (Ref # 92153A)	92153-0712	2

## 2020 VULCAN® 900 CLASSIC PARTS LIST

### Front Fork

ITEM NAME	PART NUMBER	QUANTITY
BOLT,SOCKET,10X25 (Ref # 92154)	92154-0252	2
BOLT (Ref # 92154A)	92154-1677	2
DAMPER (Ref # 92160)	92160-1892	4
DAMPER (Ref # 92160A)	92160-1927	2
CLAMP (Ref # 92173)	92173-0165	1
WASHER (Ref # 92200)	92200-1417	2