

2021 Z H2 PARTS DIAGRAM

Cowling

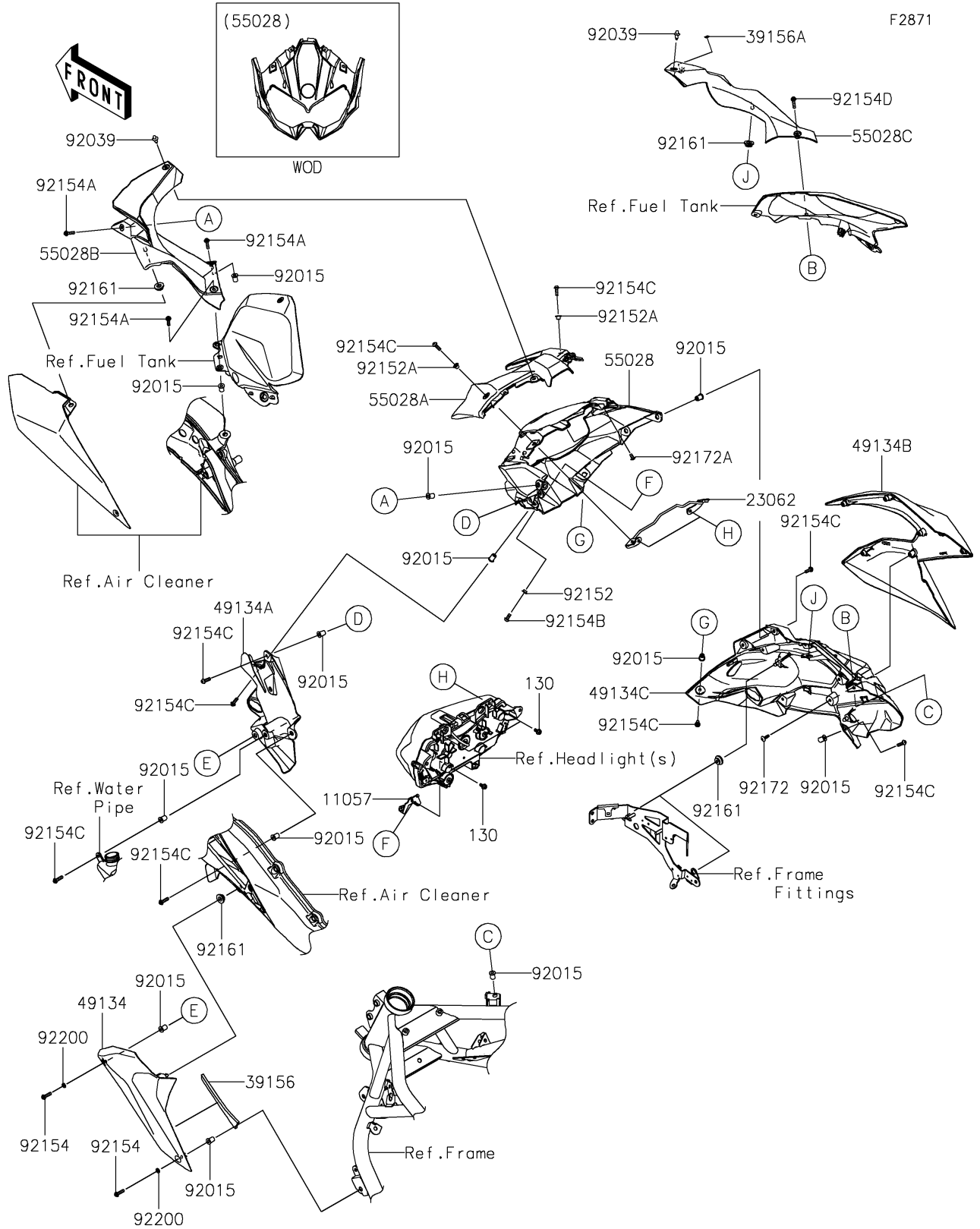

F2871

2021 Z H2 PARTS LIST

Cowling

ITEM NAME	PART NUMBER	QUANTITY
BRACKET,UPP COWL.,LWR (Ref # 11057)	11057-2914	1
BRACKET-COMP,UPP COWL.,UPP (Ref # 23062)	23062-1265	1
PAD (Ref # 39156)	39156-2596	1
PAD,14.5X6.8X1 (Ref # 39156A)	39156-2668	1
SHROUD,OUTER,LH,M.F.S.BLACK (Ref # 49134)	49134-0012-739	1
SHROUD,LH (Ref # 49134A)	49134-0013	1
SHROUD,OUTER,RH,M.F.S.BLACK (Ref # 49134B)	49134-0014-739	1
SHROUD,RH (Ref # 49134C)	49134-0015	1
COWLING,UPP,M.F.S.BLACK (Ref # 55028)	55028-0744-739	1
COWLING,UPP COVER (Ref # 55028A)	55028-0745	1
COWLING,INNER,LH (Ref # 55028B)	55028-0746	1
COWLING,INNER,RH (Ref # 55028C)	55028-0799	1
NUT,WELL,5MM (Ref # 92015)	92015-1757	14
RIVET (Ref # 92039)	92039-0068	2
COLLAR (Ref # 92152)	92152-0451	2
COLLAR (Ref # 92152A)	92152-2660	2
BOLT,SOCKET,5X20 (Ref # 92154)	92154-0210	2
BOLT,SOCKET,5X20 (Ref # 92154A)	92154-0919	3
BOLT,SOCKET,5X12 (Ref # 92154B)	92154-1421	2
BOLT,SOCKET,5X16 (Ref # 92154C)	92154-1701	10
BOLT,SOCKET,5X23 (Ref # 92154D)	92154-3820	1
DAMPER (Ref # 92161)	92161-1531	5
SCREW,TAPPING,5X16 (Ref # 92172)	92172-0238	8
SCREW,TAPPING,5X10 (Ref # 92172A)	92172-0262	2
WASHER,5.2X10X1.0 (Ref # 92200)	92200-1820	2
BOLT-FLANGED,5X10 (Ref # 130)	130BA0510	3