

2005 KX250 PARTS DIAGRAM

Crankcase

E1411

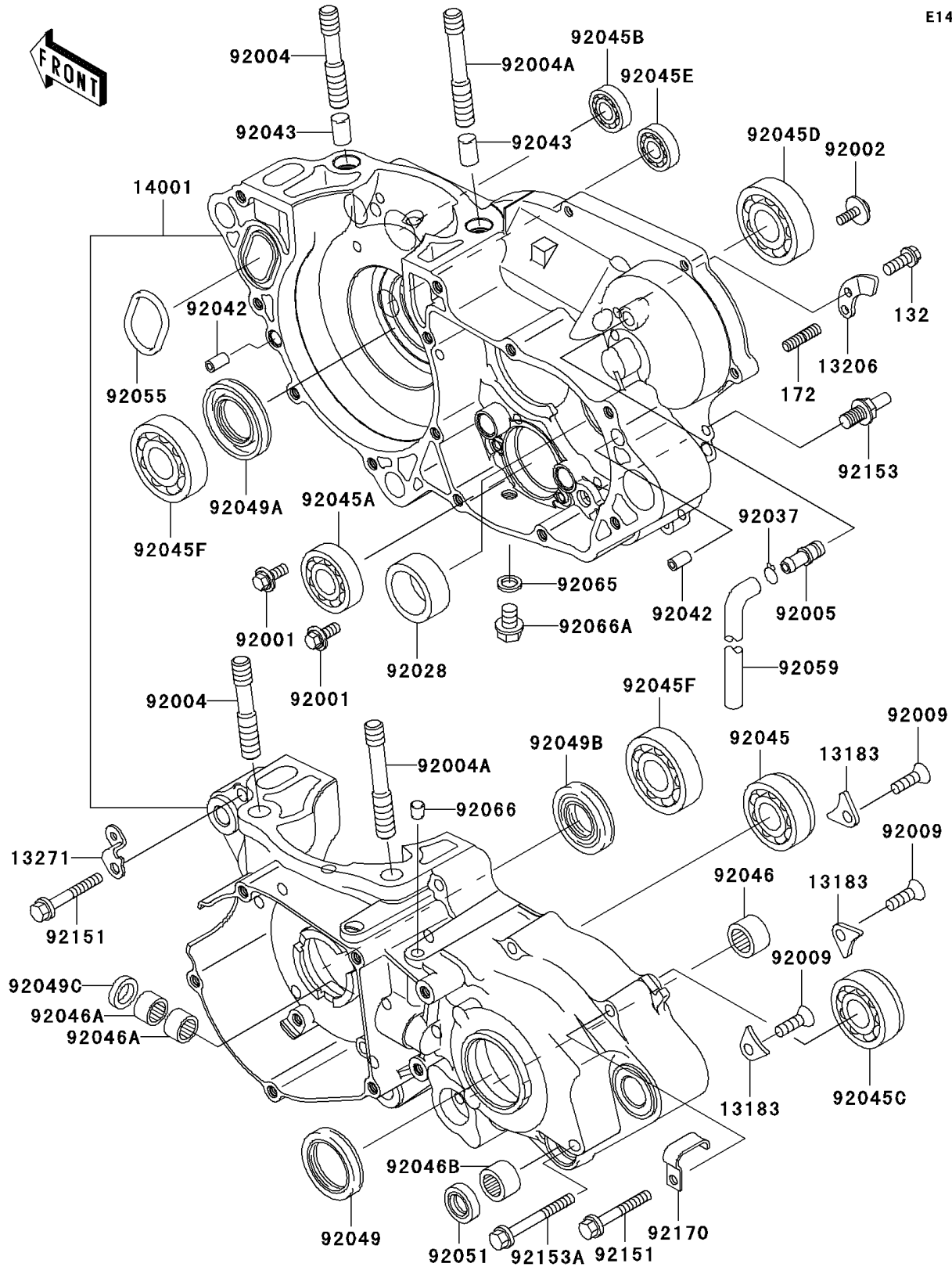

2005 KX250 PARTS LIST

Crankcase

| ITEM NAME | PART NUMBER | QUANTITY |
|--|-------------|----------|
| PLATE (Ref # 13183) | 13183-1182 | 3 |
| GUIDE-KICK (Ref # 13206) | 13206-1062 | 1 |
| PLATE (Ref # 13271) | 13271-0532 | 1 |
| SET-CRANKCASE (Ref # 14001) | 14001-0021 | 1 |
| BOLT,W/WASHER,6X14 (Ref # 92001) | 92001-1829 | 2 |
| BOLT,6X16 (Ref # 92002) | 92002-1659 | 1 |
| STUD,10X64 (Ref # 92004) | 92004-0018 | 2 |
| STUD,10X74.5 (Ref # 92004A) | 92004-0021 | 2 |
| FITTING,BREATHER (Ref # 92005) | 92005-1210 | 1 |
| SCREW,6X10 (Ref # 92009) | 92009-1563 | 3 |
| BUSHING,26X35X14 (Ref # 92028) | 92028-131 | 1 |
| CLAMP (Ref # 92037) | 92037-1610 | 1 |
| PIN,DOWEL,6.3X8X14 (Ref # 92042) | 92042-007 | 2 |
| PIN,11X14X12.3 (Ref # 92043) | 92043-1266 | 2 |
| BEARING-BALL,3TM-SX0391ZC3 (Ref # 92045) | 92045-0013 | 1 |
| BEARING-BALL,6905Z (Ref # 92045A) | 92045-1058 | 1 |
| BEARING-BALL,#628 (Ref # 92045B) | 92045-1123 | 1 |
| BEARING-BALL,TMB205/56W-5 (Ref # 92045C) | 92045-1240 | 1 |
| BEARING-BALL,63/22/25X7 (Ref # 92045D) | 92045-1300 | 1 |
| BEARING-BALL,626BUMC3 (Ref # 92045E) | 92045-1345 | 1 |
| BEARING-BALL,CRANK MAIN (Ref # 92045F) | 92045-1445 | 2 |
| BEARING-NEEDLE,7E-HK1412 (Ref # 92046) | 92046-037 | 1 |
| BEARING-NEEDLE,HK1210 (Ref # 92046A) | 92046-1010 | 2 |
| BEARING-NEEDLE,HK1312 (Ref # 92046B) | 92046-1148 | 1 |
| SEAL-OIL,TC 30 40 7 (Ref # 92049) | 92049-0030 | 1 |
| SEAL-OIL,TCJ 25 45 7 (Ref # 92049A) | 92049-0031 | 1 |
| SEAL-OIL,TCJ 20 40 7 (Ref # 92049B) | 92049-0032 | 1 |
| SEAL-OIL,AG0353-F0 (Ref # 92049C) | 92049-1262 | 1 |
| SEAL-OIL,TB13225.5 (Ref # 92051) | 92051-005 | 1 |

2005 KX250 PARTS LIST

Crankcase

| ITEM NAME | PART NUMBER | QUANTITY |
|---------------------------------------|-------------|----------|
| RING-O,YP 26.7 41.8 2.7 (Ref # 92055) | 92055-0059 | 1 |
| TUBE,6X9X360 (Ref # 92059) | 92059-103 | 1 |
| GASKET,10.5X16X1 (Ref # 92065) | 92065-058 | 1 |
| PLUG,OIL LINE,7.2X8 (Ref # 92066) | 92066-1012 | 1 |
| PLUG,DRAIN (Ref # 92066A) | 92066-1437 | 1 |
| BOLT,6X45 (Ref # 92151) | 92151-1336 | 11 |
| BOLT,RETURN (Ref # 92153) | 92153-0629 | 1 |
| BOLT,6X75 (Ref # 92153A) | 92153-0862 | 1 |
| CLAMP (Ref # 92170) | 92170-1555 | 1 |
| BOLT-FLANGED-SMALL (Ref # 132) | 132G0616 | 1 |
| BOLT-STUD,6X12 (Ref # 172) | 172G0612 | 1 |