

2018 Z900RS PARTS DIAGRAM

Transmission

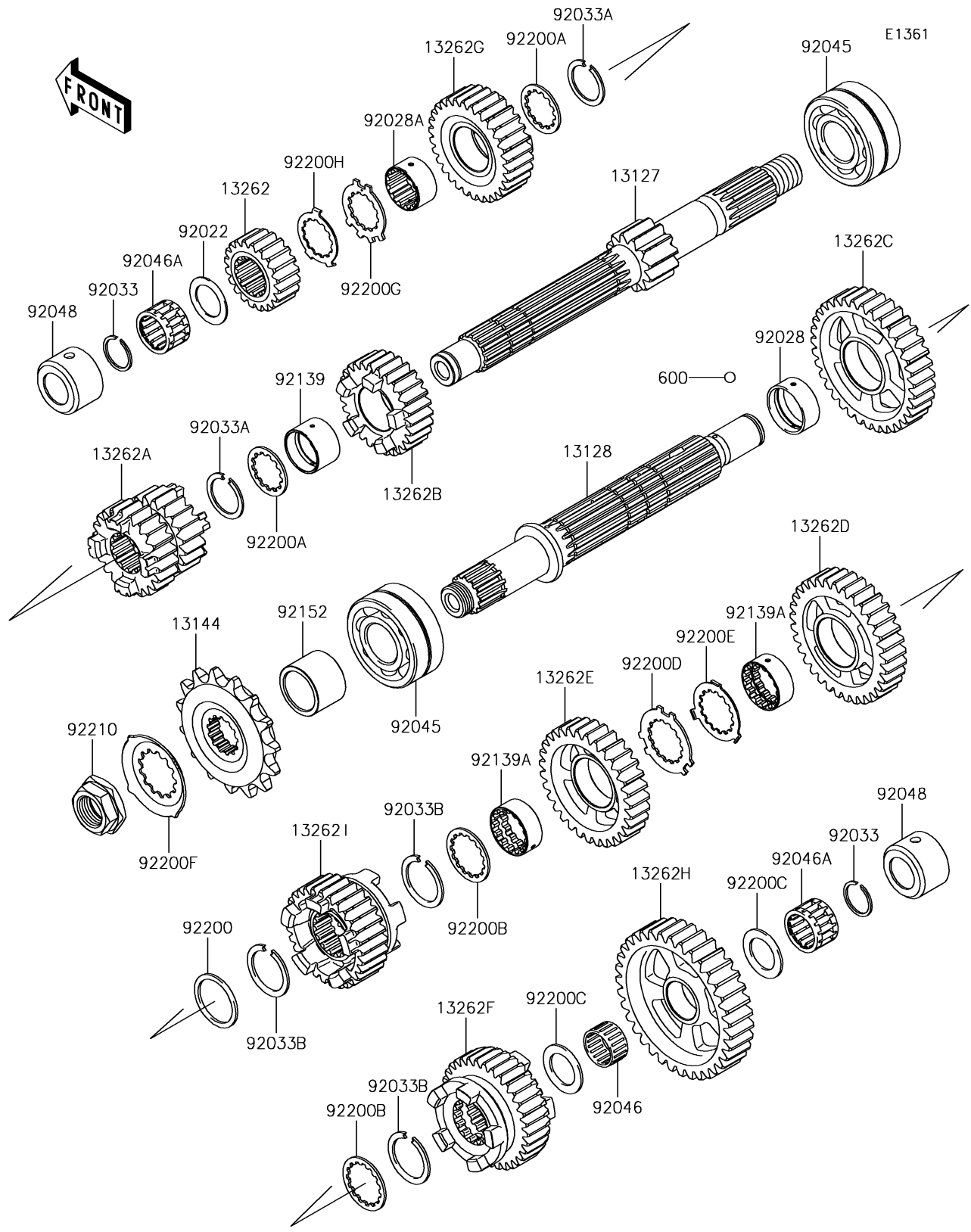

2018 Z900RS PARTS LIST

Transmission

| ITEM NAME | PART NUMBER | QUANTITY |
|--|-------------|----------|
| SHAFT-TRANSMISSION INPUT,12T (Ref # 13127) | 13127-0694 | 1 |
| SHAFT-TRANSMISSION OUTPUT (Ref # 13128) | 13128-0698 | 1 |
| SPROCKET-OUTPUT,15T (Ref # 13144) | 13144-0579 | 1 |
| GEAR,INPUT 2ND,17T (Ref # 13262) | 13262-1233 | 1 |
| GEAR,INPUT 3RD&4TH,20T&22T (Ref # 13262A) | 13262-1234 | 1 |
| GEAR,INPUT 5TH,27T (Ref # 13262B) | 13262-1235 | 1 |
| GEAR,OUTPUT 2ND,35T (Ref # 13262C) | 13262-1238 | 1 |
| GEAR,OUTPUT 3RD,33T (Ref # 13262D) | 13262-1239 | 1 |
| GEAR,OUTPUT 4TH,31T (Ref # 13262E) | 13262-1240 | 1 |
| GEAR,OUTPUT 5TH,33T (Ref # 13262F) | 13262-1241 | 1 |
| GEAR,INPUT 6TH,30T (Ref # 13262G) | 13262-1285 | 1 |
| GEAR,OUTPUT LOW,35T (Ref # 13262H) | 13262-1286 | 1 |
| GEAR,OUTPUT 6TH,29T (Ref # 13262I) | 13262-1287 | 1 |
| WASHER,20.5X30X1,STEEL (Ref # 92022) | 92022-112 | 1 |
| BUSHING,OUTPUT,2ND (Ref # 92028) | 92028-1739 | 1 |
| BUSHING,INPUT TOP GEAR (Ref # 92028A) | 92028-1915 | 1 |
| RING-SNAP,20MM (Ref # 92033) | 92033-015 | 2 |
| RING-SNAP,24MM (Ref # 92033A) | 92033-026 | 2 |
| RING-SNAP,T=1.5 (Ref # 92033B) | 92033-1249 | 3 |
| BEARING-BALL,DAC2557NSSH (Ref # 92045) | 92045-0003 | 2 |
| BEARING-NEEDLE,K20X24X13 (Ref # 92046) | 92046-1219 | 1 |
| BEARING-NEEDLE,PK20X27X17X3 (Ref # 92046A) | 92046-1303 | 2 |
| RACE (Ref # 92048) | 92048-0016 | 2 |
| BUSHING,25X28X17.8 (Ref # 92139) | 92139-0280 | 1 |
| BUSHING,OUTPUT,3RD&4TH (Ref # 92139A) | 92139-0281 | 2 |
| COLLAR,SPROCKET (Ref # 92152) | 92152-2263 | 1 |
| WASHER,28.1X34.0X1.6 (Ref # 92200) | 92200-0228 | 1 |
| WASHER,25.2X31.0X1.5 (Ref # 92200A) | 92200-1239 | 2 |
| WASHER,28.5X34.0X1.5 (Ref # 92200B) | 92200-1240 | 2 |

2018 Z900RS PARTS LIST

Transmission

| ITEM NAME | PART NUMBER | QUANTITY |
|-------------------------------------|-------------|----------|
| WASHER,20.5X31X1.5 (Ref # 92200C) | 92200-1375 | 2 |
| WASHER,25.8X40.5X1.5 (Ref # 92200D) | 92200-1522 | 1 |
| WASHER,25.2X37.0X1.0 (Ref # 92200E) | 92200-1523 | 1 |
| WASHER (Ref # 92200F) | 92200-1720 | 1 |
| WASHER,22.6X34.2X1.5 (Ref # 92200G) | 92200-1941 | 1 |
| WASHER,22X32X1 (Ref # 92200H) | 92200-1942 | 1 |
| NUT,20MM (Ref # 92210) | 92210-0850 | 1 |
| BALL-STEEL,5/32 (Ref # 600) | 600A0500 | 3 |